

# GENERAL RECOMMENDATIONS

- G1** Prepare Park Furniture Guidelines comprising a selection of consistent seats, bins, picnic tables, bbq's, park lighting, drink fountains, bike rails and fencing to be used across all parks within the City of Maroondah. Guidelines to be developed for Bushland Parks and Urban Parks.  
  
Progressively phase out existing/old furniture and replace with new.
- G2** Place seats and other furniture at regular intervals along major pedestrian routes and at destination points such as playgrounds, picnic areas and sports grounds.
- G3** Prepare an Arboricultural assessment of high risk trees to assess their health, potential risk to humans and property and general life expectancy.  
  
Implement program to replace and improve tree stock.
- G4** Stagger the removal of weed tree species over a number of years. Aim to replace trees with indigenous species in bushland areas and non-invasive indigenous/native or exotic species in non-bushland areas.
- G5** Provide a consistent style of fencing along park boundaries to reduce the number of entry points for vehicles. Provide openings in fence for pedestrians, mobility aid users and cyclists at regular intervals.
- G6** Prepare a style manual for consistent and uniform signage within the Parklands and City. Provide signage relating to the following:
  - Dog etiquette in parklands.
  - Shared path etiquette.
  - Directional signage relating to the location of schools, shops, sports clubs and other community facilities.
  - Interpretation of natural environment and cultural heritage.
- G7** Maintain the Parklands as a 'dogs under effective control area' due to large numbers of adults and children using the park (Current Local Law).  
  
Identify certain areas as "No Dogs" eg. Playgrounds, BBQ's, fenced sports fields and during special events eg. Festivals.  
  
Investigate opportunities for a specific area in Eastfield Park for dog exercise.
- G8** Provide park lighting to major pedestrian routes such as the asphalt shared use paths that link community facilities and residential areas. Consider solar powered lights if feasible.
- G9** Upgrade existing narrow shared use paths in Eastfield Park.  
  
Construct new shared use paths in Town Park.  
  
Modify existing asphalt paths to shared use status in Croydon Park, widen and reseal.
- G10** Enforce Local Laws as required eg. Alcohol control
- G11** Undertake marketing exercise and possibly create a new slogan and/or new logo for the Croydon Parklands.
- G12** Commission and promote public art Installations in appropriate locations.  
  
Promote and maintain JA Turner Artist Trail.

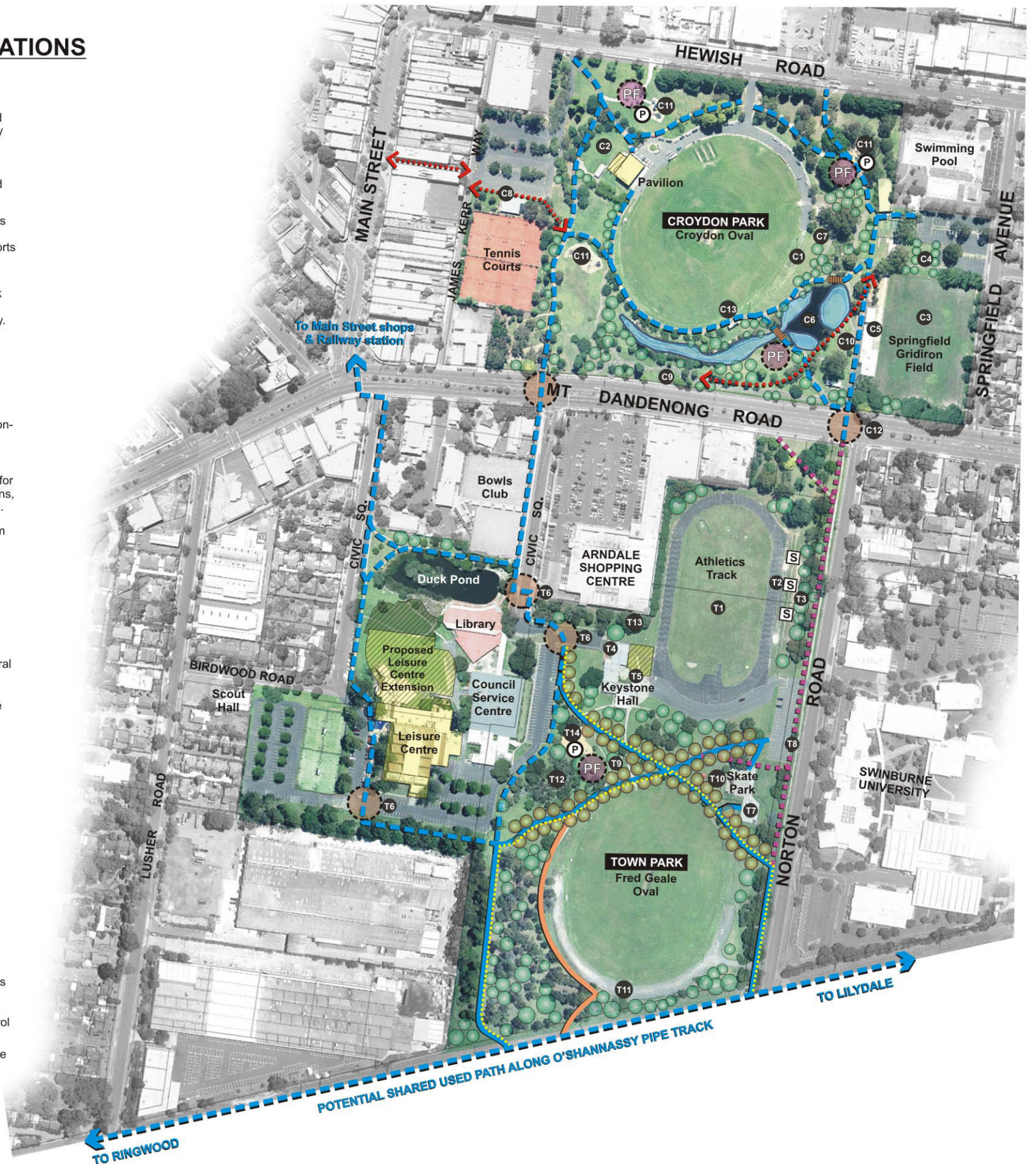

# FUTURE DIRECTIONS

CROYDON PARK		TOWN PARK	
<b>C1</b> Consider future upgrade works to hard standing area on the east side of Croydon Oval to improve parking and access, if demand increases.	<b>C7</b> Consider removing the container shed from site and find alternative home for materials stored in the shed.	<b>T1</b> Consider upgrading the training lights on the athletics track.  Irrigation and drainage in the centre of the athletics track is not a high priority under the Sportsground	Design any new building work to enclose the area behind Keystone Hall to create a courtyard space. Install lighting in the athletics car park.
<b>C2</b> Lower the embankment at the rear of the pavilion to improve safety. Public toilet block and adjacent picnic facilities have been removed. A new public toilet has been incorporated into the new pavilion extension.	<b>C8</b> Review car park configuration and provide better pedestrian / cyclist access to Main Street from Croydon Park. This may require a review / rationalisation of the pathway system in Croydon Park and carpark.	<b>T2</b> Install shade structures adjacent to the athletics track.	<b>T6</b> Provide sealed shared use paths.  Provide traffic management at locations where the shared path crosses Civic Square.
<b>C3</b> Upgrade drainage and irrigation of Springfield Gridiron Field if sustainable water supply is available.  Council to consider a new site for the Maroondah Festival because the installation of drainage and irrigation at the Springfield Gridiron Field will remove the option of driving heavy equipment onto this ground.	<b>C9</b> Remove stone edging from all paths and replace with a light coloured concrete edge.	<b>T3</b> Remove senescent trees and undertake replacement tree planting.	<b>T7</b> Re-design and replace the existing skate park with a new contemporary facility. Consider a new location within the parklands.  Provide better access from Norton Road and existing paths within the park.  Provide sufficient and robust park furniture and shelter for skaters and visitors including regulatory signage with regard to skate park etiquette.
<b>C4</b> Consider installing security lighting between the gridiron pavilion and the car park.	<b>C10</b> Remove redundant paths and replace with more direct paths catering for observed movement patterns.	<b>T4</b> Remove the existing public toilet block situated on the north side of Keystone Hall. Replacement toilets see T5.	<b>T8</b> Provide a sealed path to Mt Dandenong Road in conjunction with signalised crossing. New bike lane to be installed along Norton Road in 2007.
<b>C5</b> Review the design of the gridiron pavilion to improve the change facilities for players. Assess the building for presence of asbestos.	<b>C11</b> Investigate rationalising the number of playgrounds within the park and consider replacing a playground with an informal hardcourt area/youth activities area. Improve passive surveillance.	<b>T5</b> Consider upgrading the existing Keystone Hall subject to detailed feasibility study to provide:  • New accessible public toilets, (Toilets to be visible from the athletics track). • Renovate the existing change facilities for the Croydon Little Athletics Centre, the Victorian Masters Athletics Club, the Croydon City Arrows Junior Soccer Club, the EFL Umpires Association, and the clubs allocated use of Fred Geale Oval. • Extend the administration area currently used by the Croydon Little Athletics Centre and the Croydon City Arrows Junior Soccer Club. • Relocate the existing kiosk and increase its size. • Redevelop the office area previously allocated to the Eastern Football League to accommodate offices for Sports Clubs and compatible community groups. Work to include redeveloping the vacant storage area as additional office space or classroom. • Provide a covered verandah for spectators on the eastern side of the main building. • Design any new building work to enclose the area behind Keystone Hall to create a courtyard space.	<b>T9</b> Rationalise the amount of gravel paths/tracks widen and seal if needed.
<b>C6</b> Remove algae and weeds from the water course and main ponds.  Revegetation along the drainage course should comprise indigenous/ native species.  Conduct a maintenance service to the main pump unit used to reticulate water through the drainage course to the pond. Investigate to replace the electric pump with a solar powered water pump and have water reticulating permanently.  Conduct a hydrological investigation to assess the use of pond water to irrigate the adjoining sports oval.	<b>C12</b> Investigate the possibility of signalised pedestrian crossing at the Norton/Mt Dandenong Road intersection. Discussions to be entered into with VicRoads.	<b>T10</b> Relocate shade shelter to <b>T9</b> near T9.	<b>T10</b> Relocate shade shelter to <b>T9</b> near T9.
	<b>C13</b> Need to develop and consider holistic strategies to prevent loitering and undesirable activity from occurring under the scoreboard and other structures.  Consider cladding the underside of the scoreboard in the short term.		<b>T11</b> Seal and line mark the car park to make parking more efficient.
			<b>T12</b> Remove existing BBQ/Picnic facilities and relocate to <b>T9</b> near T9.
			<b>T13</b> Remove mound to south of Arndale Shopping Centre to improve surveillance.
			<b>T14</b> Playground to be upgraded in conjunction with relocated picnic facilities.