

NOTES:

1. EXPANSION JOINTS (E.J) TO HAVE FOUR (4) N12 TIE BARS INSTALLED AT 300 max CENTRES COMMENCING 150mm FROM EDGE AT EACH EXPANSION JOINT
2. EXPANSION JOINTS (E.J) AT MAXIMUM 18m CENTRES AND AT THE START AND END OF NEWLY CONSTRUCTED FOOTPATH SECTIONS
3. EXPANSION MATERIAL TO BE POLYETHYLENE EXPANSION FOAM, RESIN BASED CORK STRIP OR APPROVED EQUIVALENT
4. WEAKENED PLANE JOINTS (W.P.J) IN CONCRETE FOOTPATH TO BE INSTALLED AT 1.5m INTERVALS AND MADE WITH A 'T' IRON AT TIME OF CONSTRUCTION
5. CONCRETE FOOTPATH TO HAVE STIPPLE FINISH WITH NO HIGHLIGHTS
6. WHERE CROSSINGS ARE CONSTRUCTED, ADJACENT FOOTPATH PANELS MUST BE THICKENED IN ACCORDANCE WITH THE APPROPRIATE VEHICLE CROSSING STANDARD (SEE SD-H SERIES)
7. FORM WORK TIMBER TO BE MINIMUM 90mm DEEP
8. ASPHALT FOOTPATHS TO BE INSTALLED ON UNCONSTRUCTED ROADS OR ROADS WHERE THERE IS NO CONSTRUCTED KERB AND CHANNEL PRESENT

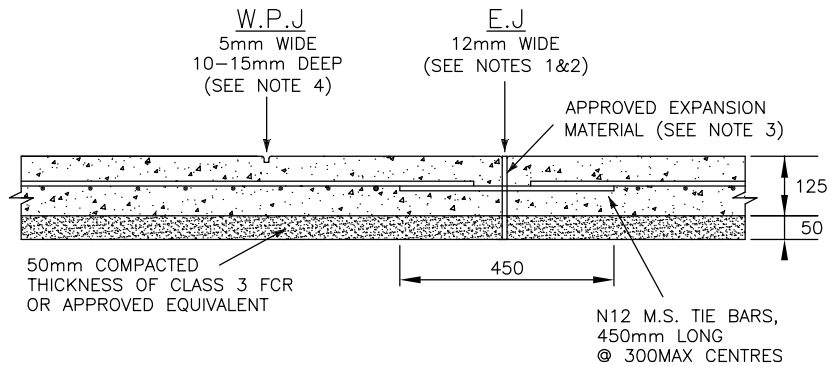

**STANDARD CONCRETE FOOTPATH
JOINT DETAILS**

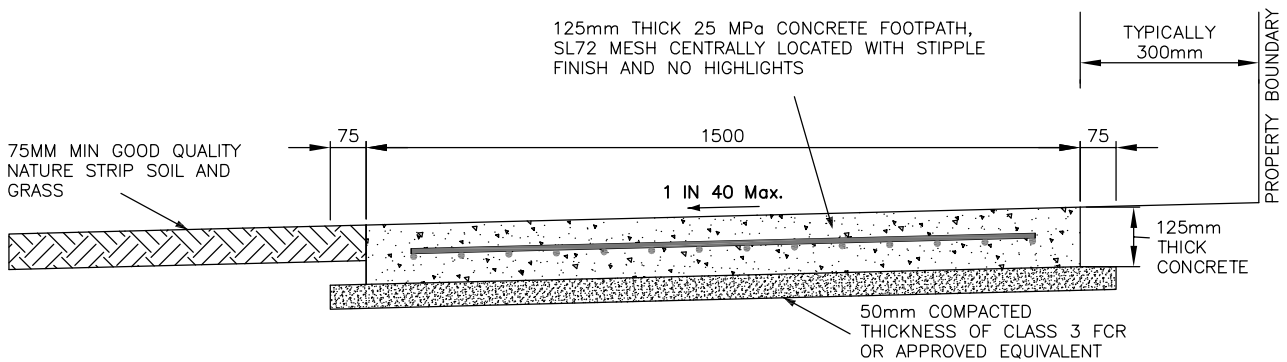

TYPICAL CROSS SECTION OF CONCRETE FOOTPATH

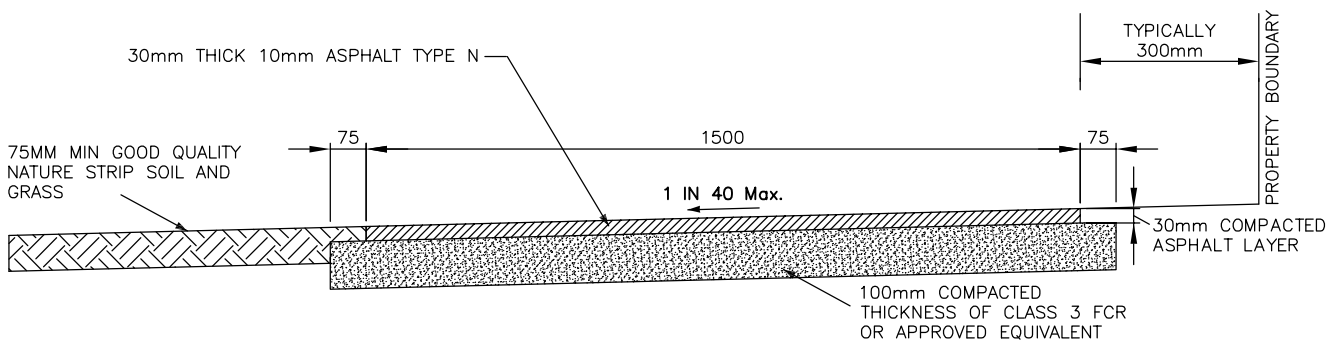

TYPICAL CROSS SECTION OF ASPHALT FOOTPATH



TITLE: **STANDARD FOOTPATH
DETAILS IN ROAD
RESERVE**

DATE: JANUARY 2013
DRAWING No.:
SD-F01