

NOTES:

1. DIMENSIONS IN MILLIMETRES UNLESS OTHERWISE INDICATED.
2. STANDARD TO BE USED WHERE AN EXISTING DRAINAGE PIT EXISTS BEHIND BACK OF KERB, AND IS TO BE MODIFIED TO IMPROVE INLET CAPACITY.
3. REFER TO SHEET 2 FOR ADDITIONAL PIT CONSTRUCTION NOTES.

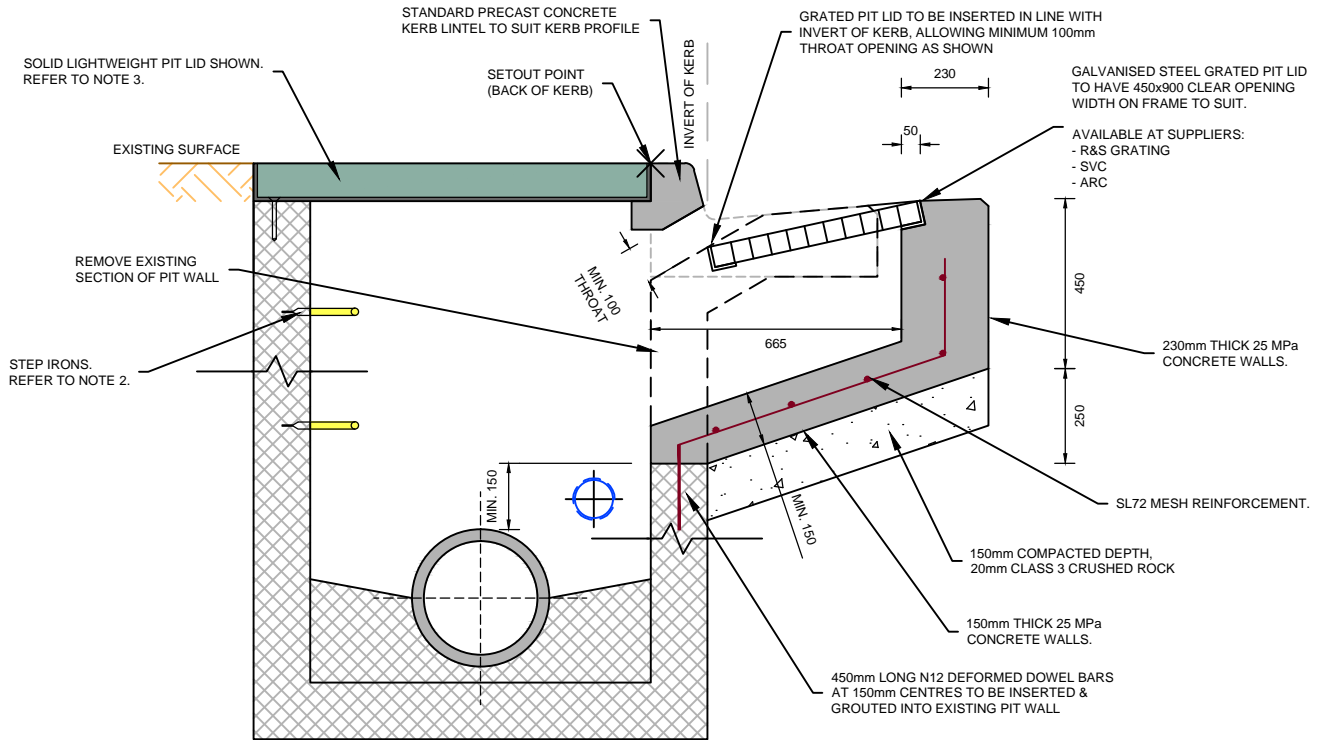

SECTION B-B

1:20 SCALE @ A4

NOTES:

1. DIMENSIONS IN MILLIMETRES UNLESS OTHERWISE INDICATED.
2. WHERE PIT DEPTH EXCEEDS 1000mm, STEP IRONS ARE TO BE INSTALLED IN ACCORDANCE WITH MAROONDAH CITY COUNCIL STANDARD DRAWING MCC-202.
3. SOLID LIGHTWEIGHT PIT LID IS TO BE MINIMUM CLASS B & LOCKABLE IN ACCORDANCE WITH AUSTRALIAN STANDARDS AS 3996:2019, INSTALLED IN ACCORDANCE WITH MANUFACTURER'S SPECIFICATIONS.
4. GRATED PIT LID IS TO BE MINIMUM CLASS D, HEAVY DUTY & BICYCLE SAFE, IN ACCORDANCE WITH AUSTRALIAN STANDARDS AS 3996:2019, INSTALLED IN ACCORDANCE WITH MANUFACTURER'S SPECIFICATIONS.
5. CLASS 3 CRUSHED ROCK MAY CONTAIN 100% CRUSHED CONCRETE IN ACCORDANCE WITH VICROADS TECHNICAL NOTE TN 107 - USE OF RECYCLED MATERIALS IN ROAD PAVEMENTS.



Engineering & Building Services
Ph: (03) 9298 4292
www.maroondah.vic.gov.au

Title:

DRAINAGE - EXISTING SIDE ENTRY PIT - CONVERSION TO GRATED SIDE ENTRY PIT

Revision: 01

Date: December 2020

Sheet: 2 of 2

Standard Drawing Number:

MCC-205