

AINSLIE PARK, CROYDON CAR PARK UPGRADE

GENERAL NOTES

- ALL LEVELS AND COORDINATES ARE TO A.H.D. AND MGA.
- THE CONTRACTOR SHALL SETOUT THE WORKS FROM THE NOMINATED REFERENCE LINES, SURVEY MARKS AND CONTROL POINTS SHOWN ON THE PLANS AND TO THE SPECIFIED DETAILS.
- THE CONTRACTOR SHALL MAINTAIN AND PROTECT THE SURVEY MARKS FOR THE DURATION OF THE CONTRACT.
- THE EDGES OF EXCAVATIONS IN BITUMINOUS AND/OR CONCRETE PAVEMENT ARE TO BE SAW CUT TO SUFFICIENT DEPTH (MINIMUM 200mm) TO PREVENT ANY OVERBREAK, LIFTING OR DAMAGE TO THE ADJACENT PAVEMENT.
- ALL EXISTING REDUNDANT CONCRETE, PAVEMENT, SOIL, RUBBISH AND CONSTRUCTION DEBRIS SHALL BE TAKEN UP AND REMOVED FROM SITE.
- PRIOR TO COMPLETION THE CONTRACTOR SHALL ENSURE THE SITE IS TIDIED AND OBTAIN A CLEARANCE FROM THE SUPERINTENDENT.
- ALL EXISTING TREES WITHIN THE WORKS AREA SHALL BE PROTECTED AT ALL TIMES UNLESS OTHERWISE STATED OR DIRECTED BY COUNCIL'S SUPERINTENDENT.
- TRAFFIC MANAGEMENT SHALL BE ARRANGED BY THE CONTRACTOR FOR THE DURATION OF THE WORKS IN ACCORDANCE WITH THE SPECIFICATION AND TO THE SATISFACTION OF THE SUPERINTENDENT, INCLUDING THE PROVISION OF ALL NECESSARY SIGNAGE, LIGHTING AND BARRICADING. TRAFFIC FLOWS IN ALL ABUTTING ROADWAYS AND PROPERTY ACCESS SHALL REMAIN UNIMPEDED FOR THE DURATION OF THE WORKS. ALL TRAFFIC MANAGEMENT WORKS TO BE IN ACCORDANCE WITH AS1742.3 AND THE CODE OF PRACTICE FOR THE ROAD MANAGEMENT ACT 2004.
- ALL DISTURBED AREAS WITHIN THE WORKS LIMIT SHALL BE TOPSOILED (MIN. 100mm DEPTH), CULTIVATED, FERTILISED AND SEEDED WITH AN APPROVED GRASS SEED MIXTURE.
- ALL DEPTHS OF ASPHALT & CRUSHED ROCK FOR NEW PAVEMENT COMPOSITION ARE COMPACTED DEPTHS.
- ALL NEW KERB AND CHANNEL CONSTRUCTION IS TO MATCH IN NEATLY WITH THE EXISTING KERB & CHANNEL.
- THE EXACT LOCATION OF ALL SERVICES SHALL BE DETERMINED BY THE CONTRACTOR PRIOR TO EXCAVATING IN THEIR VICINITY. NO GUARANTEE IS GIVEN THAT ALL SERVICES ARE SHOWN. EXTREME CAUTION SHALL BE EXERCISED WHEN EXCAVATING IN THE VICINITY OF SERVICES, INCLUDING ELECTRICITY POLES, UNDERGROUND SERVICES, ETC. THE RELEVANT AUTHORITY SHALL BE CONTACTED PRIOR TO EXCAVATING IN CLOSE PROXIMITY TO SERVICES. SERVICE LOCATIONS ARE INDICATIVE ONLY.
- THE CONTRACTOR IS TO SUPPORT ELECTRICITY POLES ALL IN ACCORDANCE WITH RELEVANT SERVICE AUTHORITY REQUIREMENTS.

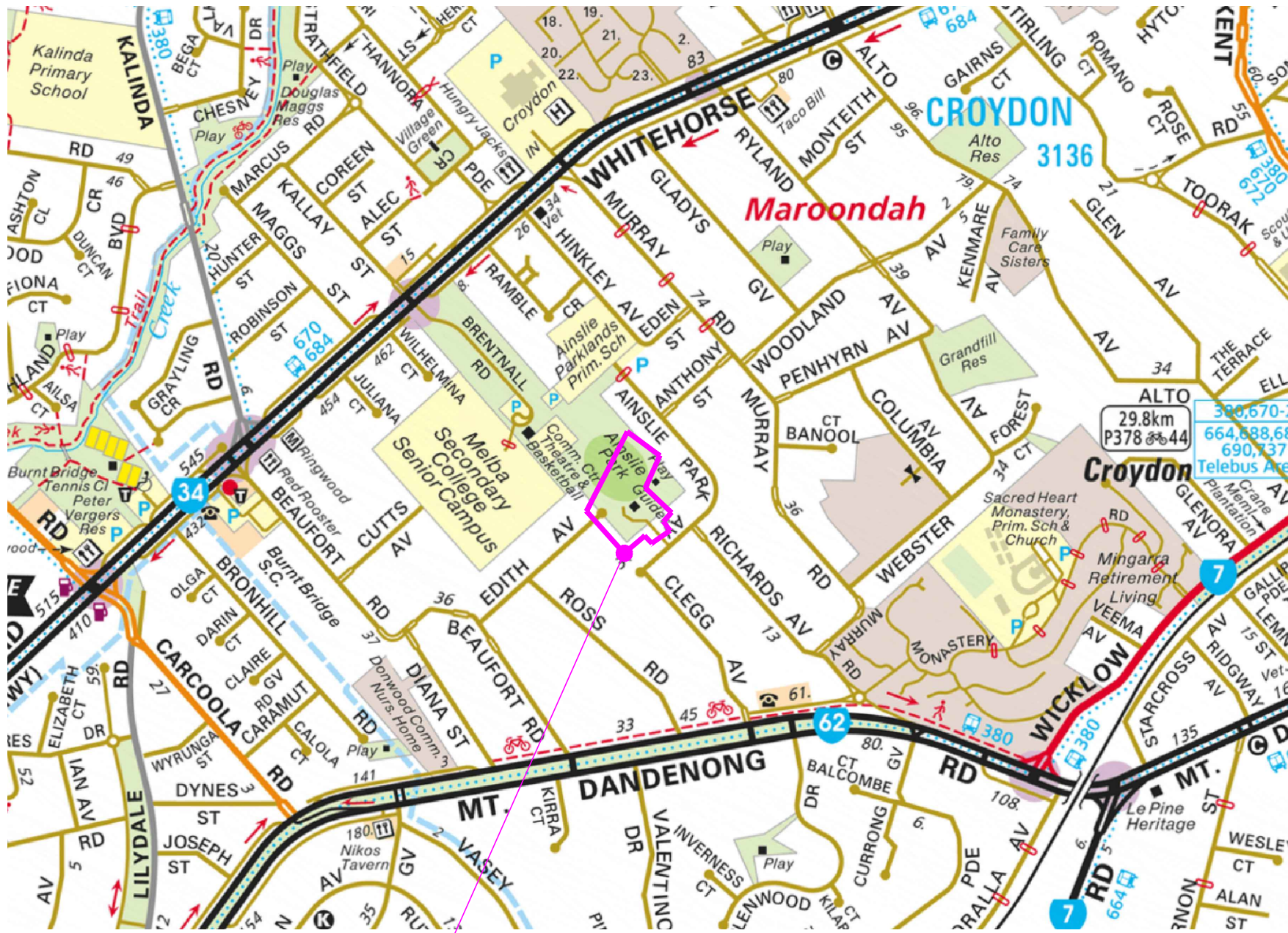

LOCALITY PLAN
NOT TO SCALE

DRAWING INDEX

SHEET No.	DESCRIPTION
1	FACE SHEET: - LOCALITY PLAN, GENERAL NOTES & DRAWING INDEX
2	DETAIL PLAN
3	DESIGN CONTOUR & SETOUT PLAN
4	REFERENCE LINE - LONGITUDINAL SECTION
5 - 7	REFERENCE LINE - CROSS SECTION
8	LEFT EDGE OF BITUMEN LONGITUDINAL SECTION
9	RIGHT EDGE OF BITUMEN LONGITUDINAL SECTION
10	FOOTPATH - LONGITUDINAL SECTION
11	FOOTPATH - CROSS SECTIONS
12	DRAINAGE LONGITUDINAL SECTIONS & PIT SCHEDULE
13	LINEMARKING & SIGNAGE PLAN

WARNING
BEWARE OF UNDERGROUND SERVICES
THE LOCATION OF UNDERGROUND SERVICES SHOWN ARE APPROXIMATE ONLY AND THEIR EXACT POSITION SHOULD BE PROVIDED ON SITE. NO GUARANTEE IS GIVEN THAT ALL SERVICES ARE SHOWN. THE CONTRACTOR MUST VERIFY ALL SERVICES ON SITE PRIOR TO ANY EXCAVATION WORKS.



NOTE:
THE APPOINTED CONTRACTOR SHALL INDEMNIFY AND HOLD HARMLESS THE COUNCIL, CRE CONSULTING ENGINEERS (CRE) AND ITS EMPLOYEES INCLUDING SUB-CONTRACTORS AGAINST ANY CLAIM FOR INJURY, LOSS OR DAMAGE THAT IS MADE ARISING OUT OF THE NEGLIGENT ACTS OR OMISSIONS OF THE CONTRACTOR. ALL INFORMATION PROVIDED ON THESE PLANS SHALL BE CHECKED BY THE APPOINTED CONTRACTOR PRIOR TO COMMENCING CONSTRUCTION. IF THERE ARE ANY ERRORS, PERCEIVED AMBIGUITY OR INFORMATION IS NOT UNDERSTOOD BY THE CONTRACTOR, THEN THE CONTRACTOR SHOULD CONTACT COUNCIL'S SUPERINTENDENT IMMEDIATELY FOR CLARIFICATION. COUNCIL SHOULD BE GIVEN THE OPPORTUNITY AND SUFFICIENT TIME TO INVESTIGATE, PRIOR TO ANY CONSTRUCTION COMMENCING OR CONTINUING. CRE WILL NOT BE HELD RESPONSIBLE OR LIABLE AGAINST ANY CLAIM MADE FOR MISINTERPRETATION OF THE SUPPLIED PLANS.

NOTE:
ALL NOTED "ABANDONED" SERVICES INCLUDING GAS MAINS, WATER MAINS, ETC. - THE CONTRACTOR SHALL BE RESPONSIBLE & CONFIRM THAT THESE SERVICES ARE ABANDONED, INCLUDING LIAISING WITH THE RELEVANT AUTHORITY PRIOR TO COMMENCING CONSTRUCTION.

NOTE:
THIS DESIGN IS PROTECTED BY COPYRIGHT LAWS AND CANNOT BE RELEASED TO ANY OTHER PERSON(S), OTHER THAN THE CLIENT INTENDED FOR AS INDICATED IN THE TITLE BLOCK ON THESE DRAWINGS. IN THE EVENT OF ANY USE OF THESE FILES, INCLUDING DISTRIBUTION, MODIFICATION, ENHANCEMENT OR FOR ADDITIONAL DESIGN WORK, CRE ASSUMES NO RESPONSIBILITY FOR THE ACCURACY AND INTEGRITY OF THE DATA.

LEGEND	TOF		EX TELSTRA OPTIC FIBRE		HPG		EX HIGH PRESSURE GAS MAIN												
	T	—T—	EX TELSTRA CABLE & PIT						—TS—		—TS—		STOP VALVE						
	S	—S—	EX SEWER & PIT						+		+		TRAFFIC SIGNAL POLE		CABLE, PEDESTAL				
	W	—W—	EX WATER MAIN						—		—		FIRE PLUG		UNCLASSIFIED PIT				
	ABW	—ABW—	EX ABANDONED WATER MAIN						—		—		FIRE HYDRANT (ABOVE GROUND)		FENCE		TREE		
	G	—G—	EX GAS MAIN						—		—		FIRE HYDRANT (GROUND LEVEL)		EX. SIGN		LIMIT OF WORKS		
	ABG	—ABG—	EX ABANDONED GAS MAIN						+		+		ELECTRICITY SUPPLY POLE		EXISTING BOLLARD		RUBBISH BIN		
	E	—E—	EX U/G ELECTRICITY CABLE						+		+		E.S.P. WITH LIGHT		EXISTING POST		PSM		
	E	—E—	EX O/H ELECTRICITY CABLE						+		+		LIGHT POLE ONLY		TELECOM PILLAR		STN/TBM		
	O	—O—	EX OPTUS CABLE						+		+		ELECTRICITY SUPPLY POLE		EXISTING POST		EXISTING POST		
HD	—HD—	HOUSE DRAIN						+		+		E.S.P. WITH LIGHT		TELECOM PILLAR		EXISTING POST			

CRE
CRE CONSULTING ENGINEERS PTY LTD
Civil • Municipal • Drainage • Project Management

Level 1/116 Puckle Street, Moonee Ponds, Vic, 3039
Phone: 0417 318 556
Email: admin@creconsulting.com.au

DESIGNED : CRE	DATE : 19/02/25
CHECKED : DATE :	
SURVEYED : SURF/COAST	DATE : 08/24
SURVEY DATUM : A.H.D. / MGA2020	
SCALES : AS SHOWN	@A1



AINSLIE PARK, CROYDON
CAR PARK UPGRADE
FACE SHEET

CRE REF: 3193--(REV-P7).DWG	
CRE REV. NO.: P7	
AMEND. NO.: -	
DWG. NO. 3193	
SHEET: 1 OF 13	SIZE: A1

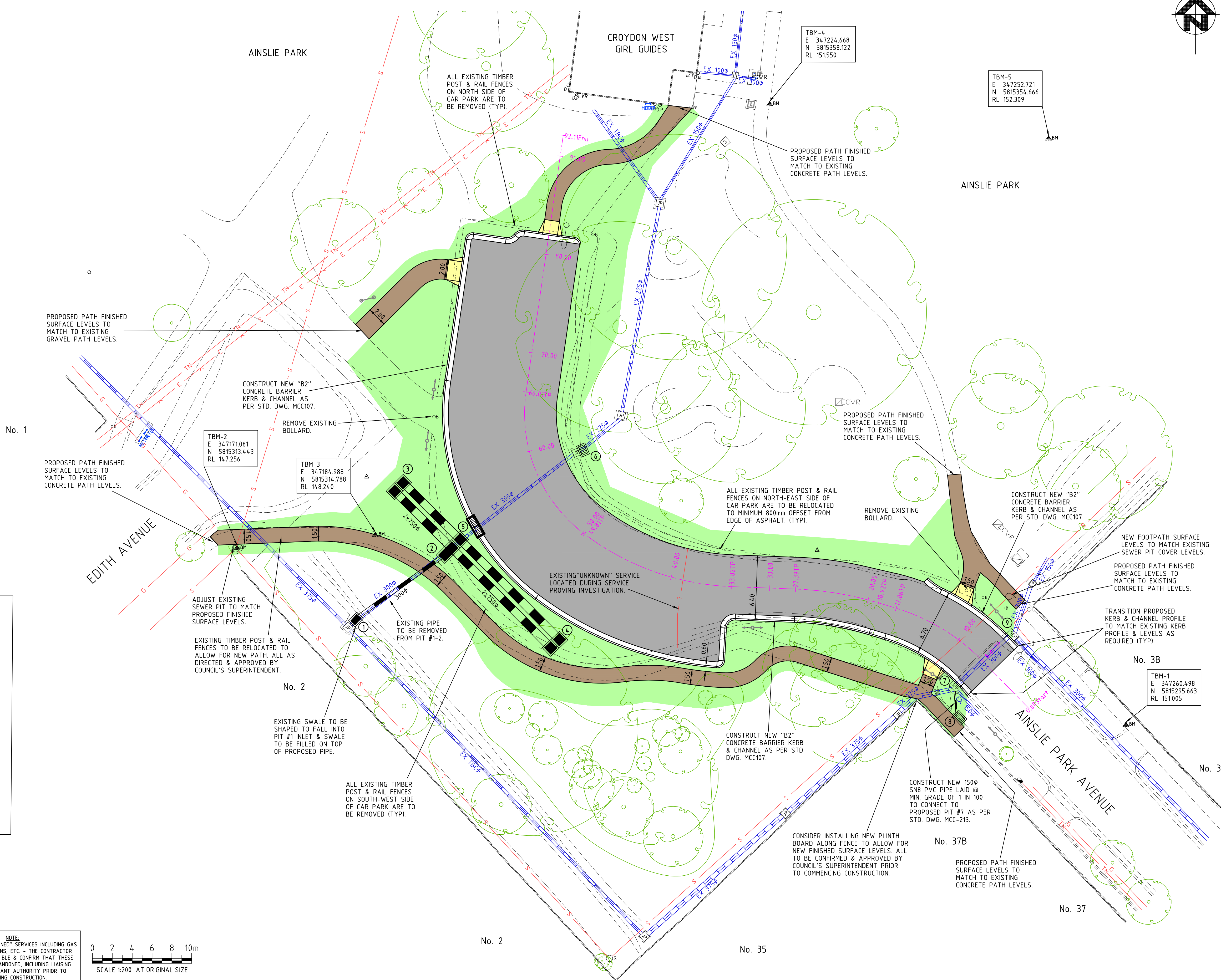
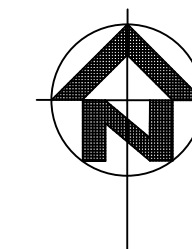

LEGEND

FULL DEPTH PAVEMENT CONSTRUCTION
WEARING COURSE:- 40mm DEPTH 10mm SIZE TYPE H ASPHALT.
BASE COURSE:- 100mm DEPTH 20mm SIZE CLASS 2 CRUSHED ROCK.
REGULATION COURSE:- VARYING DEPTH 20mm SIZE CLASS 2 CRUSHED ROCK.

CONCRETE FOOTPATH
CONSTRUCT 125mm DEPTH REINFORCED (SL72 MESH) CONCRETE FOOTPATH ON 50mm DEPTH CLASS 3 FCR, AS PER MCC STD DWG MCC-401.

CONCRETE PRAM CROSSING
CONSTRUCT CONCRETE PRAM CROSSINGS AS PER MCC STD DWG MCC-405 & MCC-406.

REINSTATEMENT OF NATURE STRIPS
REINSTATEMENT OF NATURE STRIPS / BATTERS, INCLUDING SUPPLY AND SPREADING 100mm DEPTH TOP SOIL AND HYDRO MULCHING.

WARNING
BEWARE OF UNDERGROUND SERVICES
THE LOCATION OF UNDERGROUND SERVICES SHOWN ARE APPROXIMATE ONLY AND THEIR EXACT POSITION SHOULD BE PROVIDED ON SITE. NO GUARANTEE IS GIVEN THAT ALL SERVICES ARE SHOWN. THE CONTRACTOR MUST VERIFY ALL SERVICES ON SITE PRIOR TO ANY EXCAVATION WORKS.



NOTE:
ALL NOTED "ABANDONED" SERVICES INCLUDING GAS MAINS, WATER MAINS, ETC. - THE CONTRACTOR SHALL BE RESPONSIBLE & CONFIRM THAT THESE SERVICES ARE ABANDONED, INCLUDING LIAISING WITH THE RELEVANT AUTHORITY PRIOR TO COMMENCING CONSTRUCTION.

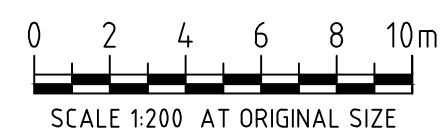

LEGEND	TOF		EX TELSTRA OPTIC FIBRE		EX HIGH PRESSURE GAS MAIN	
	SYMBOL	DESCRIPTION	SYMBOL	DESCRIPTION	SYMBOL	DESCRIPTION
TOF	T	EX TELSTRA CABLE & PIT	+	STOP VALVE	TS	TRAFFIC SIGNAL PIT, CABLE, PEDESTAL
	S	EX SEWER & PIT	+	FIRE PLUG	+	TRAFFIC SIGNAL POLE
	W	EX WATER MAIN	+	FIRE HYDRANT (ABOVE GROUND)	+	FENCE
	AW	EX ABANDONED WATER MAIN	+	FIRE HYDRANT (GROUND LEVEL)	+	EX. SIGN
	G	EX GAS MAIN	+	ELECTRICITY SUPPLY POLE	+	EXISTING BOLLARD
	AG	EX ABANDONED GAS MAIN	+	E.S.P. WITH LIGHT	+	RUBBISH BIN
	E	EX U/G ELECTRICITY CABLE	+	LIGHT POLE ONLY	+	EX DRAIN & PIT
	EA	EX O/H ELECTRICITY CABLE	+	TELECOM PILLAR	+	PROPOSED DRAIN & PIT
	O	EX OPTUS CABLE	+	EXISTING POST	+	PSM
	HD	EX HOUSE DRAIN	+		+	STN/TBM
EX HIGH PRESSURE GAS MAIN	+	STOP VALVE	+	TRAFFIC SIGNAL PIT, CABLE, PEDESTAL	+	TRAFFIC SIGNAL POLE
	+	FIRE PLUG	+	FENCE	+	EX. SIGN
	+	FIRE HYDRANT (ABOVE GROUND)	+	EXISTING BOLLARD	+	RUBBISH BIN
	+	FIRE HYDRANT (GROUND LEVEL)	+	RUBBISH BIN	+	EX DRAIN & PIT
	+	ELECTRICITY SUPPLY POLE	+	EX DRAIN & PIT	+	PROPOSED DRAIN & PIT
	+	E.S.P. WITH LIGHT	+	PROPOSED DRAIN & PIT	+	PSM
	+	LIGHT POLE ONLY	+	PSM	+	STN/TBM
	+	TELECOM PILLAR	+	STN/TBM	+	
	+	EXISTING POST	+		+	
	+		+		+	

NO.	AMENDMENTS	DATE

CRE CONSULTING ENGINEERS PTY LTD
Civil • Municipal • Drainage • Project Management

Level 1/116 Puckle Street, Moonee Ponds, Vic, 3039
Phone: 0417 318 556
Email: admin@creconsulting.com.au

DESIGNED : CRE	DATE : 19/02/25
CHECKED : DATE :	
SURVEYED : SURFCEAST	DATE : 08/24
SURVEY DATUM : A.H.D. / MGA2020	
SCALES : AS SHOWN	©A1

CLIENT:

Maroondah
City Council

ANSLIE PARK, CROYDON CAR PARK UPGRADE		CRE REF: 3193-(REV-P7).DWG
DETAIL PLAN		CRE REV. NO.: P7
		AMEND. NO.: -
		DWG. NO. 3193
		SHEET: 2 OF 13
		SIZE: A1

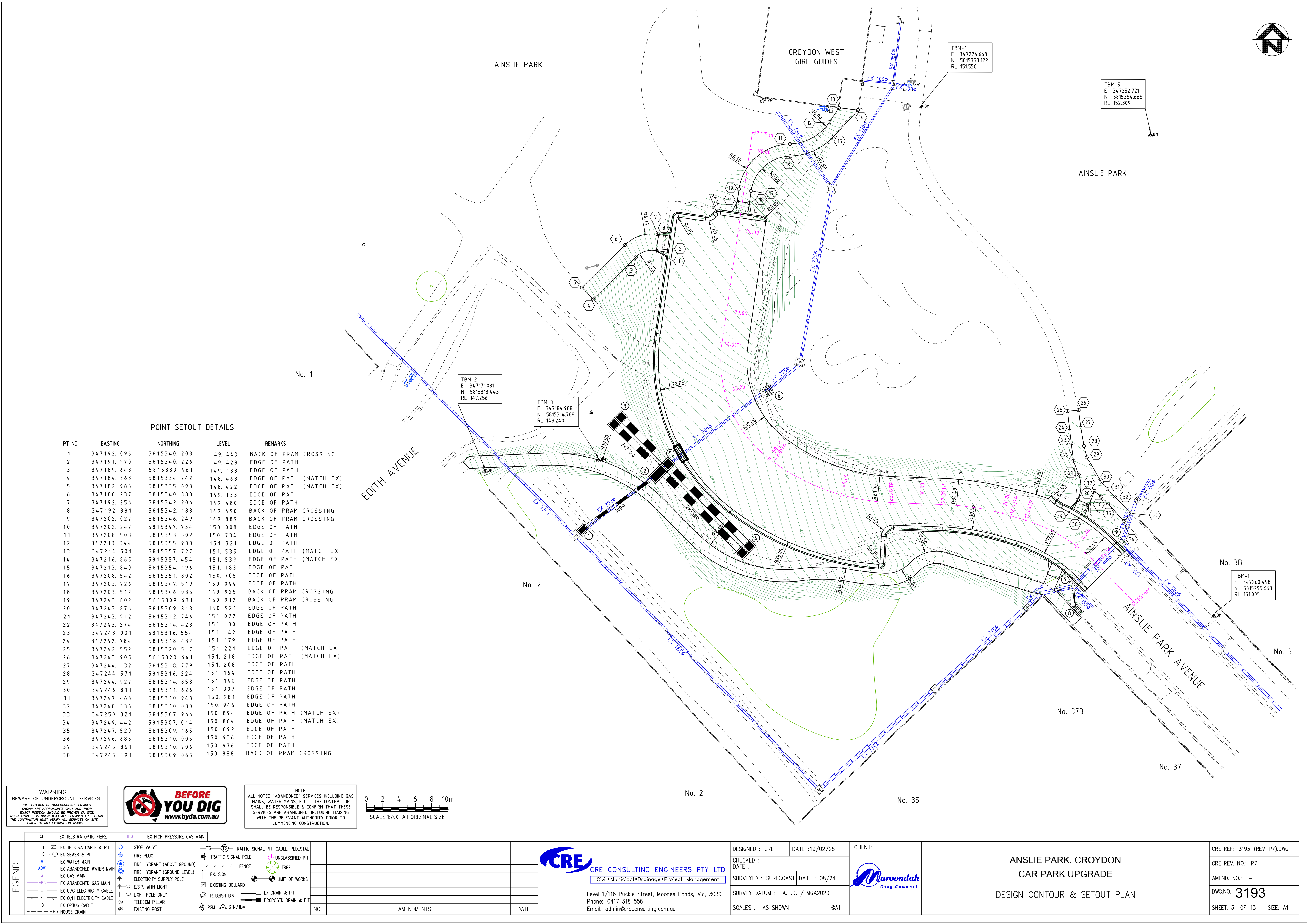

POINT SETOUT DETAILS

PT NO.	EASTING	NORTHING	LEVEL	REMARKS
1	347192.095	5815340.208	149.440	BACK OF PRAM CROSSING
2	347191.970	5815340.226	149.428	EDGE OF PATH
3	347189.643	5815339.461	149.183	EDGE OF PATH
4	347184.363	5815334.242	148.468	EDGE OF PATH (MATCH EX)
5	347182.986	5815335.693	148.422	EDGE OF PATH (MATCH EX)
6	347188.237	5815340.883	149.133	EDGE OF PATH
7	347192.256	5815342.206	149.480	EDGE OF PATH
8	347192.381	5815342.188	149.490	BACK OF PRAM CROSSING
9	347202.027	5815346.249	149.889	BACK OF PRAM CROSSING
10	347202.242	5815347.734	150.008	EDGE OF PATH
11	347208.503	5815353.302	150.734	EDGE OF PATH
12	347213.344	5815355.983	151.321	EDGE OF PATH
13	347214.501	5815357.727	151.535	EDGE OF PATH (MATCH EX)
14	347216.865	5815357.454	151.539	EDGE OF PATH (MATCH EX)
15	347213.840	5815354.196	151.183	EDGE OF PATH
16	347208.542	5815351.802	150.705	EDGE OF PATH
17	347203.726	5815347.519	150.044	EDGE OF PATH
18	347203.512	5815346.035	149.925	BACK OF PRAM CROSSING
19	347243.802	5815309.631	150.912	BACK OF PRAM CROSSING
20	347243.876	5815309.813	150.921	EDGE OF PATH
21	347243.912	5815312.746	151.072	EDGE OF PATH
22	347243.274	5815314.423	151.100	EDGE OF PATH
23	347243.001	5815316.554	151.142	EDGE OF PATH
24	347242.784	5815318.432	151.179	EDGE OF PATH
25	347242.552	5815320.517	151.221	EDGE OF PATH (MATCH EX)
26	347243.905	5815320.641	151.218	EDGE OF PATH (MATCH EX)
27	347244.132	5815318.779	151.208	EDGE OF PATH
28	347244.571	5815316.224	151.164	EDGE OF PATH
29	347244.927	5815314.853	151.140	EDGE OF PATH
30	347246.811	5815311.626	151.007	EDGE OF PATH
31	347247.468	5815310.948	150.981	EDGE OF PATH
32	347248.336	5815310.030	150.946	EDGE OF PATH
33	347250.321	5815307.966	150.894	EDGE OF PATH (MATCH EX)
34	347249.442	5815307.014	150.864	EDGE OF PATH (MATCH EX)
35	347247.520	5815309.165	150.892	EDGE OF PATH
36	347246.685	5815310.005	150.936	EDGE OF PATH
37	347245.861	5815310.706	150.976	EDGE OF PATH
38	347245.191	5815309.065	150.888	BACK OF PRAM CROSSING

WARNING
BEWARE OF UNDERGROUND SERVICES
THE LOCATION OF UNDERGROUND SERVICES SHOWN ARE APPROXIMATE ONLY AND THEIR EXACT POSITION SHOULD BE PROVIDED ON SITE. NO GUARANTEE IS GIVEN THAT ALL SERVICES ARE SHOWN. THE CONTRACTOR MUST VERIFY ALL SERVICES ON SITE PRIOR TO ANY EXCAVATION WORKS.



NOTE:
ALL NOTED "ABANDONED" SERVICES INCLUDING GAS MAINS, WATER MAINS, ETC. THE CONTRACTOR SHALL BE RESPONSIBLE & CONFIRM THAT THESE SERVICES ARE ABANDONED, INCLUDING LIAISING WITH THE RELEVANT AUTHORITY PRIOR TO COMMENCING CONSTRUCTION.



LEGEND	TOF EX TELSTRA OPTIC FIBRE		HPG EX HIGH PRESSURE GAS MAIN	
	T	EX TELSTRA CABLE & PIT	S	EX SEWER & PIT
	W	EX WATER MAIN	ABW	EX ABANDONED WATER MAIN
	G	EX GAS MAIN	ABG	EX ABANDONED GAS MAIN
	E	EX U/G ELECTRICITY CABLE	E	EX O/H ELECTRICITY CABLE
	O	EX OPTUS CABLE	HD	HOUSE DRAIN
	STOP VALVE			
	FIRE PLUG			
	FIRE HYDRANT (ABOVE GROUND)			
	FIRE HYDRANT (GROUND LEVEL)			
	ELECTRICITY SUPPLY POLE			
	E.S.P. WITH LIGHT			
	LIGHT POLE ONLY			
	TELECOM PILLAR			
	EXISTING POST			
	TRAFFIC SIGNAL PIT, CABLE, PEDESTAL			
	TRAFFIC SIGNAL POLE			
	UNCLASSIFIED PIT			
	EX. SIGN			
	EXISTING BOLLARD			
	RUBBISH BIN			
	PSM			
	STN/TBM			
	EX DRAIN & PIT			
	PROPOSED DRAIN & PIT			
	NO.	AMENDMENTS	DATE	

**CRE CONSULTING ENGINEERS PTY LTD**
Civil • Municipal • Drainage • Project Management

Level 1/116 Puckle Street, Moonee Ponds, Vic, 3039
Phone: 0417 318 556
Email: admin@creconsulting.com.au

DESIGNED : CRE	DATE : 19/02/25
CHECKED : DATE :	
SURVEYED : SURFCOAST	DATE : 08/24
SURVEY DATUM : A.H.D. / MGA2020	
SCALES : AS SHOWN	@A1



ANSLIE PARK, CROYDON
CAR PARK UPGRADE
DESIGN CONTOUR & SETOUT PLAN

CRE REF: 3193-(REV-P7).DWG
CRE REV. NO.: P7
AMEND. NO.: -
DWG. NO. 3193
SHEET: 3 OF 13
SIZE: A1

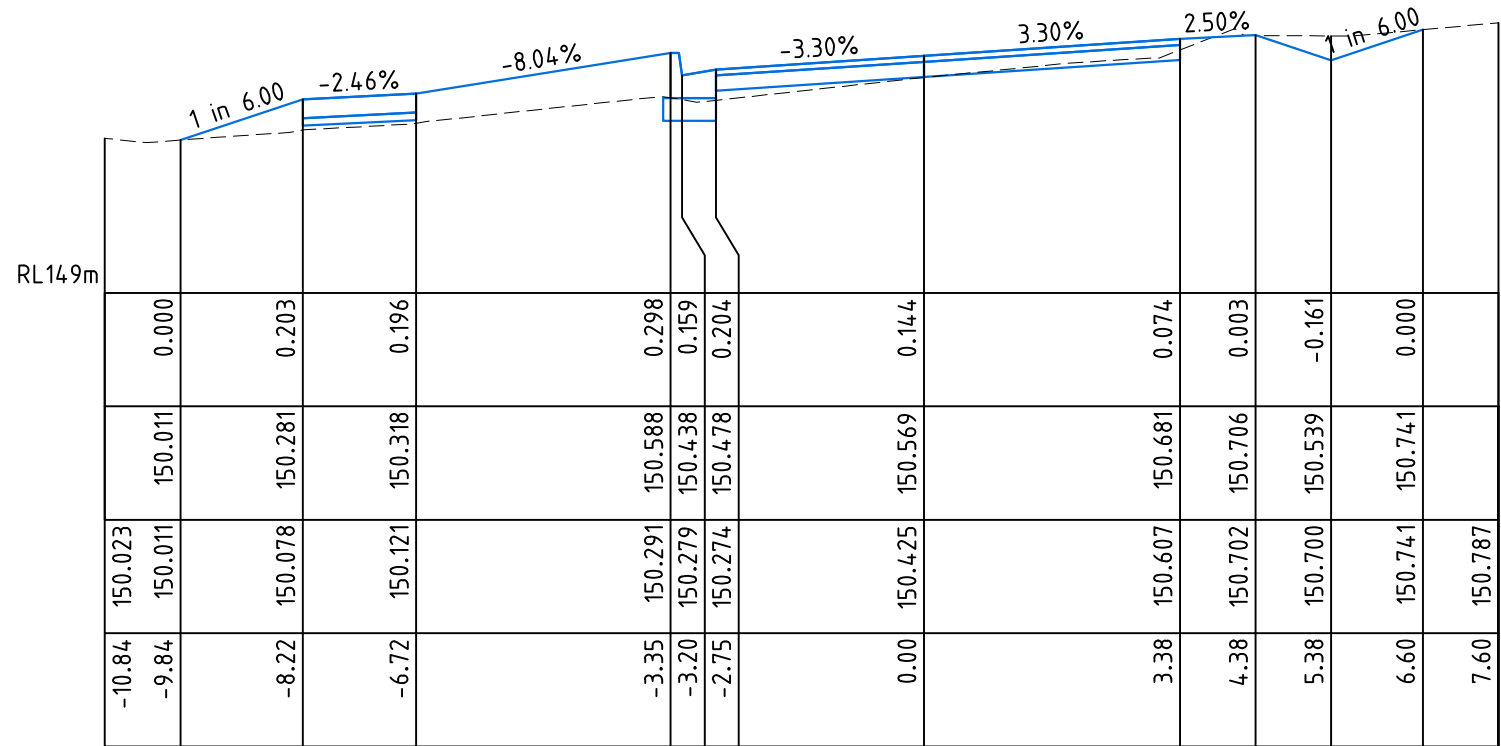

CH 17.06

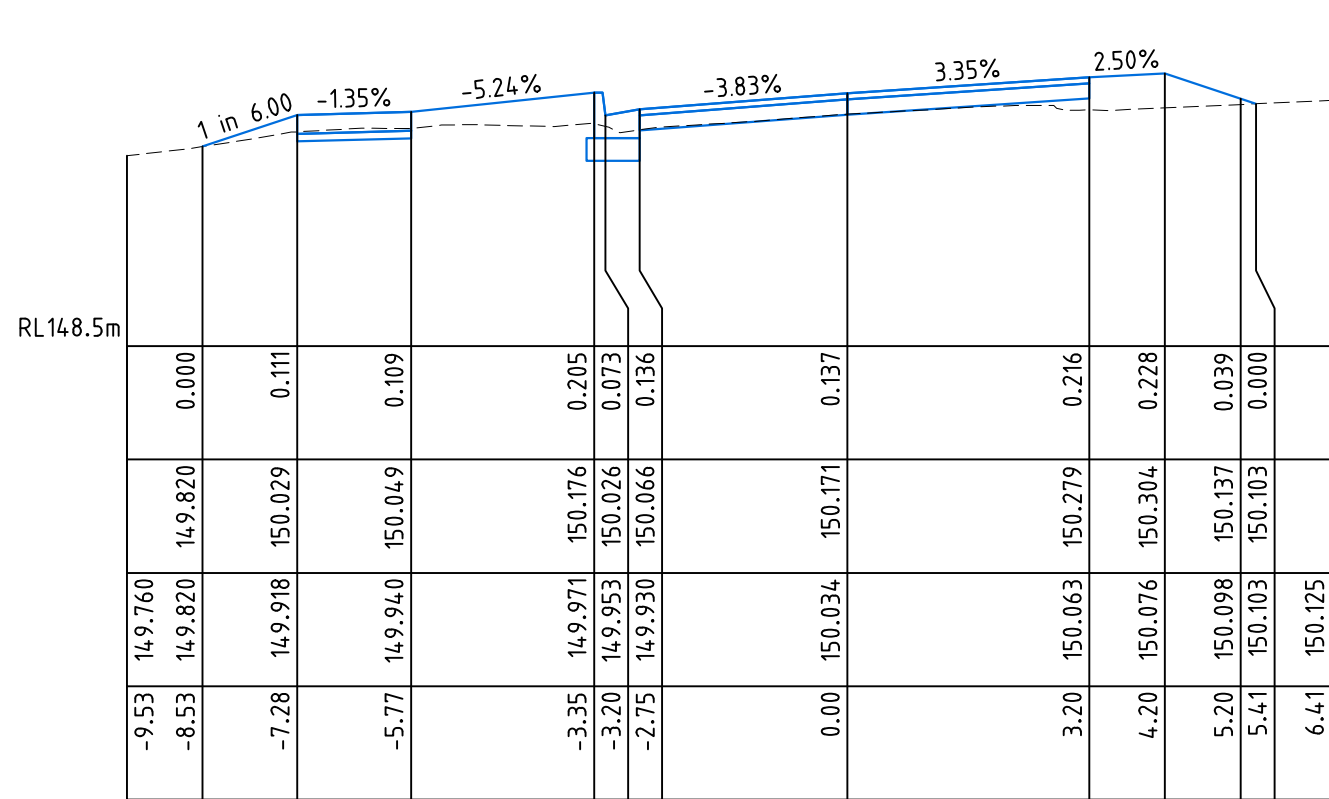

CH 27.39

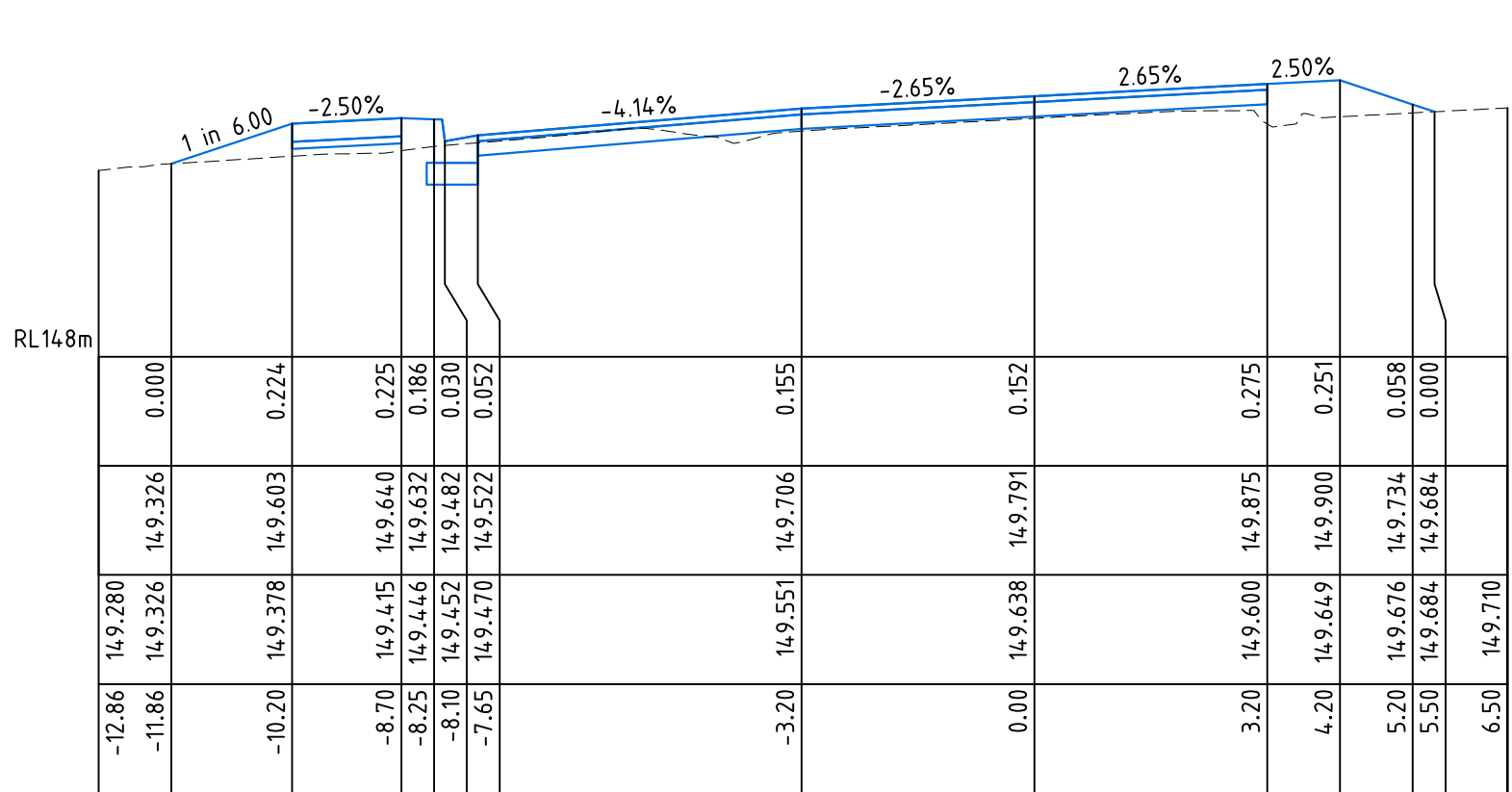

CH 34.74

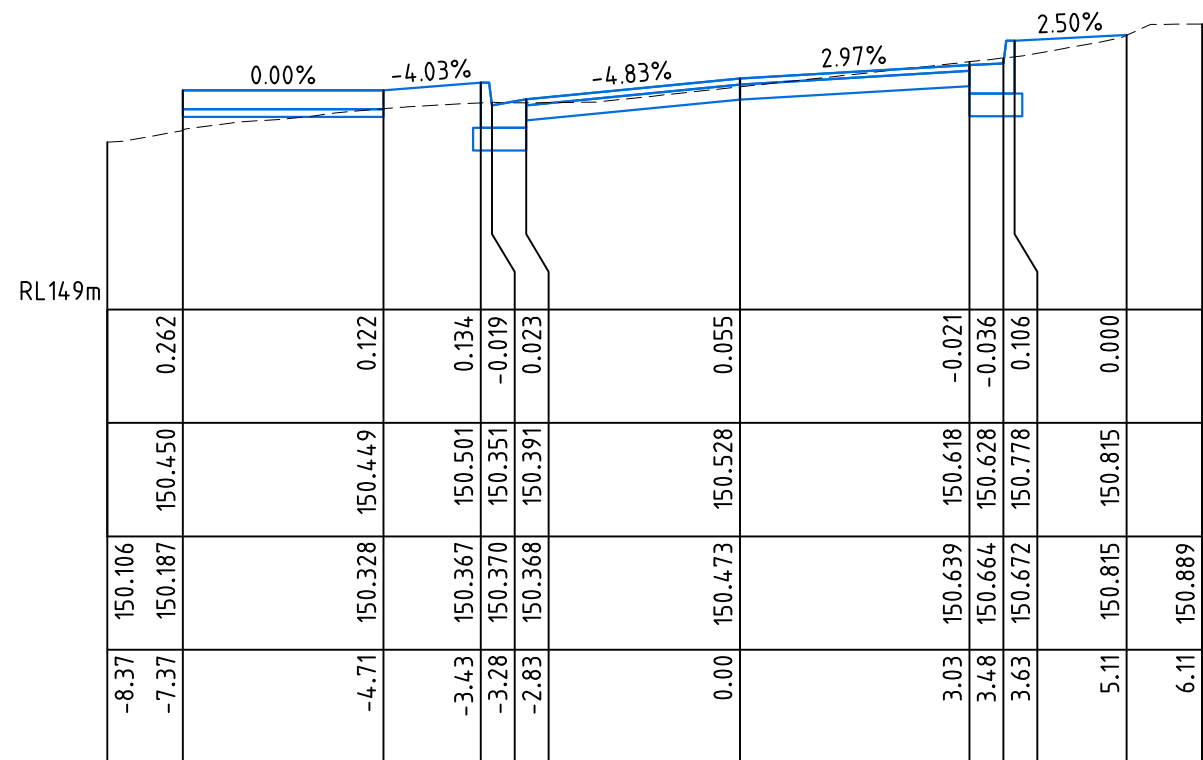

CH 10.00

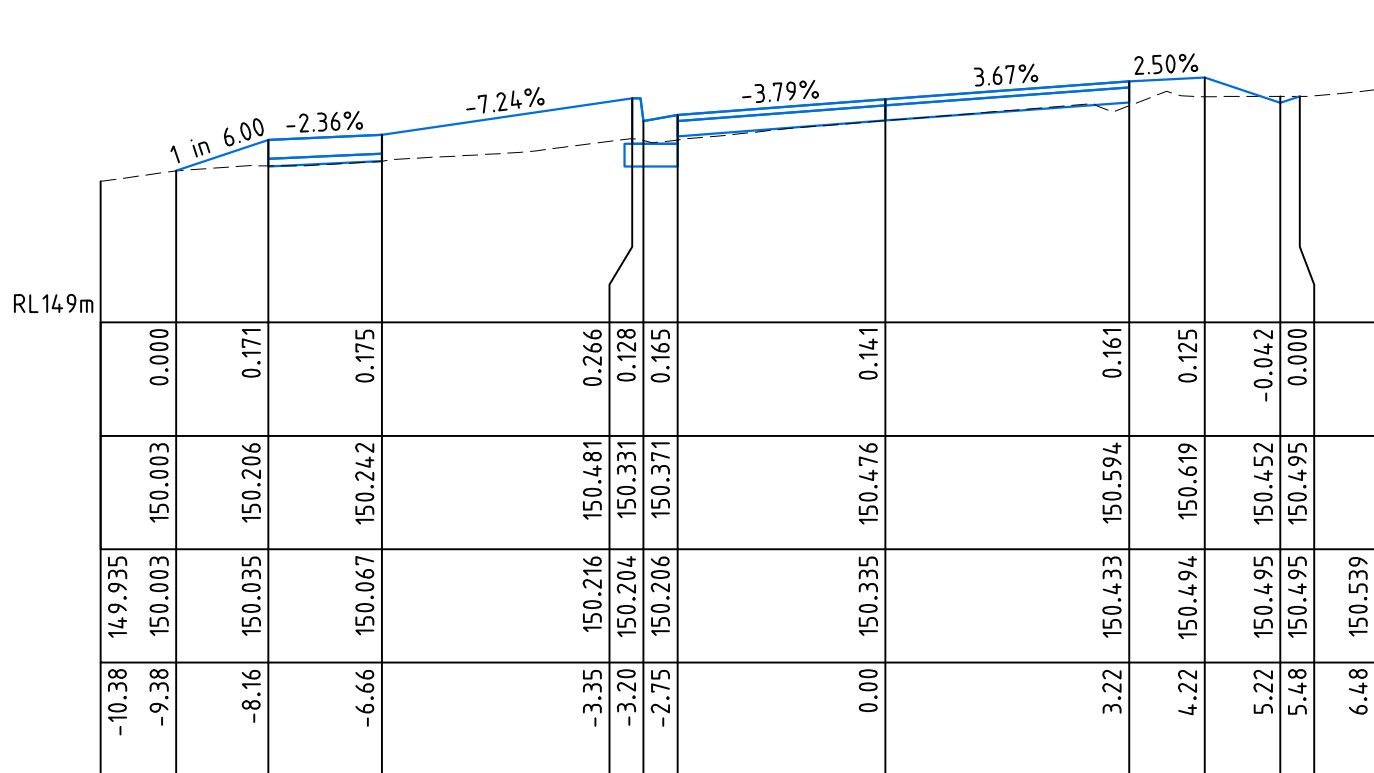

CH 20.00

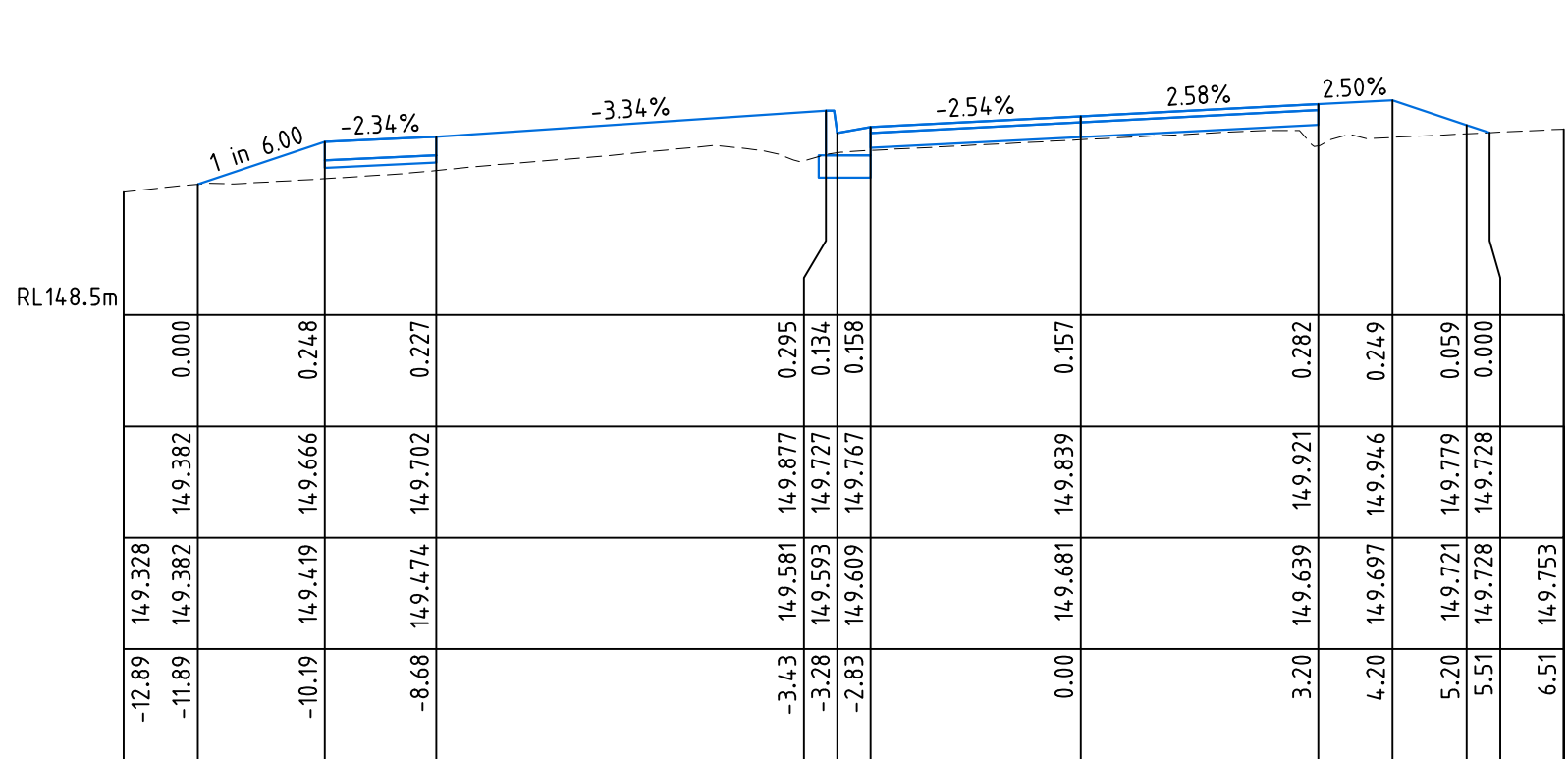

CH 33.82

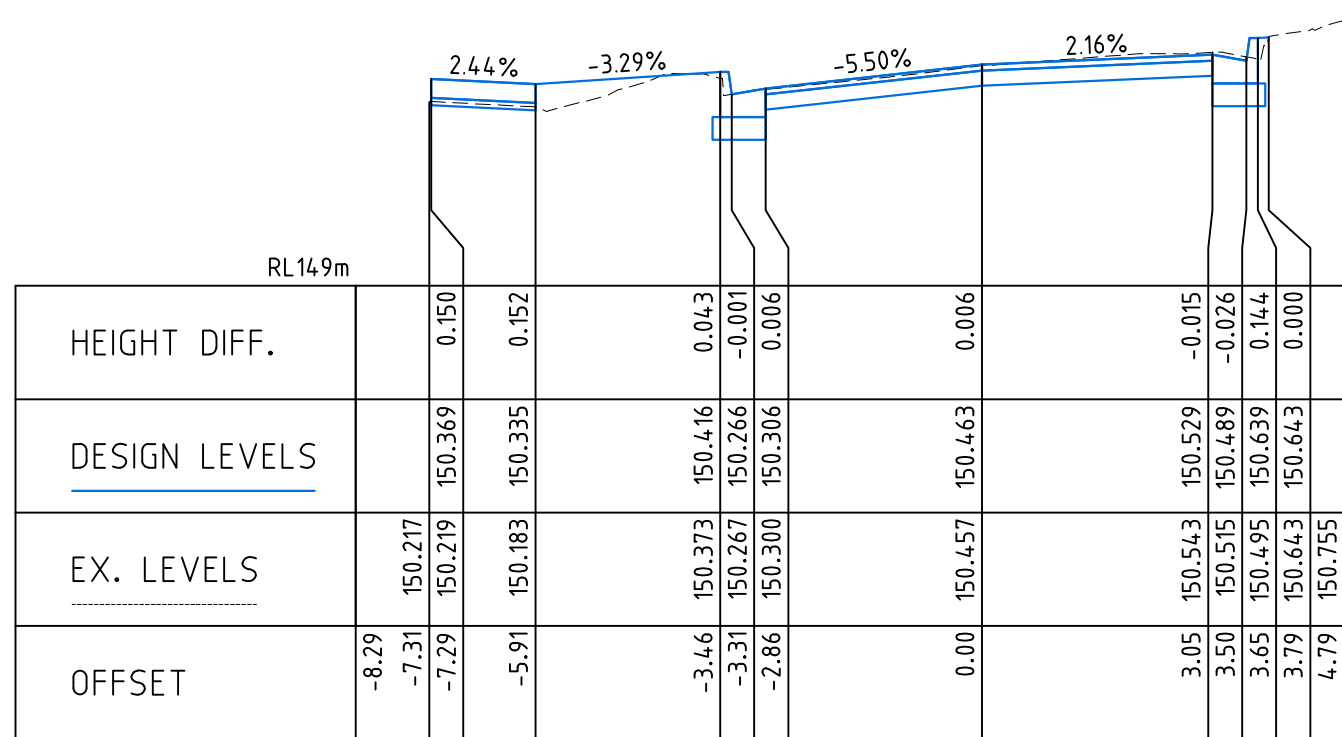

CH 6.84

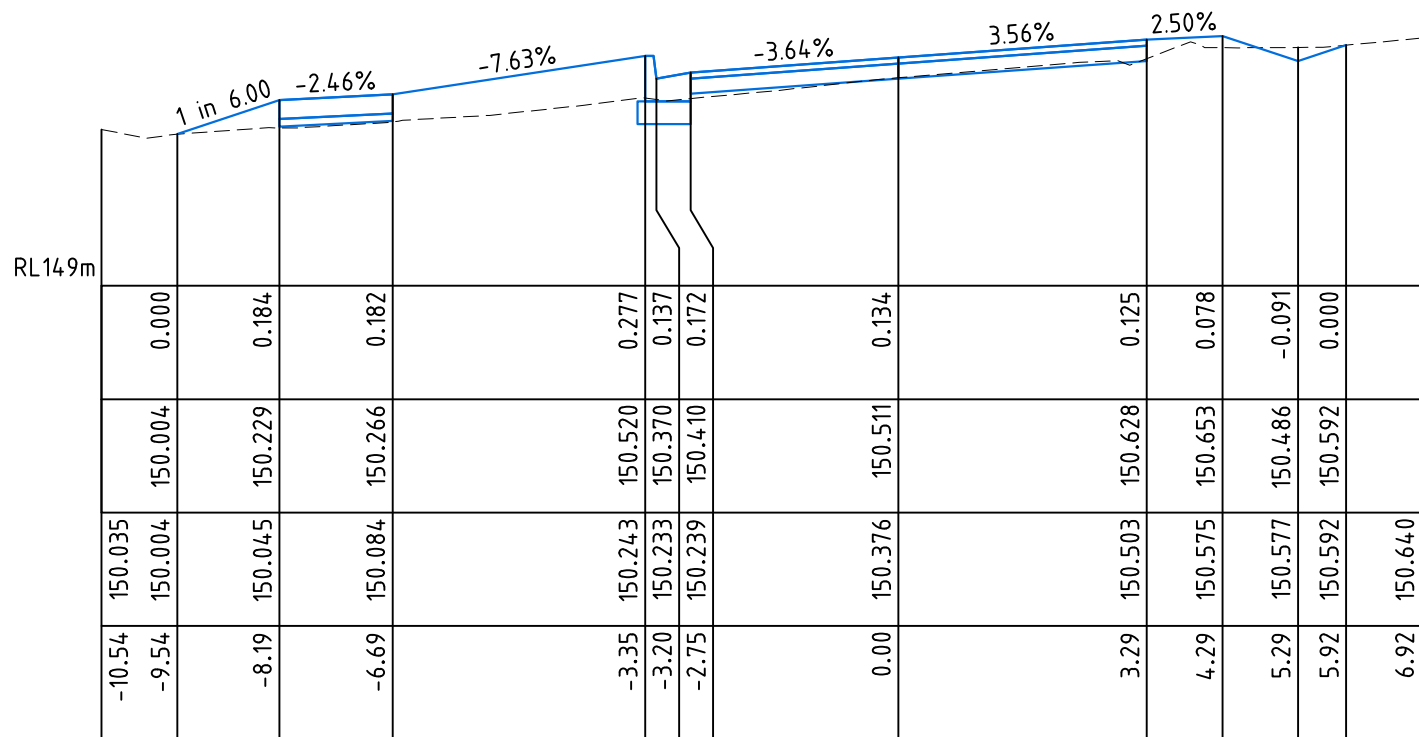

CH 18.92

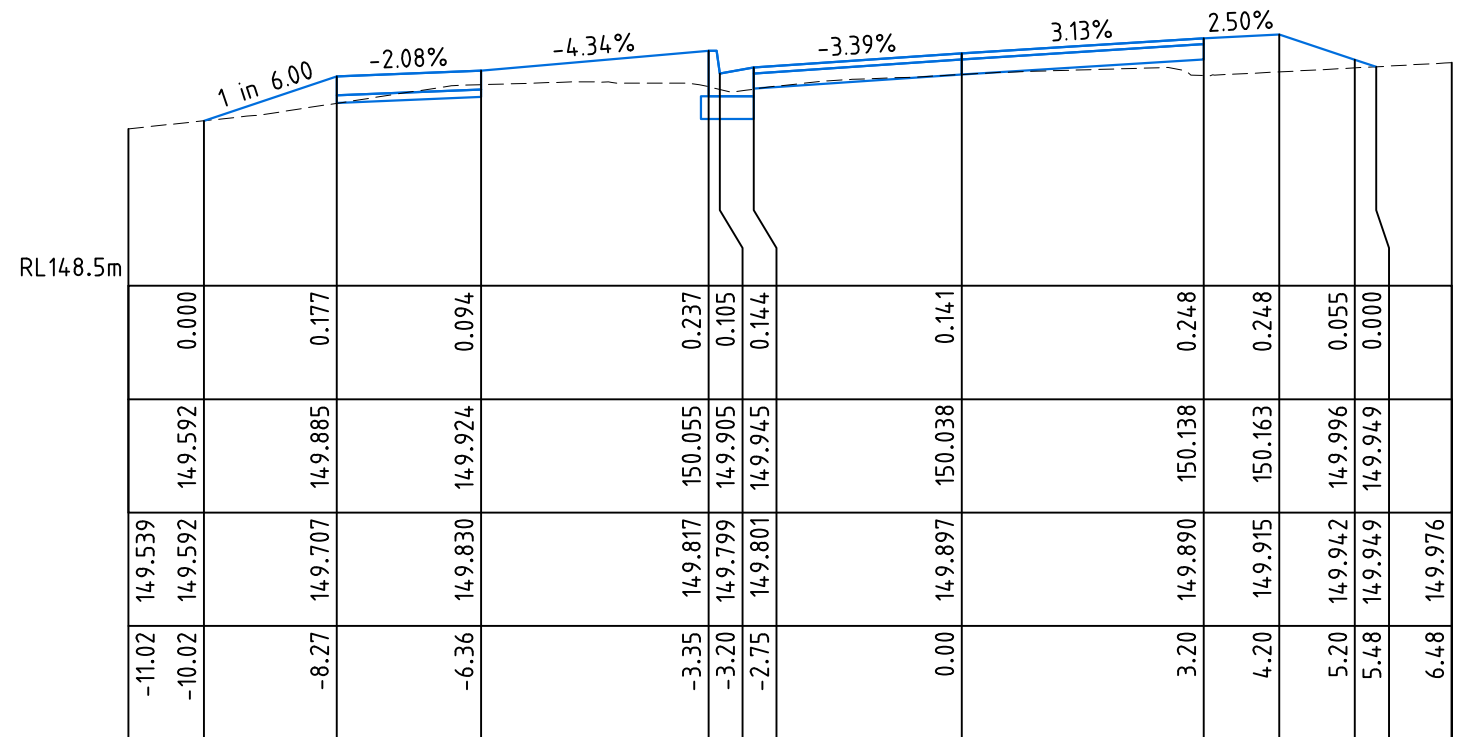

CH 30.00

WARNING
BEWARE OF UNDERGROUND SERVICES
THE LOCATION OF UNDERGROUND SERVICES SHOWN ARE APPROXIMATE ONLY AND THEIR EXACT POSITION SHOULD BE PROVIDED ON SITE. NO GUARANTEE IS GIVEN THAT ALL SERVICES ARE SHOWN. THE CONTRACTOR MUST VERIFY ALL SERVICES ON SITE PRIOR TO ANY EXCAVATION WORKS.



NOTE:
ALL NOTED "ABANDONED" SERVICES INCLUDING GAS MAINS, WATER MAINS, ETC. - THE CONTRACTOR SHALL BE RESPONSIBLE & CONFIRM THAT THESE SERVICES ARE ABANDONED, INCLUDING LIAISING WITH THE RELEVANT AUTHORITY PRIOR TO COMMENCING CONSTRUCTION.

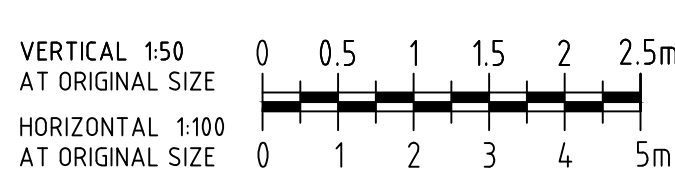

LEGEND	SYMBOLS	
	SYMBOL	DESCRIPTION
EXISTING	T	EX TELSTRA CABLE & PIT
	S	EX SEWER & PIT
	W	EX WATER MAIN
	ABW	EX ABANDONED WATER MAIN
	G	EX GAS MAIN
	ABG	EX ABANDONED GAS MAIN
	E	EX U/G ELECTRICITY CABLE
	E	EX O/H ELECTRICITY CABLE
	O	EX OPTUS CABLE
	HD	EX HOUSE DRAIN
PROPOSED	SV	STOP VALVE
	FP	FIRE PLUG
	FH	FIRE HYDRANT (ABOVE GROUND)
	FHL	FIRE HYDRANT (GROUND LEVEL)
	ESP	ELECTRICITY SUPPLY POLE
	ESP	E.S.P. WITH LIGHT
	LPO	LIGHT POLE ONLY
	TP	TELECOM PILLAR
	EP	EXISTING POST
	TS	TRAFFIC SIGNAL PIT, CABLE, PEDESTAL
OTHER	TS	TRAFFIC SIGNAL POLE
	F	FENCE
	ES	EX. SIGN
	EB	EXISTING BOLLARD
	RB	RUBBISH BIN
	PSM	PROPOSED DRAIN & PIT
	STN/TBM	STATION/TUNNEL BORE
	W	WATER MAIN
	G	GAS MAIN
	E	ELECTRICITY CABLE

NO.	AMENDMENTS	DATE

**CRE CONSULTING ENGINEERS PTY LTD**
Civil • Municipal • Drainage • Project Management

Level 1/116 Puckle Street, Moonee Ponds, Vic, 3039
Phone: 0417 318 556
Email: admin@creconsulting.com.au

DESIGNED : CRE	DATE :19/02/25
CHECKED : DATE :	
SURVEYED : SURFCEAST	DATE : 08/24
SURVEY DATUM : A.H.D. / MGA2020	
SCALES : AS SHOWN	@A1

CLIENT:

**Maroondah**
City Council

ANSLIE PARK, CROYDON CAR PARK UPGRADE		CRE REF: 3193--(REV-P7).DWG	
REFERENCE LINE – CROSS SECTIONS		CRE REV. NO.: P7	
		AMEND. NO.: -	
		DWG.NO. 3193	
		SHEET: 5 OF 13	SIZE: A1

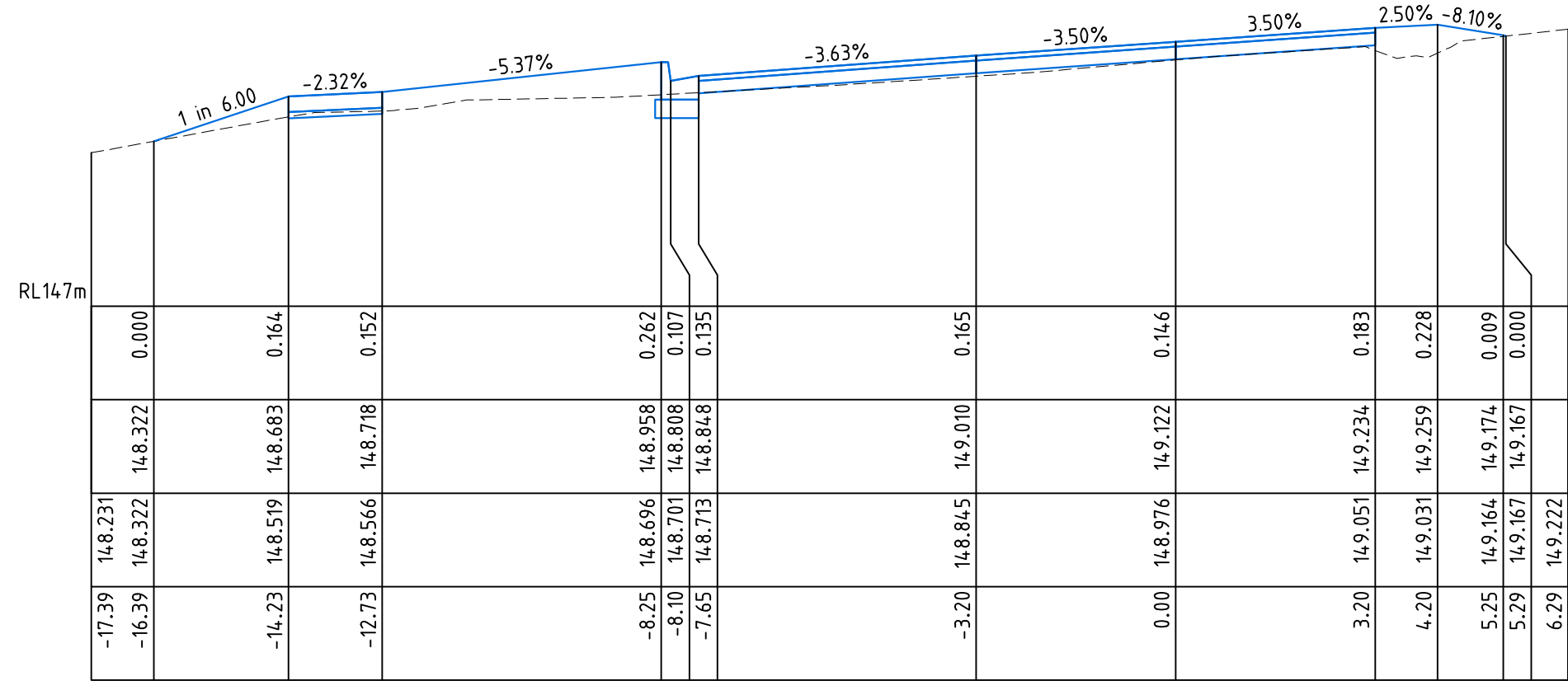

CH 50.00

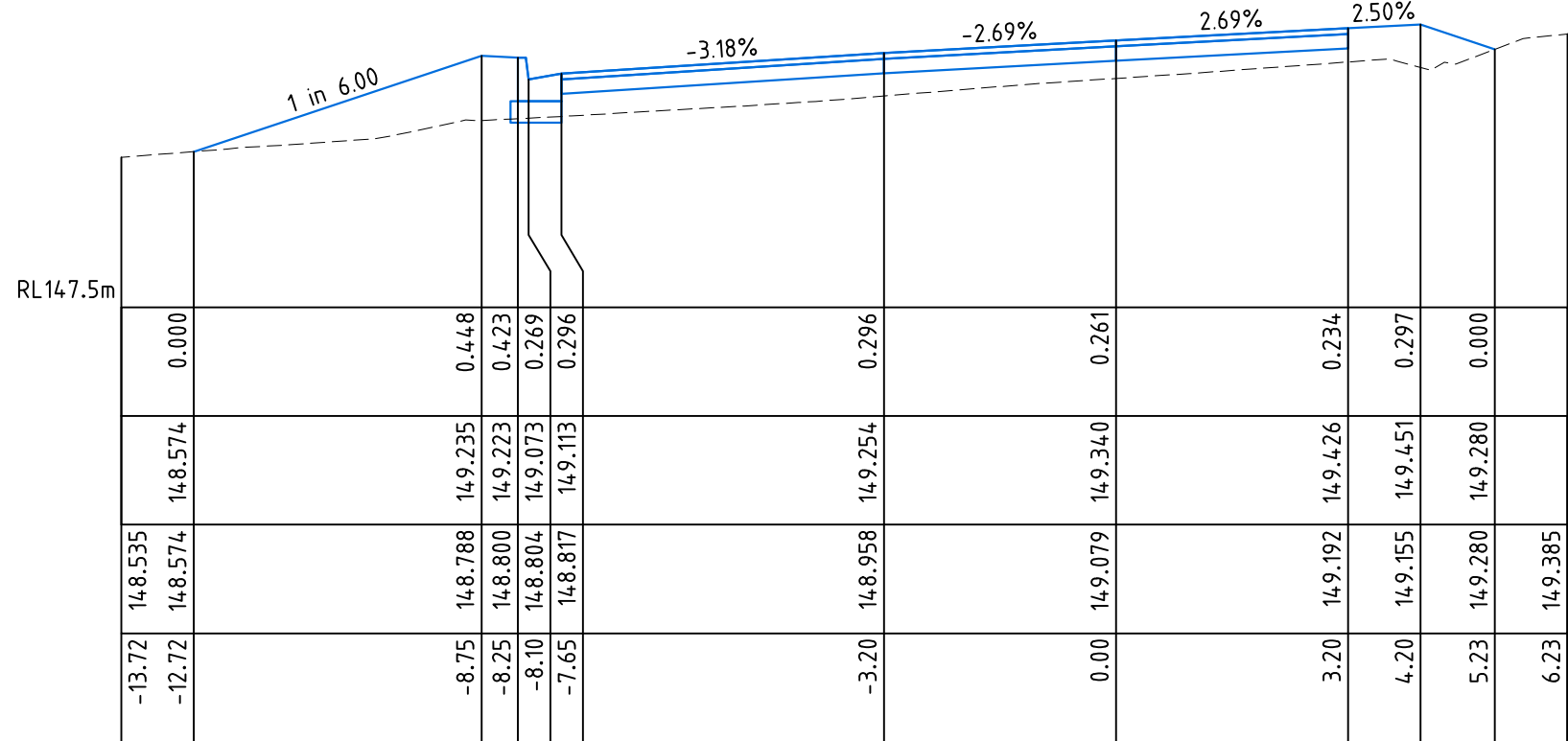

CH 66.01

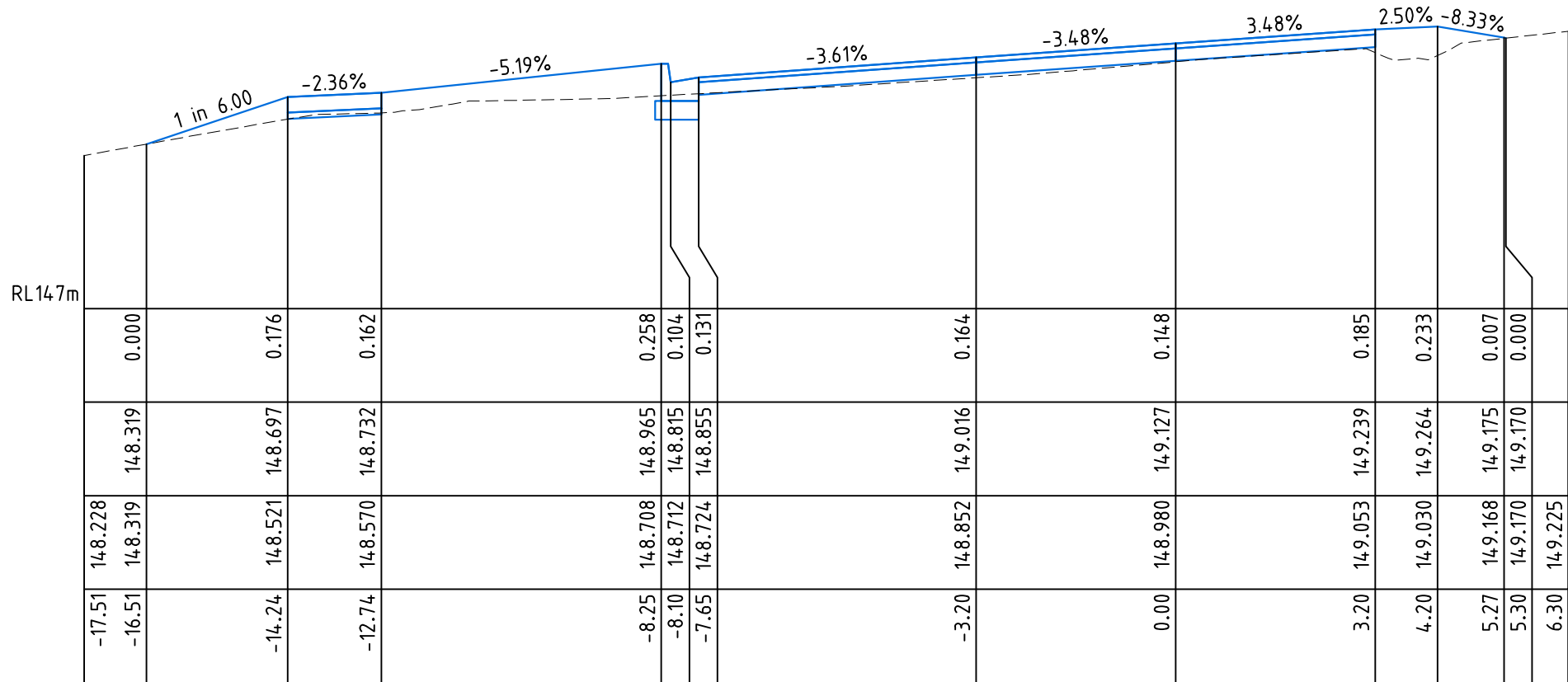

CH 49.81

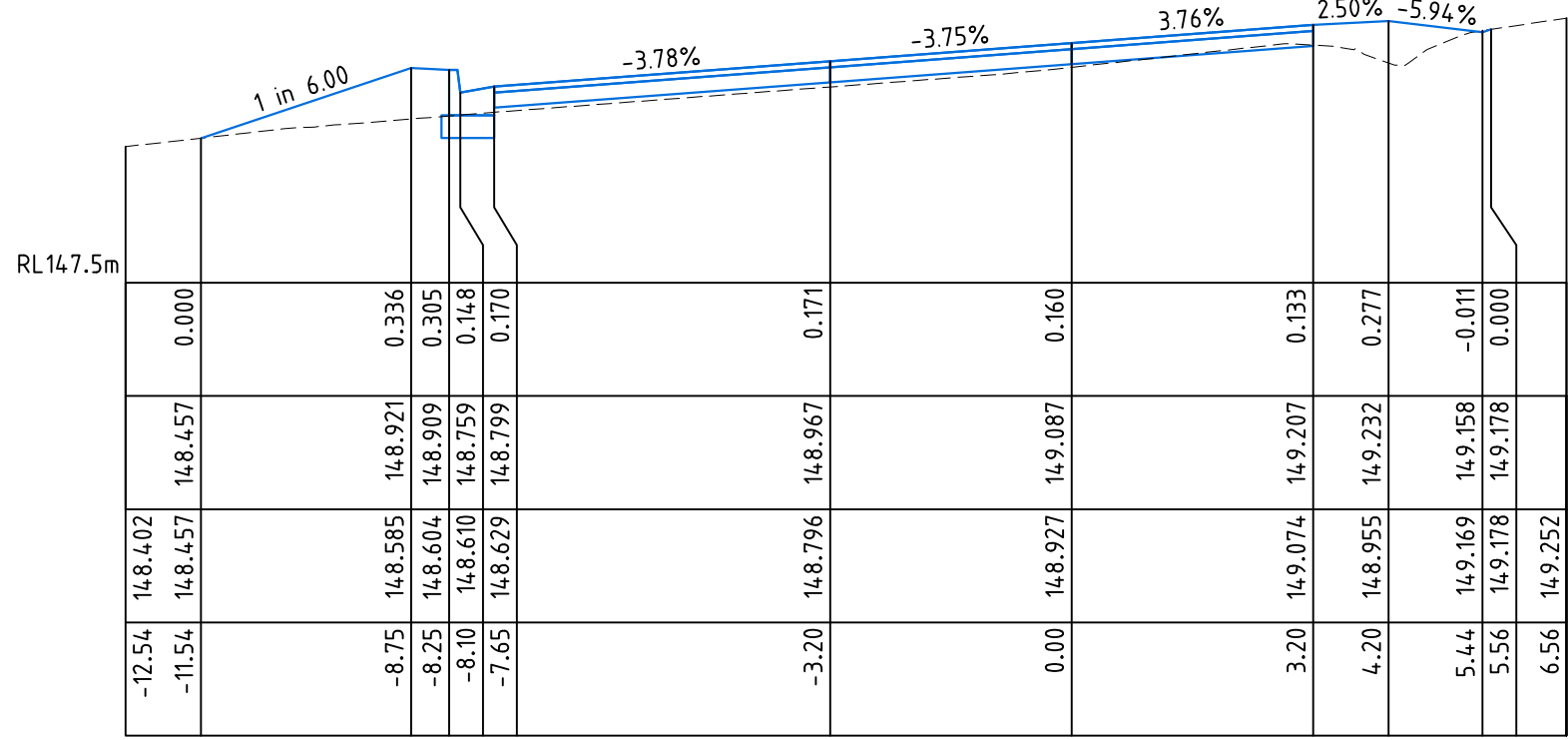

CH 60.00

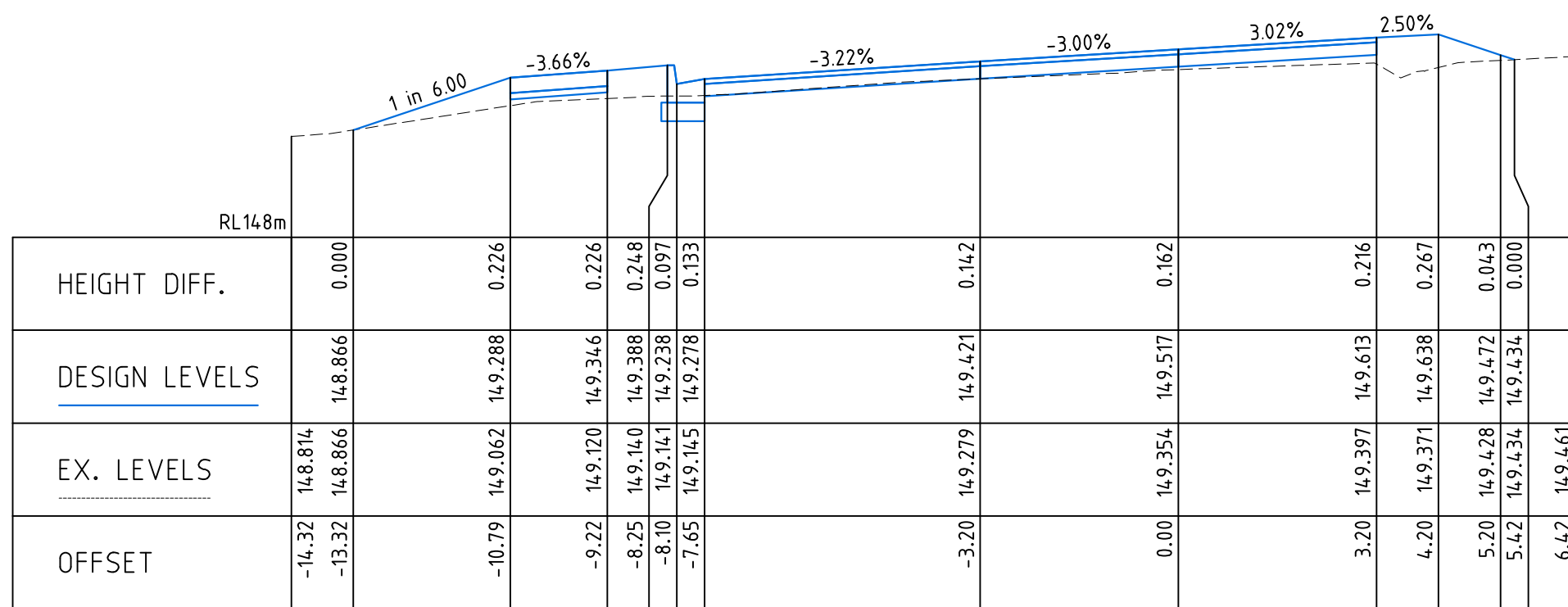

CH 40.00

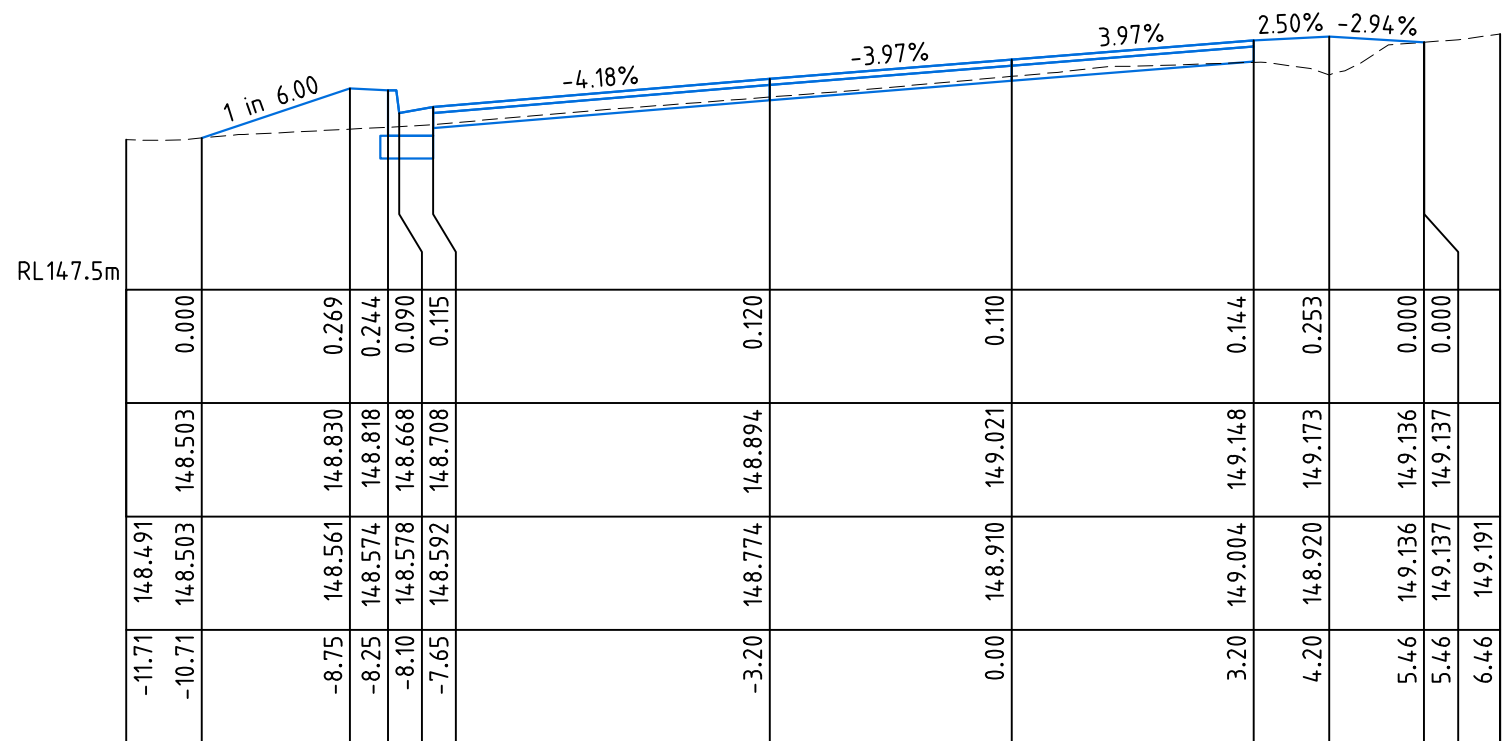

CH 55.68

WARNING
BEWARE OF UNDERGROUND SERVICES
THE LOCATION OF UNDERGROUND SERVICES SHOWN ARE APPROXIMATE ONLY AND THEIR EXACT POSITION SHOULD BE PROVIDED ON SITE. NO GUARANTEE IS GIVEN THAT ALL SERVICES ARE SHOWN. THE CONTRACTOR MUST VERIFY ALL SERVICES ON SITE PRIOR TO ANY EXCAVATION WORKS.



NOTE:
ALL NOTED "ABANDONED" SERVICES INCLUDING GAS MAINS, WATER MAINS, ETC. - THE CONTRACTOR SHALL BE RESPONSIBLE & CONFIRM THAT THESE SERVICES ARE ABANDONED, INCLUDING LIAISING WITH THE RELEVANT AUTHORITY PRIOR TO COMMENCING CONSTRUCTION.

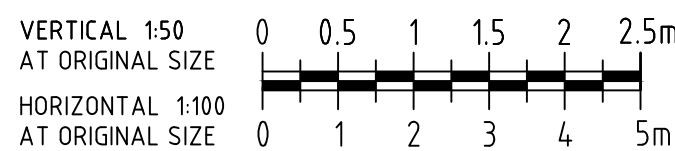

LEGEND	TOF		EX TELSTRA OPTIC FIBRE		EX HIGH PRESSURE GAS MAIN	
	EX TELSTRA CABLE & PIT	EX TELSTRA CABLE & PIT	EX TELSTRA CABLE & PIT	EX TELSTRA CABLE & PIT	EX TELSTRA CABLE & PIT	EX TELSTRA CABLE & PIT
T	EX TELSTRA CABLE & PIT	EX TELSTRA CABLE & PIT	EX TELSTRA CABLE & PIT	EX TELSTRA CABLE & PIT	EX TELSTRA CABLE & PIT	EX TELSTRA CABLE & PIT
S	EX SEWER & PIT	EX SEWER & PIT	EX SEWER & PIT	EX SEWER & PIT	EX SEWER & PIT	EX SEWER & PIT
W	EX WATER MAIN	EX WATER MAIN	EX WATER MAIN	EX WATER MAIN	EX WATER MAIN	EX WATER MAIN
ABW	EX ABANDONED WATER MAIN	EX ABANDONED WATER MAIN	EX ABANDONED WATER MAIN	EX ABANDONED WATER MAIN	EX ABANDONED WATER MAIN	EX ABANDONED WATER MAIN
G	EX GAS MAIN	EX GAS MAIN	EX GAS MAIN	EX GAS MAIN	EX GAS MAIN	EX GAS MAIN
ABG	EX ABANDONED GAS MAIN	EX ABANDONED GAS MAIN	EX ABANDONED GAS MAIN	EX ABANDONED GAS MAIN	EX ABANDONED GAS MAIN	EX ABANDONED GAS MAIN
E	EX U/G ELECTRICITY CABLE	EX U/G ELECTRICITY CABLE	EX U/G ELECTRICITY CABLE	EX U/G ELECTRICITY CABLE	EX U/G ELECTRICITY CABLE	EX U/G ELECTRICITY CABLE
E	EX O/H ELECTRICITY CABLE	EX O/H ELECTRICITY CABLE	EX O/H ELECTRICITY CABLE	EX O/H ELECTRICITY CABLE	EX O/H ELECTRICITY CABLE	EX O/H ELECTRICITY CABLE
O	EX OPTUS CABLE	EX OPTUS CABLE	EX OPTUS CABLE	EX OPTUS CABLE	EX OPTUS CABLE	EX OPTUS CABLE
HD	EX HOUSE DRAIN	EX HOUSE DRAIN	EX HOUSE DRAIN	EX HOUSE DRAIN	EX HOUSE DRAIN	EX HOUSE DRAIN
STOP VALVE	STOP VALVE	STOP VALVE	STOP VALVE	STOP VALVE	STOP VALVE	STOP VALVE
FIRE PLUG	FIRE PLUG	FIRE PLUG	FIRE PLUG	FIRE PLUG	FIRE PLUG	FIRE PLUG
FIRE HYDRANT (ABOVE GROUND)	FIRE HYDRANT (ABOVE GROUND)	FIRE HYDRANT (ABOVE GROUND)	FIRE HYDRANT (ABOVE GROUND)	FIRE HYDRANT (ABOVE GROUND)	FIRE HYDRANT (ABOVE GROUND)	FIRE HYDRANT (ABOVE GROUND)
FIRE HYDRANT (GROUND LEVEL)	FIRE HYDRANT (GROUND LEVEL)	FIRE HYDRANT (GROUND LEVEL)	FIRE HYDRANT (GROUND LEVEL)	FIRE HYDRANT (GROUND LEVEL)	FIRE HYDRANT (GROUND LEVEL)	FIRE HYDRANT (GROUND LEVEL)
ELECTRICITY SUPPLY POLE	ELECTRICITY SUPPLY POLE	ELECTRICITY SUPPLY POLE	ELECTRICITY SUPPLY POLE	ELECTRICITY SUPPLY POLE	ELECTRICITY SUPPLY POLE	ELECTRICITY SUPPLY POLE
E.S.P. WITH LIGHT	E.S.P. WITH LIGHT	E.S.P. WITH LIGHT	E.S.P. WITH LIGHT	E.S.P. WITH LIGHT	E.S.P. WITH LIGHT	E.S.P. WITH LIGHT
LIGHT POLE ONLY	LIGHT POLE ONLY	LIGHT POLE ONLY	LIGHT POLE ONLY	LIGHT POLE ONLY	LIGHT POLE ONLY	LIGHT POLE ONLY
TELECOM PILLAR	TELECOM PILLAR	TELECOM PILLAR	TELECOM PILLAR	TELECOM PILLAR	TELECOM PILLAR	TELECOM PILLAR
EXISTING POST	EXISTING POST	EXISTING POST	EXISTING POST	EXISTING POST	EXISTING POST	EXISTING POST
TRAFFIC SIGNAL PIT, CABLE, PEDESTAL	TRAFFIC SIGNAL PIT, CABLE, PEDESTAL	TRAFFIC SIGNAL PIT, CABLE, PEDESTAL	TRAFFIC SIGNAL PIT, CABLE, PEDESTAL	TRAFFIC SIGNAL PIT, CABLE, PEDESTAL	TRAFFIC SIGNAL PIT, CABLE, PEDESTAL	TRAFFIC SIGNAL PIT, CABLE, PEDESTAL
TRAFFIC SIGNAL POLE	TRAFFIC SIGNAL POLE	TRAFFIC SIGNAL POLE	TRAFFIC SIGNAL POLE	TRAFFIC SIGNAL POLE	TRAFFIC SIGNAL POLE	TRAFFIC SIGNAL POLE
UNCLASSIFIED PIT	UNCLASSIFIED PIT	UNCLASSIFIED PIT	UNCLASSIFIED PIT	UNCLASSIFIED PIT	UNCLASSIFIED PIT	UNCLASSIFIED PIT
EX. SIGN	EX. SIGN	EX. SIGN	EX. SIGN	EX. SIGN	EX. SIGN	EX. SIGN
EXISTING BOLLARD	EXISTING BOLLARD	EXISTING BOLLARD	EXISTING BOLLARD	EXISTING BOLLARD	EXISTING BOLLARD	EXISTING BOLLARD
RUBBISH BIN	RUBBISH BIN	RUBBISH BIN	RUBBISH BIN	RUBBISH BIN	RUBBISH BIN	RUBBISH BIN
EX DRAIN & PIT	EX DRAIN & PIT	EX DRAIN & PIT	EX DRAIN & PIT	EX DRAIN & PIT	EX DRAIN & PIT	EX DRAIN & PIT
PROPOSED DRAIN & PIT	PROPOSED DRAIN & PIT	PROPOSED DRAIN & PIT	PROPOSED DRAIN & PIT	PROPOSED DRAIN & PIT	PROPOSED DRAIN & PIT	PROPOSED DRAIN & PIT
PSM	PSM	PSM	PSM	PSM	PSM	PSM
STN/TBM	STN/TBM	STN/TBM	STN/TBM	STN/TBM	STN/TBM	STN/TBM
NO.	AMENDMENTS					DATE

CRE
CRE CONSULTING ENGINEERS PTY LTD
Civil • Municipal • Drainage • Project Management
Level 1/116 Puckle Street, Moonee Ponds, Vic, 3039
Phone: 0417 318 556
Email: admin@creconsulting.com.au

DESIGNED : CRE
DATE : 19/02/25
CHECKED :
DATE :
SURVEYED : SURFCEAST
DATE : 08/24
SURVEY DATUM : A.H.D. / MGA2020
SCALES : AS SHOWN @A1



ANSLIE PARK, CROYDON
CAR PARK UPGRADE
REFERENCE LINE - CROSS SECTIONS

CRE REF: 3193--(REV-P7).DWG
CRE REV. NO.: P7
AMEND. NO.: -
DWG. NO. **3193**
SHEET: 6 OF 13
SIZE: A1

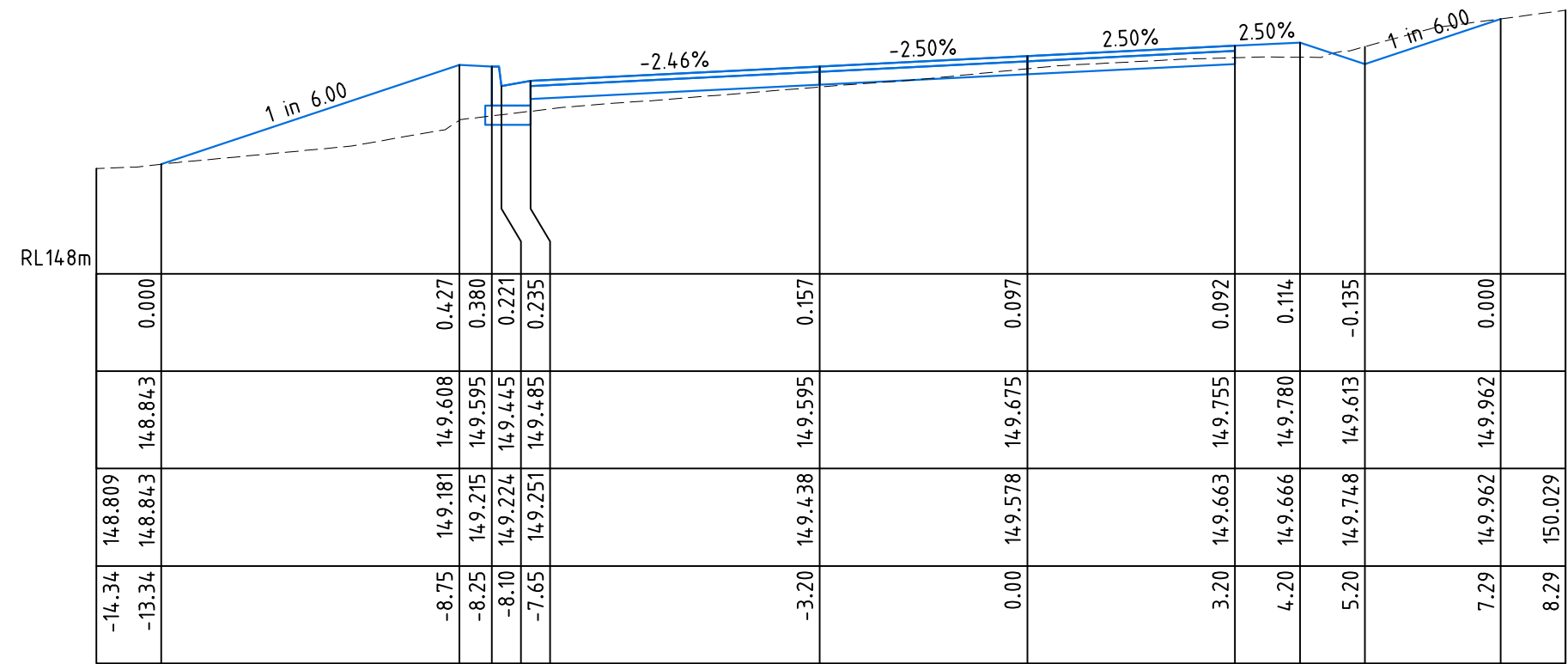

CH 78.06

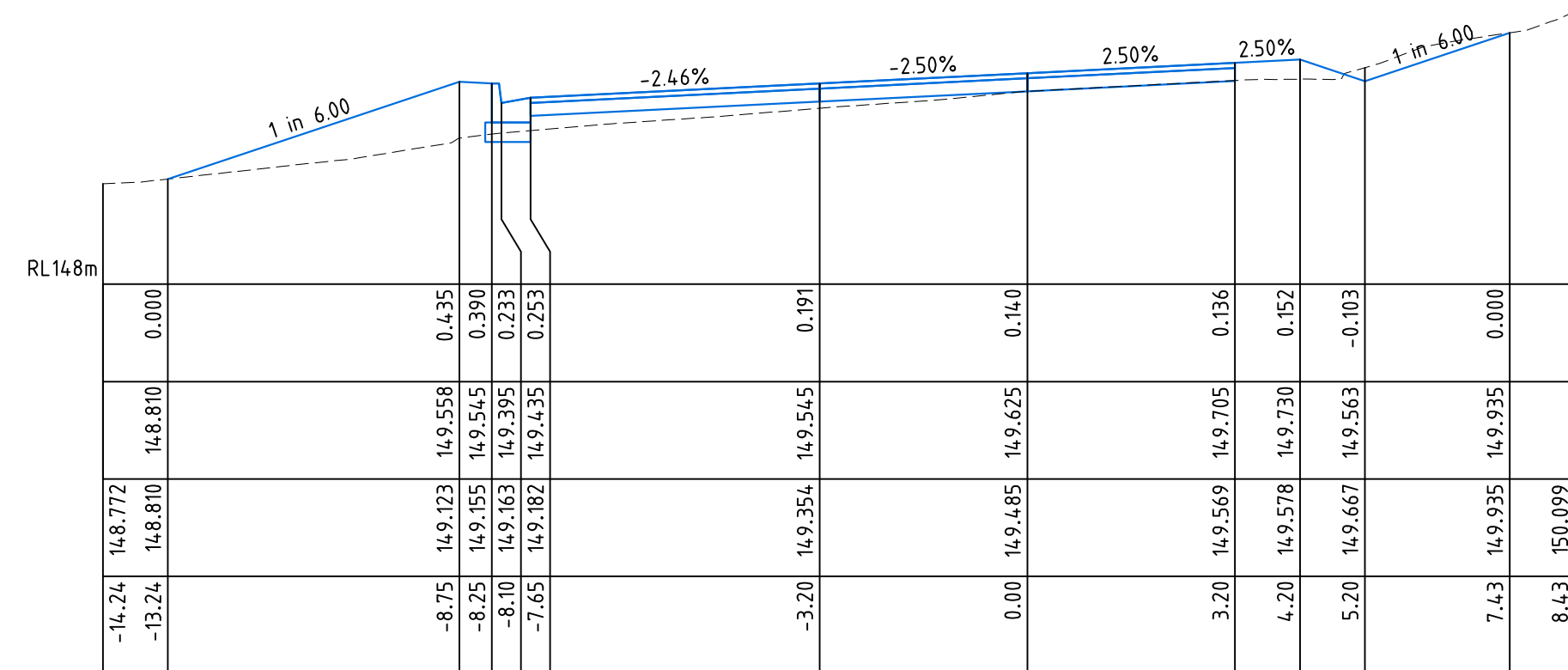

CH 76.06

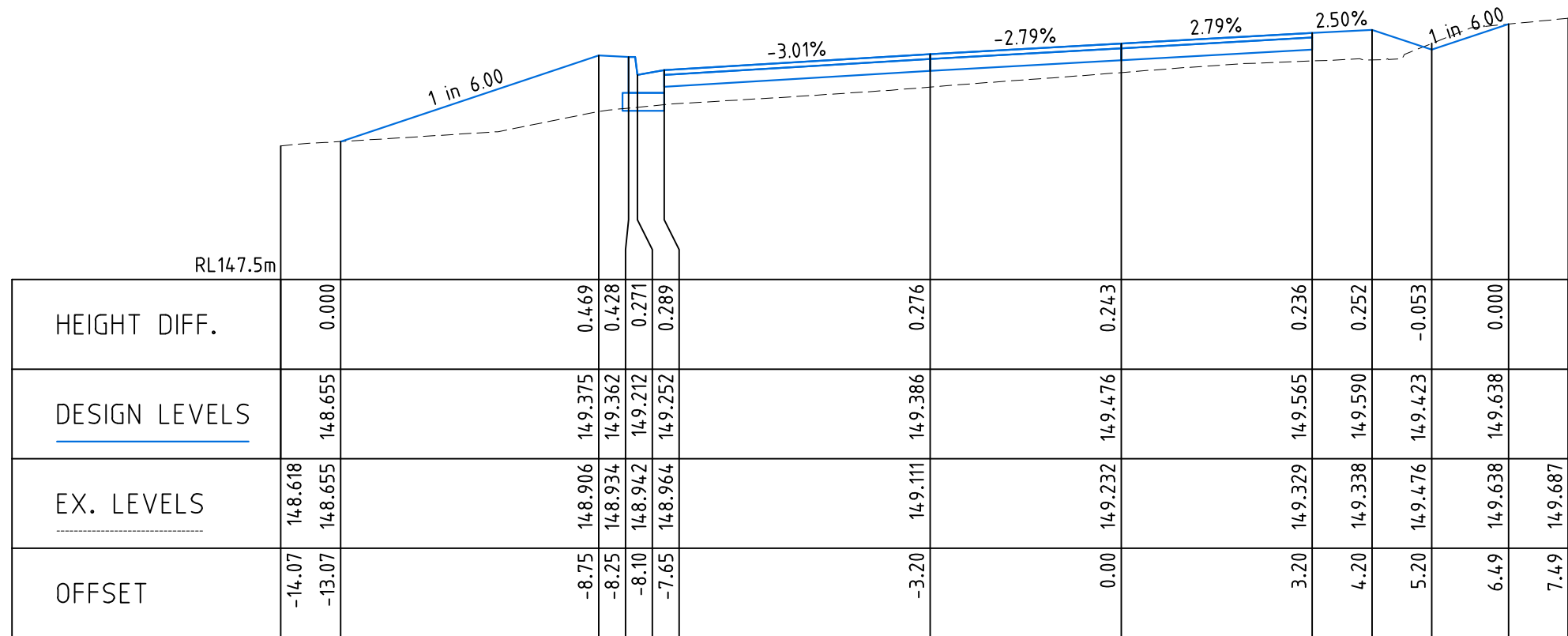

CH 70.00

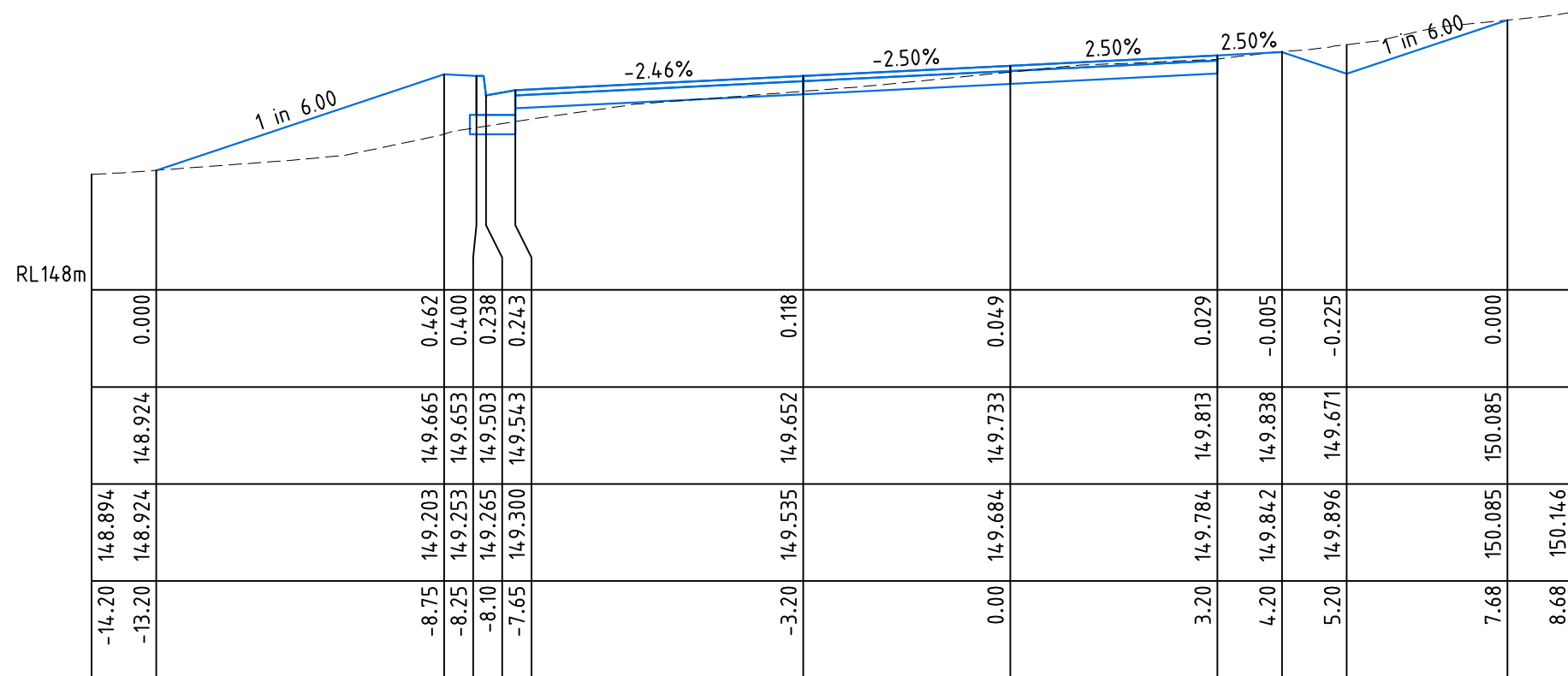

CH 80.36

WARNING
BEWARE OF UNDERGROUND SERVICES
THE LOCATION OF UNDERGROUND SERVICES SHOWN ARE APPROXIMATE ONLY AND THEIR EXACT POSITION SHOULD BE PROVIDED ON SITE. NO GUARANTEE IS GIVEN THAT ALL SERVICES ARE SHOWN. THE CONTRACTOR MUST IDENTIFY ALL SERVICES ON SITE PRIOR TO ANY EXCAVATION WORKS.



NOTE:
ALL NOTED "ABANDONED" SERVICES INCLUDING GAS MAINS, WATER MAINS, ETC., THE CONTRACTOR SHALL BE RESPONSIBLE & CONFIRM THAT THESE SERVICES ARE ABANDONED, INCLUDING LIAISING WITH THE RELEVANT AUTHORITY PRIOR TO COMMENCING CONSTRUCTION.

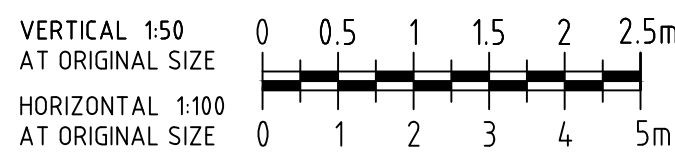

LEGEND	TOF		HPG	
	EX TELSTRA CABLE & PIT	EX HIGH PRESSURE GAS MAIN		
T	EX TELSTRA CABLE & PIT			
S	EX SOWER & PIT			
W	EX WATER MAIN			
ABW	EX ABANDONED WATER MAIN			
G	EX GAS MAIN			
ABG	EX ABANDONED GAS MAIN			
E	EX U/G ELECTRICITY CABLE			
EA	EX O/H ELECTRICITY CABLE			
O	EX OPTUS CABLE			
HD	EX HOUSE DRAIN			
STOP VALVE				
FIRE PLUG				
FIRE HYDRANT (ABOVE GROUND)				
FIRE HYDRANT (GROUND LEVEL)				
ELECTRICITY SUPPLY POLE				
E.S.P. WITH LIGHT				
LIGHT POLE ONLY				
TELECOM PILLAR				
EXISTING POST				
TRAFFIC SIGNAL PIT, CABLE, PEDESTAL				
TRAFFIC SIGNAL POLE				
UNCLASSIFIED PIT				
EX. SIGN				
EXISTING BOLLARD				
RUBBISH BIN				
PSM				
STN/TBM				
EX DRAIN & PIT				
PROPOSED DRAIN & PIT				
EX DRAIN & PIT				
PROPOSED DRAIN & PIT				
NO.				
AMENDMENTS				
DATE				

CRE
CRE CONSULTING ENGINEERS PTY LTD
Civil • Municipal • Drainage • Project Management

Level 1/116 Puckle Street, Moonee Ponds, Vic, 3039
Phone: 0417 318 556
Email: admin@creconsulting.com.au

DESIGNED : CRE	DATE :19/02/25
CHECKED :	
DATE :	
SURVEYED : SURFCOAST	DATE : 08/24
SURVEY DATUM : A.H.D. / MGA2020	
SCALES : AS SHOWN	@A1



ANSLIE PARK, CROYDON
CAR PARK UPGRADE
REFERENCE LINE – CROSS SECTIONS

CRE REF: 3193--(REV-P7).DWG
CRE REV. NO.: P7
AMEND. NO.: -
DWG.NO. 3193
SHEET: 7 OF 13
SIZE: A1

NOTE:
ALL NOTED "ABANDONED" SERVICES INCLUDING GAS MAINS, WATER MAINS, ETC. - THE CONTRACTOR SHALL BE RESPONSIBLE & CONFIRM THAT THESE SERVICES ARE ABANDONED, INCLUDING LIAISING WITH THE RELEVANT AUTHORITY PRIOR TO COMMENCING CONSTRUCTION.

SETOUT DETAILS ALONG LEFT EDGE OF BITUMEN		
CHAINAGE	EASTING	NORTHING
5. 35	347244. 999	5815298. 762
6. 49	347244. 234	5815299. 603
15. 90	347236. 373	5815304. 560
17. 53	347234. 809	5815305. 032
25. 30	347227. 167	5815306. 309
31. 25	347221. 220	5815306. 536
33. 50	347219. 717	5815305. 167
36. 81	347219. 534	5815301. 864
37. 05	347219. 373	5815301. 723
56. 52	347201. 405	5815308. 500
80. 88	347192. 587	5815329. 984
95. 23	347194. 640	5815344. 185
95. 47	347194. 810	5815344. 312
98. 77	347198. 076	5815343. 840
100. 29	347199. 423	5815344. 378
100. 86	347199. 933	5815344. 582
103. 33	347202. 376	5815344. 229

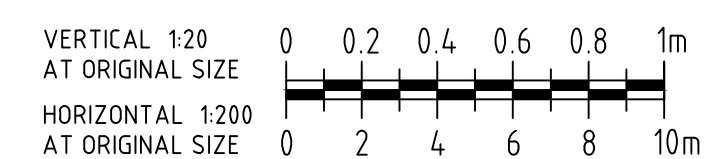
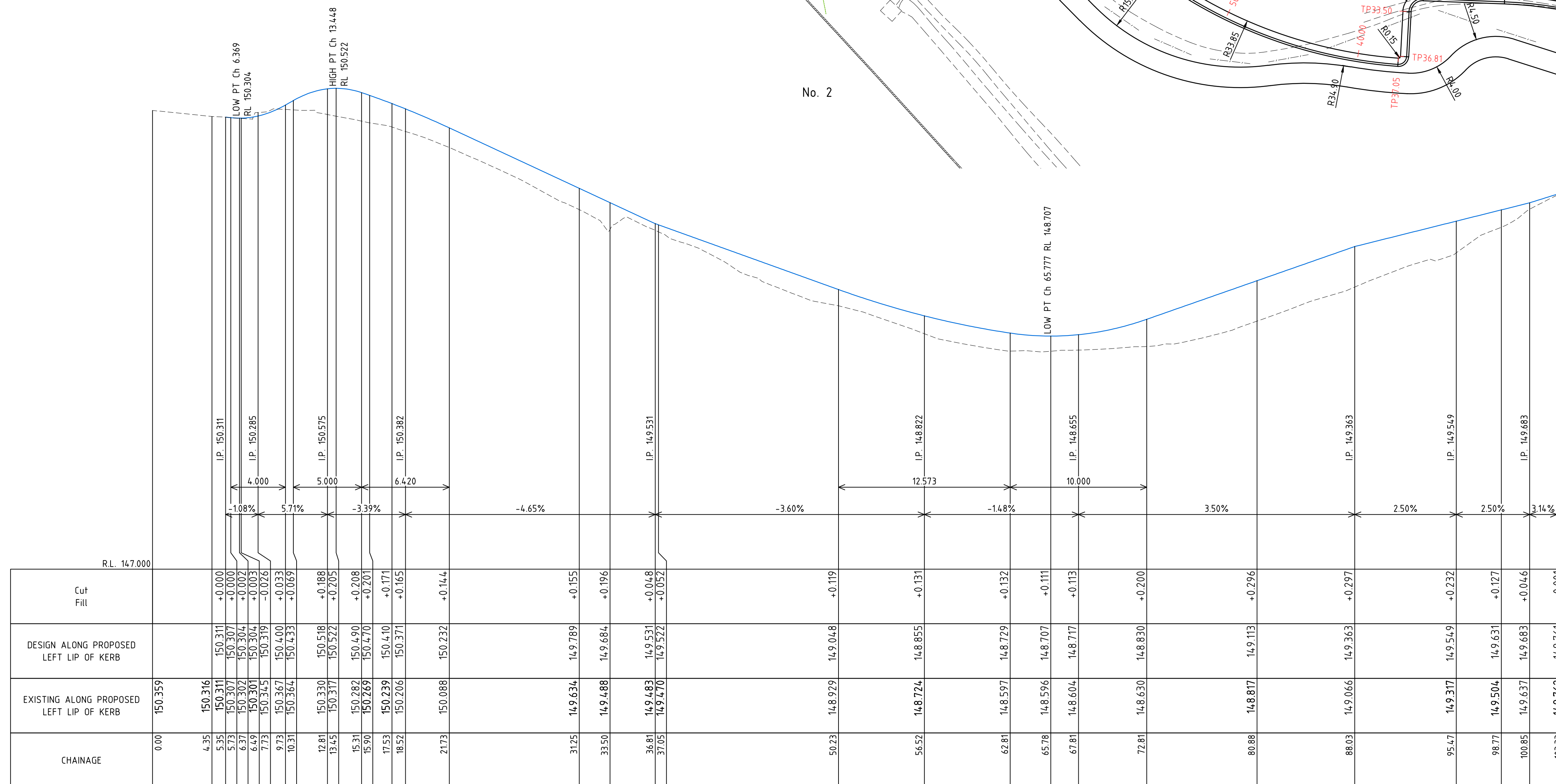
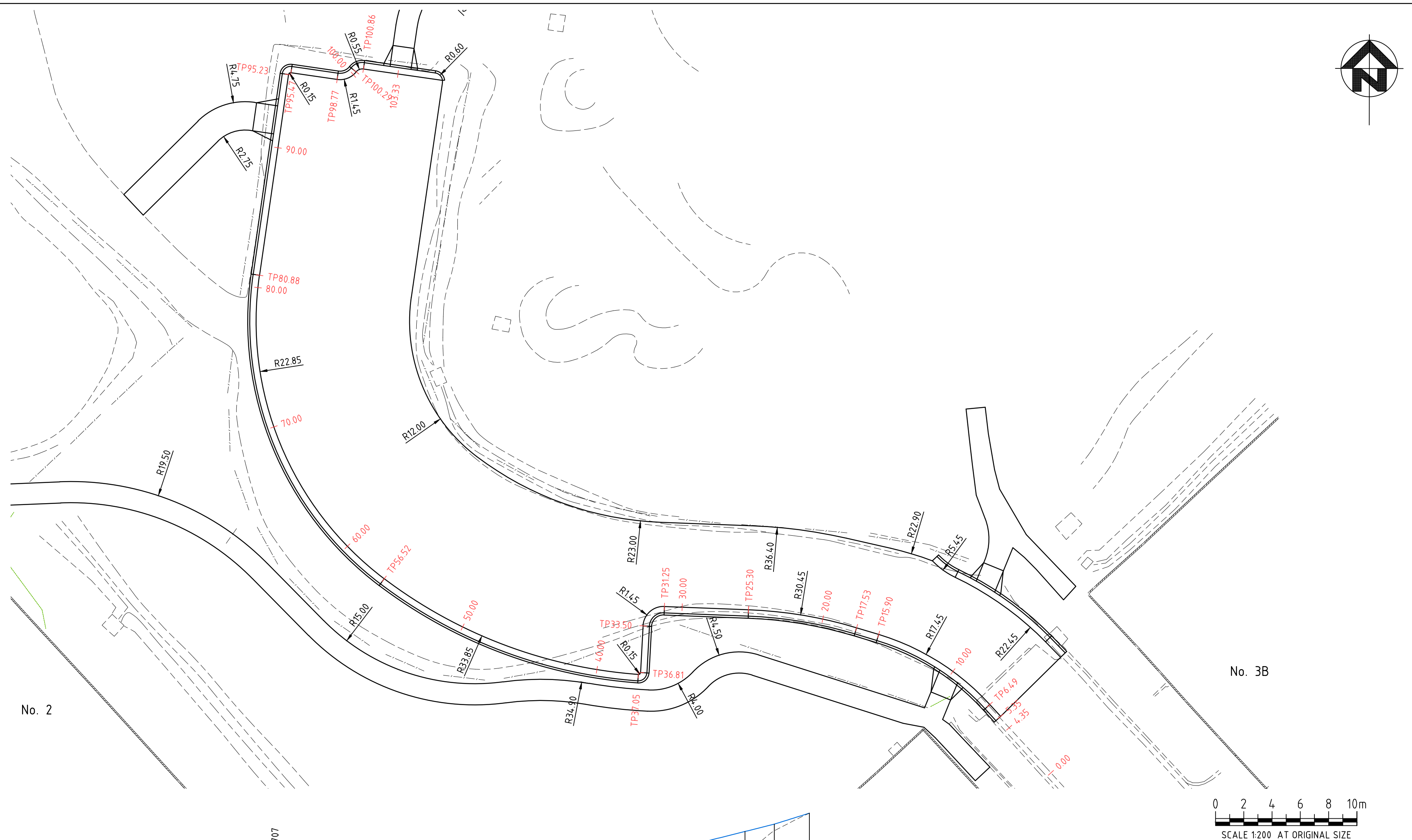

LEGEND <div style="display: flex; justify-content: space-between;"> <div style="width: 45%;"> <p>— TOP — EX TELSTRA OPTIC FIBRE</p> <p>— T — EX TELSTRA CABLE & PIT</p> <p>— S — EX SEWER & PIT</p> <p>— W — EX WATER MAIN</p> <p>— ABW — EX ABANDONED WATER MAIN</p> <p>— G — EX GAS MAIN</p> <p>— ABG — EX ABANDONED GAS MAIN</p> <p>— E — EX U/G ELECTRICITY CABLE</p> <p>— EA — EX O/H ELECTRICITY CABLE</p> <p>— O — EX OPTUS CABLE</p> <p>— HD — HOUSE DRAIN</p> </div> <div style="width: 45%;"> <p>— HPC — EX HIGH PRESSURE GAS MAIN</p> <p>◆ STOP VALVE</p> <p>◆ FIRE PLUG</p> <p>● FIRE HYDRANT (ABOVE GROUND)</p> <p>● FIRE HYDRANT (GROUND LEVEL)</p> <p>⊕ ELECTRICITY SUPPLY POLE</p> <p>⊕ E.S.P. WITH LIGHT</p> <p>⊕ LIGHT POLE ONLY</p> <p>⊕ TELECOM PILLAR</p> <p>⊕ EXISTING POST</p> </div> </div> <div style="display: flex; justify-content: space-between;"> <div style="width: 45%;"> <p>— TS — TRAFFIC SIGNAL PIT, CABLE, PEDESTAL</p> <p>⊕ TRAFFIC SIGNAL POLE</p> <p>— FENCE — FENCE</p> <p>⊕ EX. SIGN</p> <p>⊕ EXISTING BOLLARD</p> <p>⊕ RUBBISH BIN</p> <p>⊕ PSM</p> <p>⊕ STN/TBM</p> <p>⊕ UNCLASSIFIED PIT</p> <p>⊕ TREE</p> <p>⊕ LIMIT OF WORKS</p> <p>⊕ EX DRAIN & PIT</p> <p>⊕ PROPOSED DRAIN & PIT</p> </div> <div style="width: 45%;"> <p>NO.</p> <p>AMENDMENTS</p> <p>DATE</p> </div> </div>	<div style="text-align: center;"> CRE CONSULTING ENGINEERS PTY LTD Civil • Municipal • Drainage • Project Management </div> <p>Level 1/116 Puckle Street, Moonee Ponds, Vic, 3039 Phone: 0417 318 556 Email: admin@creconsulting.com.au</p>	DESIGNED : CRE DATE : 19/02/25	CLIENT:	<div style="text-align: center;"> ANSLIE PARK, CROYDON CAR PARK UPGRADE LEFT EDGE OF BITUMEN LONGITUDINAL SECTION </div>	CRE REF: 3193--(REV-P7).DWG CRE REV. NO.: P7 AMEND. NO.: - DWG. NO. 3193 SHEET: 8 OF 13 SIZE: A1
		CHECKED : DATE :	SURVEYED : SURFCOAST DATE : 08/24		
		SURVEY DATUM : A.H.D. / MGA2020	SCALES : AS SHOWN @A1		

NOTE:
ALL NOTED "ABANDONED" SERVICES INCLUDING GAS MAINS, WATER MAINS, ETC. - THE CONTRACTOR SHALL BE RESPONSIBLE & CONFIRM THAT THESE SERVICES ARE ABANDONED, INCLUDING LIAISING WITH THE RELEVANT AUTHORITY PRIOR TO COMMENCING CONSTRUCTION.

Technical drawing No. 2 shows a plan view of a road layout. The drawing includes several curved segments defined by radii (R) and lengths (L). Key features include:

- Curved Segments:** R0.75, R0.95, R1.45, R2.85, R12.00, R16.50, R23.00, R36.40, R30.45, R14.5, R34.90, R31.85, R15.00, R17.15, R22.90, R13.45.
- Points:** TP63.13, TP60.34, TP50.00, TP36.30, TP30.00, TP23.09, TP16.82, TP19.89, TP14.81, TP6.92, TP4.38, TP3.27, TP0.88.
- Distances:** 81.81, 80.00, 78.63, 78.08, 70.00, 60.00, 40.00, 30.00, 20.00, 10.00, 4.38, 3.27, 0.88.

The drawing also shows dashed lines representing boundaries or other roads, and solid lines representing the main road alignment.

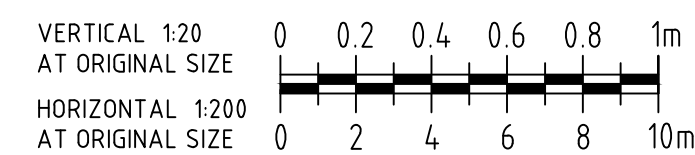

LEGEND <div style="display: flex; justify-content: space-between;"> <div style="width: 45%;"> <p>— T — EX TELSTRA OPTIC FIBRE</p> <p>— S — EX TELSTRA CABLE & PIT</p> <p>— W — EX SEWER & PIT</p> <p>— ABW — EX WATER MAIN</p> <p>— G — EX ABANDONED WATER MAIN</p> <p>— G — EX GAS MAIN</p> <p>— ABG — EX ABANDONED GAS MAIN</p> <p>— E — EX U/G ELECTRICITY CABLE</p> <p>— E — EX O/H ELECTRICITY CABLE</p> <p>— O — EX OPTUS CABLE</p> <p>--- HD --- EX HD</p> <p>--- HD --- EX HD</p> </div> <div style="width: 45%;"> <p>◆ STOP VALVE</p> <p>◆ FIRE PLUG</p> <p>● FIRE HYDRANT (ABOVE GROUND)</p> <p>● FIRE HYDRANT (GROUND LEVEL)</p> <p>⊕ ELECTRICITY SUPPLY POLE</p> <p>⊕ E.S.P. WITH LIGHT</p> <p>⊕ LIGHT POLE ONLY</p> <p>⊗ TELECOM PILLAR</p> <p>⊗ EXISTING POST</p> </div> </div> <div style="display: flex; justify-content: space-between;"> <div style="width: 45%;"> <p>— TS — TRAFFIC SIGNAL PIT, CABLE, PEDESTAL</p> <p>⊕ TRAFFIC SIGNAL POLE</p> <p>— F — FENCE</p> <p>⊕ EX. SIGN</p> <p>⊗ EXISTING BOLLARD</p> <p>⊗ RUBBISH BIN</p> <p>⊗ PSM</p> <p>⊗ STW/TBM</p> <p>⊗ EX DRAIN & PIT</p> <p>⊗ PROPOSED DRAIN & PIT</p> <p>⊗ TREE</p> <p>⊗ LIMIT OF WORKS</p> </div> <div style="width: 45%;"> <p>NO.</p> <p>AMENDMENTS</p> <p>DATE</p> </div> </div>	<div style="display: flex; align-items: center;"> <div> <p>CRE CONSULTING ENGINEERS PTY LTD</p> <p>Civil • Municipal • Drainage • Project Management</p> <p>Level 1/116 Puckle Street, Moonee Ponds, Vic, 3039</p> <p>Phone: 0417 318 556</p> <p>Email: admin@creconsulting.com.au</p> </div> </div>	<table border="1" style="width: 100%; border-collapse: collapse;"> <tr> <td colspan="2">DESIGNED : CRE</td> <td colspan="2">DATE : 19/02/25</td> <td rowspan="3"> <div style="display: flex; align-items: center; justify-content: center;"> <div> <p>MAROONDAH</p> <p>City Council</p> </div> </div> </td> </tr> <tr> <td colspan="2">CHECKED : DATE :</td> <td colspan="2"></td> </tr> <tr> <td colspan="2">SURVEYED : SURFCOAST</td> <td colspan="2">DATE : 08/24</td> </tr> <tr> <td colspan="4">SURVEY DATUM : A.H.D. / MGA2020</td> <td></td> </tr> <tr> <td colspan="2">SCALES : AS SHOWN</td> <td colspan="2">©A1</td> <td></td> </tr> </table>	DESIGNED : CRE		DATE : 19/02/25		<div style="display: flex; align-items: center; justify-content: center;"> <div> <p>MAROONDAH</p> <p>City Council</p> </div> </div>	CHECKED : DATE :				SURVEYED : SURFCOAST		DATE : 08/24		SURVEY DATUM : A.H.D. / MGA2020					SCALES : AS SHOWN		©A1			<div style="text-align: center;"> <p>ANSLIE PARK, CROYDON</p> <p>CAR PARK UPGRADE</p> <p>RIGHT EDGE OF BITUMEN LONGITUDINAL SECTION</p> </div>	<table border="1" style="width: 100%; border-collapse: collapse;"> <tr> <td colspan="2">CRE REF: 3193--(REV-P7).DWG</td> </tr> <tr> <td colspan="2">CRE REV. NO.: P7</td> </tr> <tr> <td colspan="2">AMEND. NO.: -</td> </tr> <tr> <td colspan="2">DWG. NO. 3193</td> </tr> <tr> <td>SHEET: 9 OF 13</td> <td>SIZE: A1</td> </tr> </table>	CRE REF: 3193--(REV-P7).DWG		CRE REV. NO.: P7		AMEND. NO.: -		DWG. NO. 3193		SHEET: 9 OF 13	SIZE: A1
	DESIGNED : CRE		DATE : 19/02/25		<div style="display: flex; align-items: center; justify-content: center;"> <div> <p>MAROONDAH</p> <p>City Council</p> </div> </div>																																
	CHECKED : DATE :																																				
	SURVEYED : SURFCOAST		DATE : 08/24																																		
	SURVEY DATUM : A.H.D. / MGA2020																																				
SCALES : AS SHOWN		©A1																																			
CRE REF: 3193--(REV-P7).DWG																																					
CRE REV. NO.: P7																																					
AMEND. NO.: -																																					
DWG. NO. 3193																																					
SHEET: 9 OF 13	SIZE: A1																																				

NOTE:
ALL NOTED "ABANDONED" SERVICES INCLUDING GAS MAINS, WATER MAINS, ETC. - THE CONTRACTOR SHALL BE RESPONSIBLE & CONFIRM THAT THESE SERVICES ARE ABANDONED, INCLUDING LIAISING WITH THE RELEVANT AUTHORITY PRIOR TO COMMENCING CONSTRUCTION.

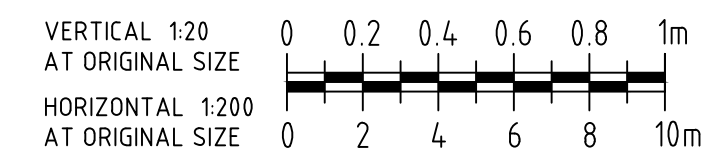
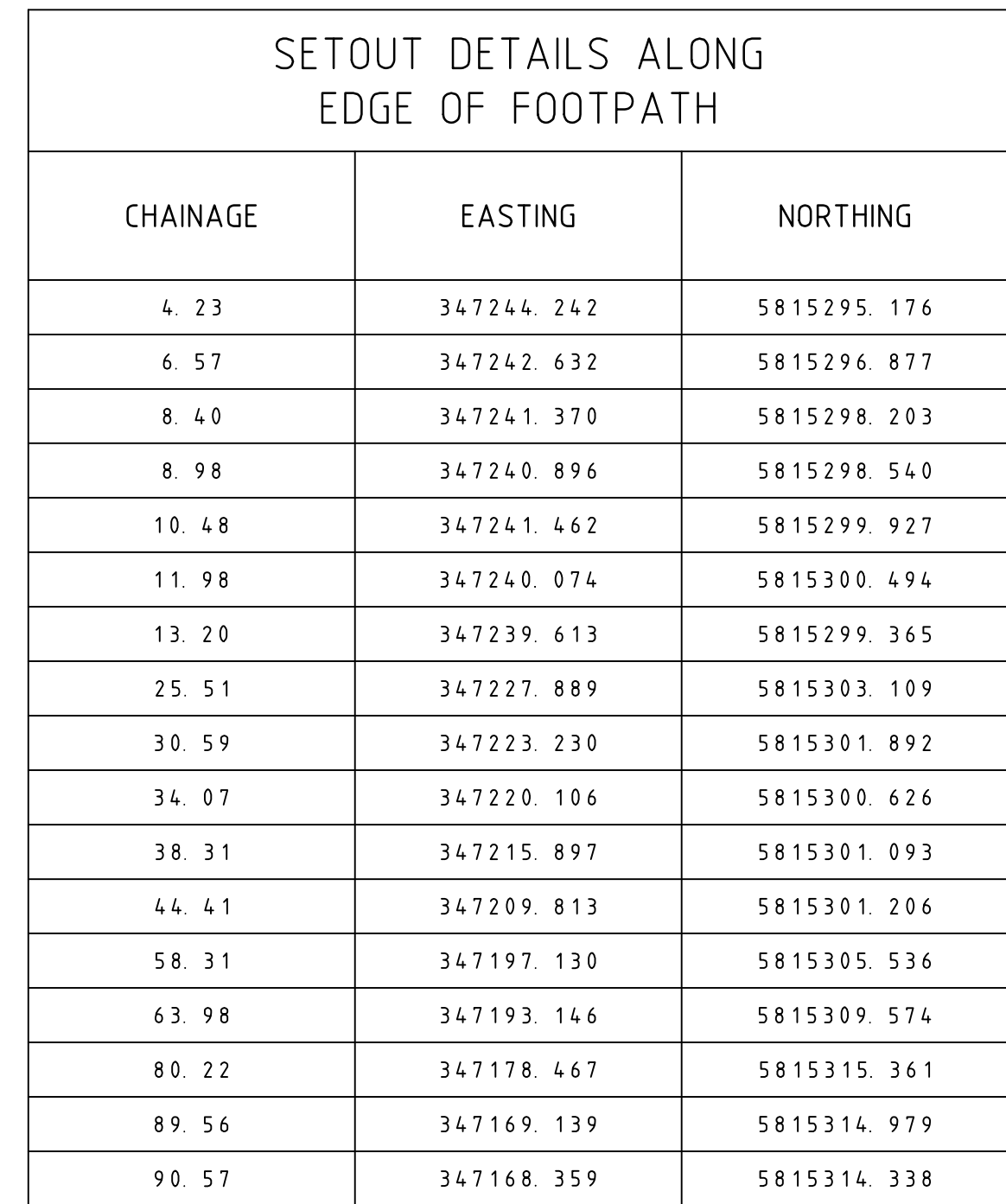
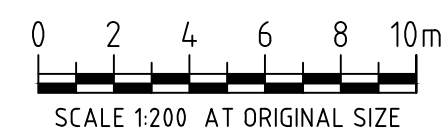
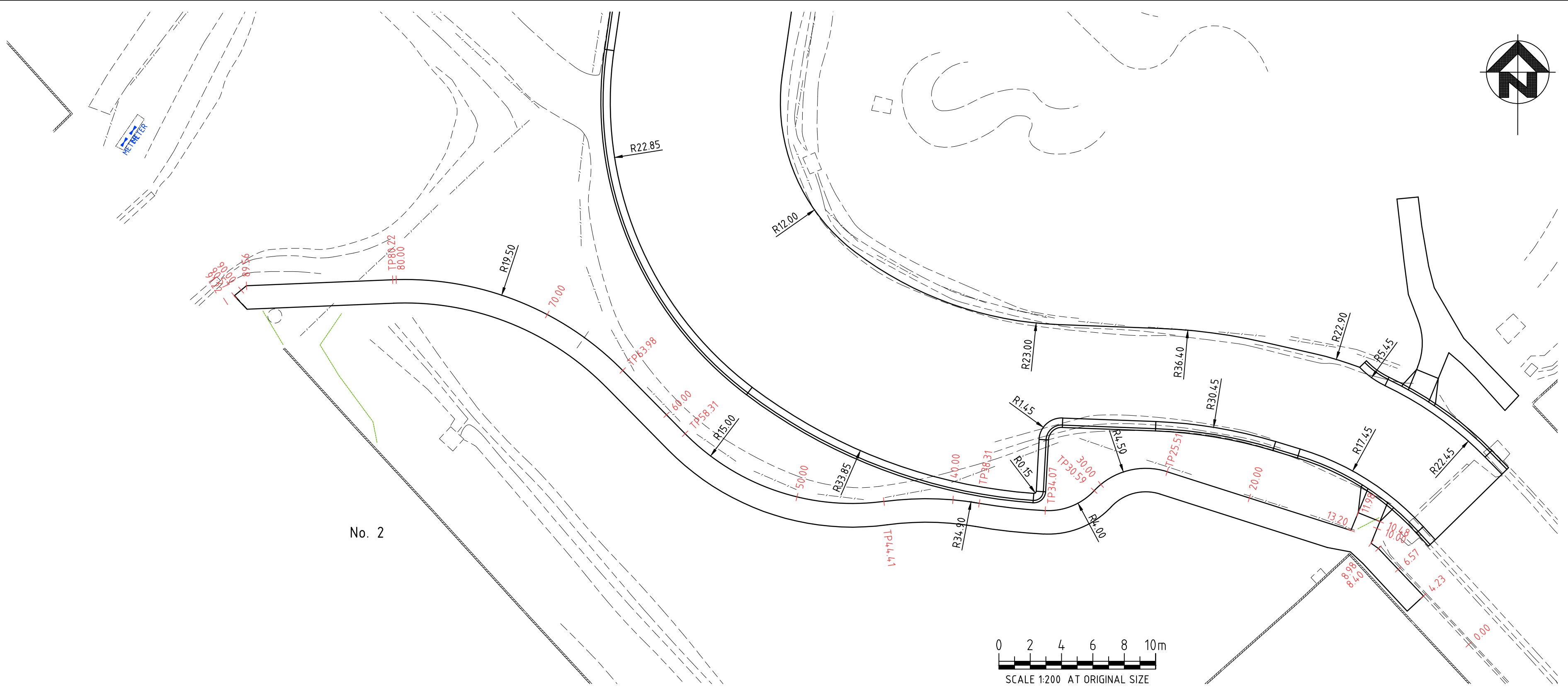
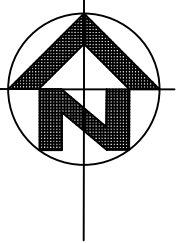

LEGEND	— T — EX TELSTRA OPTIC FIBRE	— HPG — EX HIGH PRESSURE GAS MAIN	— TS — TRAFFIC SIGNAL PIT, CABLE, PEDESTAL			<div><div>CRE CONSULTING ENGINEERS PTY LTD</div><div>Civil • Municipal • Drainage • Project Management</div></div> <div>Level 1/116 Puckle Street, Moonee Ponds, Vic, 3039 Phone: 0417 318 556 Email: admin@creconsulting.com.au</div>	DESIGNED : CRE	DATE : 19/02/25	CLIENT: <div></div>	ANSLIE PARK, CROYDON CAR PARK UPGRADE FOOTPATH – LONGITUDINAL SECTION		CRE REF: 3193–(REV–P7).DWG	
	— S — EX TELSTRA CABLE & PIT	STOP VALVE			CHECKED : DATE :			CRE REV. NO.: P7					
	— S — EX SEWER & PIT	FIRE PLUG	— TS — TRAFFIC SIGNAL PIT, CABLE, PEDESTAL					AMEND. NO.: –					
	— W — EX WATER MAIN	FIRE HYDRANT (ABOVE GROUND)	— TS — TRAFFIC SIGNAL POLE	UNCLASSIFIED PIT				DWG. NO. 3193					
	— ABW — EX ABANDONED WATER MAIN	FIRE HYDRANT (GROUND LEVEL)	— TS — FENCE	TREE				SHEET: 10 OF 13					
	— G — EX GAS MAIN	ELECTRICITY SUPPLY POLE	— TS — EX. SIGN	LIMIT OF WORKS				SIZE: A1					
	— ABG — EX ABANDONED GAS MAIN	E.S.P. WITH LIGHT	— TS — EXISTING BOLLARD										
	— E — EX U/G ELECTRICITY CABLE	LIGHT POLE ONLY	— TS — EX DRAIN & PIT										
	— E — EX O/H ELECTRICITY CABLE	TELECOM PILLAR	— TS — RUBBISH BIN										
	— O — EX OPTUS CABLE	EXISTING POST	— TS — PROPOSED DRAIN & PIT										
— HD — EX HOUSE DRAIN													
</													

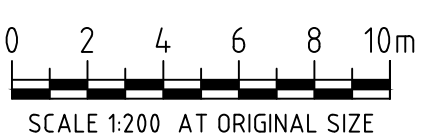
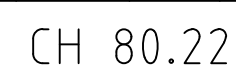
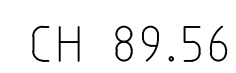
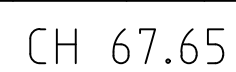
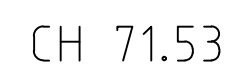

No. 2

<p>ANSLIE PARK, CROYDON</p> <p>CAR PARK UPGRADE</p> <p>FOOTPATH – CROSS SECTIONS</p>	CRE REF: 3193–(REV–P7).DWG	
	CRE REV. NO.: P7	
	AMEND. NO.: –	
	DWG.NO. 3193	
	SHEET: 11 OF 13	SIZE: A1

DRAINAGE PIT SCHEDULE

PIT NO.	TYPE		INTERNAL WIDTH	INTERNAL LENGTH	OUTLET DIAMETER	OUTLET INVERT RL	INLET DIAMETER	INLET INVERT RL	PIT DEPTH	FSL	EASTING	NORTHING	REMARKS	PIT NO.
	EXISTING	PROPOSED	(mm)	(mm)	(mm)	(m)	(mm)	(m)	(m)	(m)	(m)	(m)		
1	JP	V-NOTCH	900	600	EX 375	146.740	300	146.940	0.877	147.617	347183.040	5815305.986	CONSTRUCT NEW TABLE DRAIN INLET PIT (V-NOTCH) AS PER STD. DWG. MCC-212 WITH CLASS B, LIGHTWEIGHT LOCKABLE LID. PIT TO BE CONNECTED TO EXISTING JUNCTION PIT VIA A 450x450 BOX OPENING. EXISTING SWALE TO BE SHAPED TO ENSURE WATER FLOWS INTO PIT. ALL AS DIRECTED BY COUNCIL'S SUPERINTENDENT.	1
2		JP	900	1900	300	147.072	750	147.072	1.461	148.533	347192.756	5815313.260	CONSTRUCT NEW JUNCTION PIT AS PER DETAIL ON THIS SHEET & AS PER STD. DWG. MCC-201 WITH COUNCIL APPROVED CLASS C, LIGHTWEIGHT BOLT DOWN COVER IN ACCORDANCE WITH AS3996:2019 TO SUIT 900x1900 CLEAR OPENING IN ACCORDANCE WITH MANUFACTURERS SPECIFICATIONS. CONSTRUCT NEW JUNCTION PIT AS PER STD. DWG. MCC-201 WITH CLASS C, LIGHTWEIGHT BOLT DOWN COVER. PIT CHAMBERS TO BE CONNECTED VIA A 600x600 BOX OPENING.	2
		JP	900	900			750	147.072						
					EX 225	147.641		147.641						
3		JP	900	900	750	147.113			1.232	148.345	347187.364	5815319.332	CONSTRUCT 2 No. NEW JUNCTION PITS AS PER STD. DWG. MCC-201 WITH CLASS B, LIGHTWEIGHT LOCKABLE LID. ADJACENT PIT CHAMBERS TO BE CONNECTED VIA A 600x600 BOX OPENING.	3
		JP	900	900										
4		JP	900	900	750	147.143			1.840	148.983	347203.074	5815303.551	CONSTRUCT 2 No. NEW JUNCTION PITS AS PER STD. DWG. MCC-201 WITH CLASS B, LIGHTWEIGHT LOCKABLE LID. ADJACENT PIT CHAMBERS TO BE CONNECTED VIA A 600x600 BOX OPENING.	4
		JP	900	900										
5		DBL-GSEF	665	2000	EX 225	147.641	EX 225	147.641	1.044	148.685	347195.082	5815315.359	CONSTRUCT NEW DOUBLE GRATED SIDE ENTRY PIT AS PER STD. DWG. MCC-208.	5
6		GPIT	600	900	EX 225	148.310	EX 225	148.310	0.810	149.120	347205.889	5815323.047	CONSTRUCT NEW GRATED JUNCTION PIT AS PER STD. DWG. MCC-201 WITH COUNCIL APPROVED "V-GRATE".	6
7	SEP		EX	EX	EX 375	149.430	EX 300	149.550	0.976	150.406	347243.310	5815299.286	ADJUST EXISTING SIDE ENTRY PIT TO MATCH TO NEW FINISHED SURFACE LEVELS & KERB ALIGNMENT. CONNECT PROPOSED 150Ø PIPE TO EXISTING PIT CHAMBER AS REQUIRED.	7
							EX 150	149.570						
							150	TBC						
8		GPIT	600	900	150	149.757			0.450	150.207	347243.779	5815296.101	CONSTRUCT NEW FOOTPATH 'V' GRATED DRAINAGE PIT AS PER STD. DWG. MCC-213.	8
9	SEP		EX	EX	EX	EX	EX	EX	EX	150.677	347249.156	5815306.467	ADJUST EXISTING SIDE ENTRY PIT TO MATCH TO NEW FINISHED SURFACE LEVELS & KERB ALIGNMENT.	9

NOTES:

1. PIT FLOORS TO BE SHAPED TO PROVIDE SMOOTH FLOW THROUGH PITS.
2. ALL EXISTING PIPE LEVELS ARE TO BE CONFIRMED BY THE CONTRACTOR PRIOR TO COMMENCING CONSTRUCTION. COUNCIL'S SUPERINTENDENT SHALL BE NOTIFIED IF THERE ARE ANY DISCREPANCIES PRIOR TO COMMENCING CONSTRUCTION.
3. ALL PIT SETOUT IS TO THE CENTRE OF THE PIT CHAMBER, UNLESS NOTED OTHERWISE IN THE REMARKS COLUMN.
4. ALL PITS SHOULD BE ALIGNED TO KERB AND CHANNELS AND MATCH TO PROPOSED SURFACE LEVELS & SLOPES AS REQUIRED.

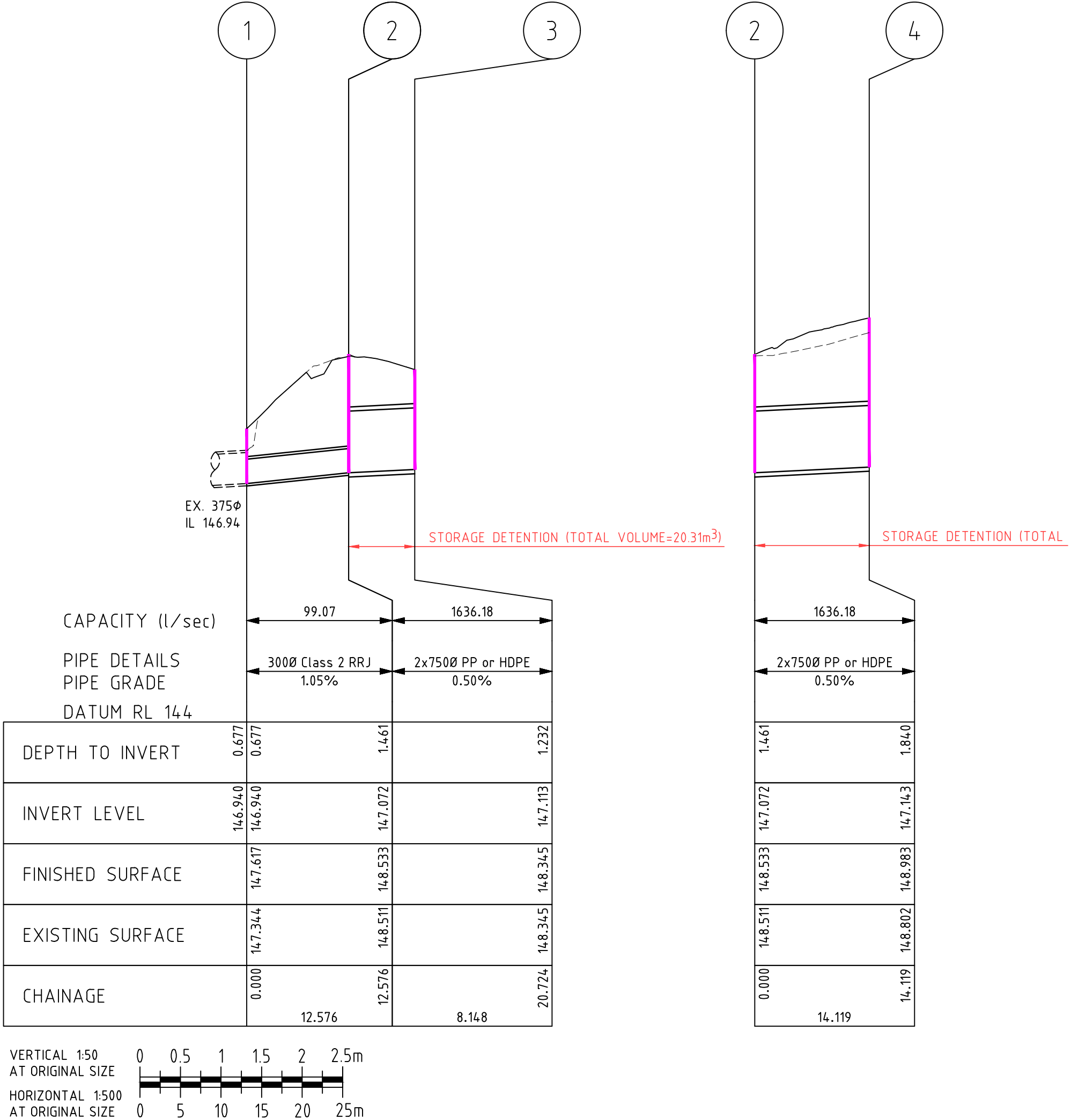
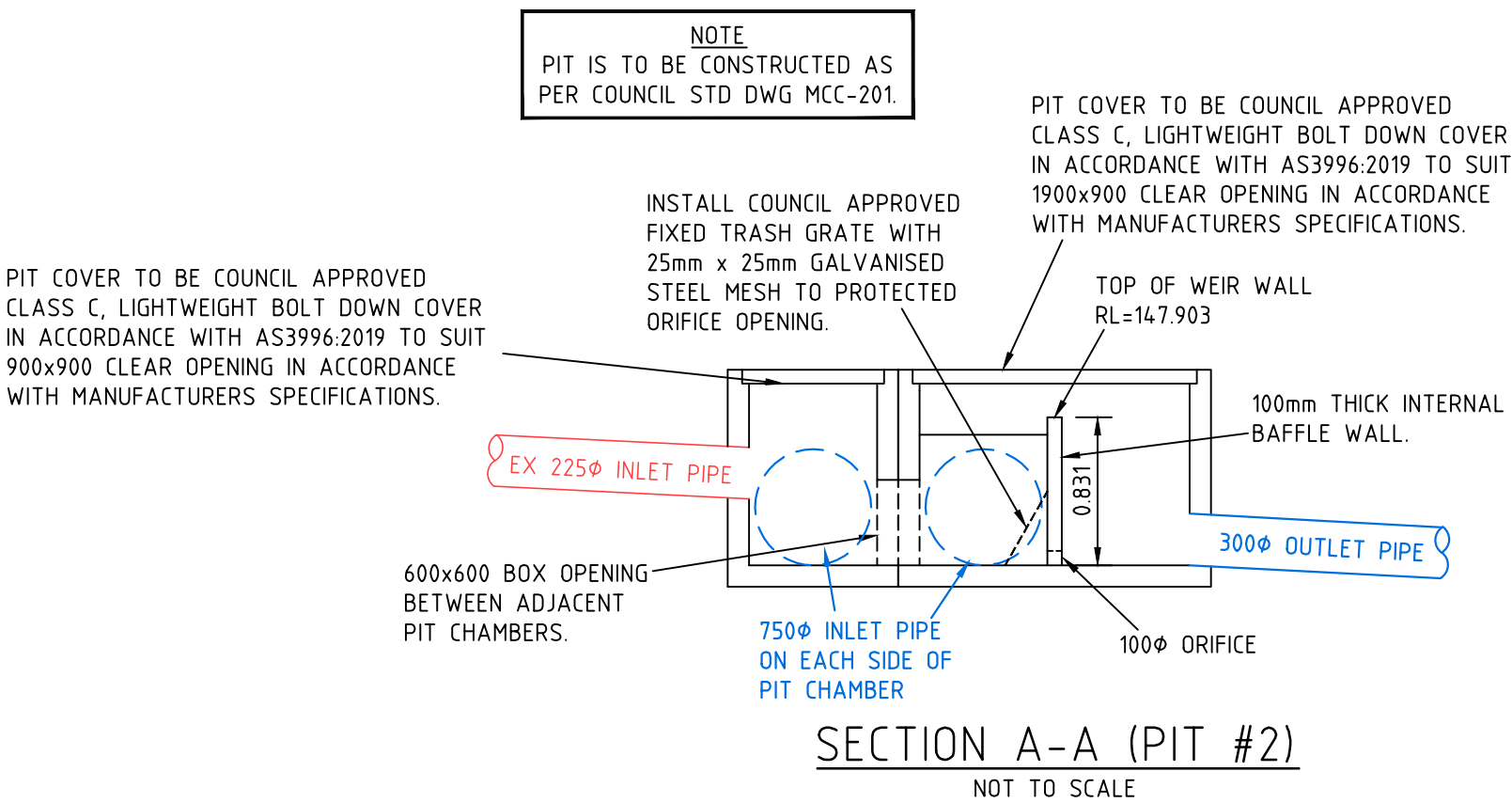
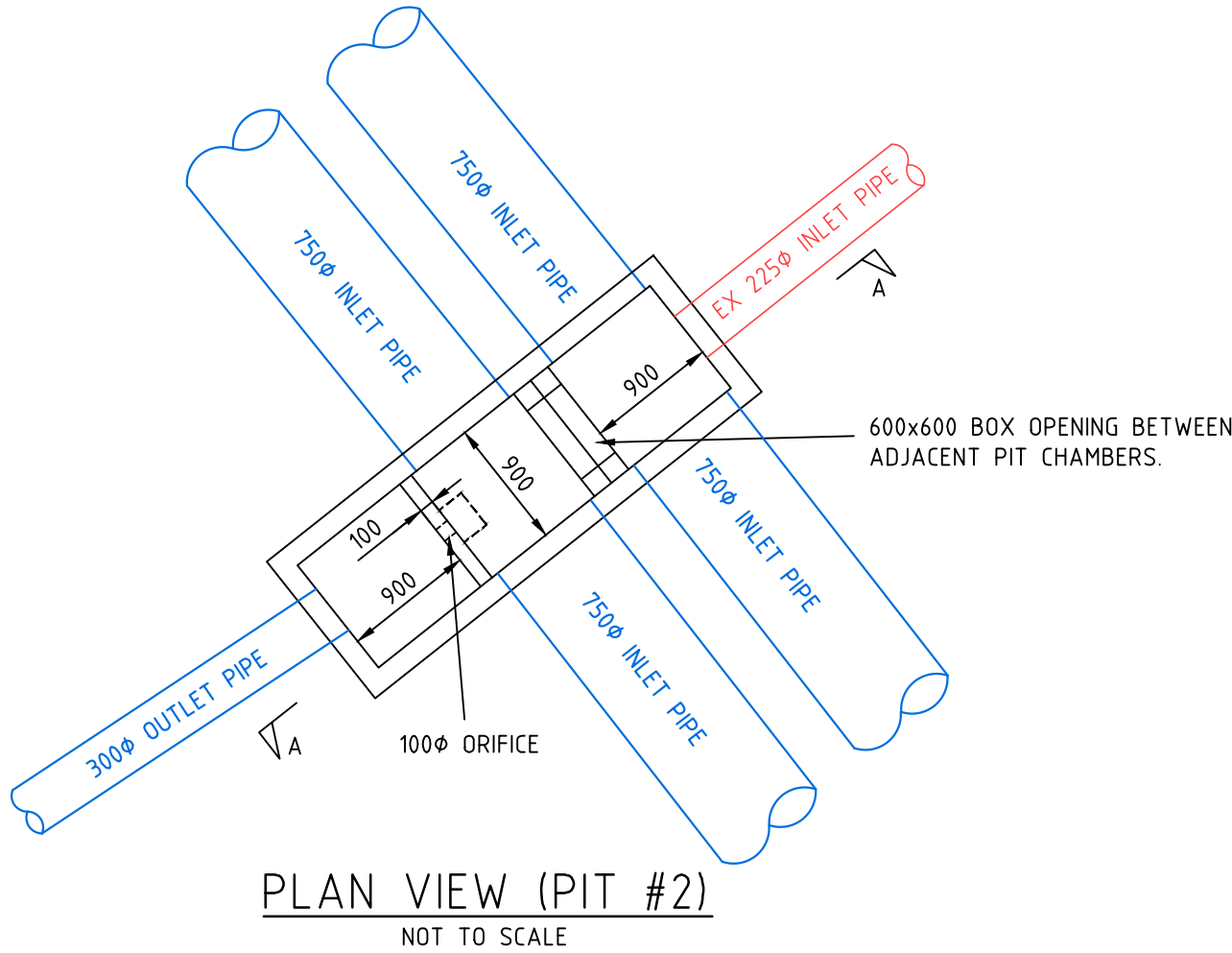

WARNING
BEWARE OF UNDERGROUND SERVICES

THE LOCATION OF UNDERGROUND SERVICES SHOWN ARE APPROXIMATE ONLY AND THEIR EXACT POSITION SHOULD BE PROVEN ON SITE. NO GUARANTEE IS GIVEN THAT ALL SERVICES ARE SHOWN. THE CONTRACTOR MUST VERIFY ALL SERVICES ON SITE PRIOR TO ANY EXCAVATION WORKS.



NOTE:
ALL NOTED "ABANDONED" SERVICES INCLUDING GAS MAINS, WATER MAINS, ETC. - THE CONTRACTOR SHALL BE RESPONSIBLE & CONFIRM THAT THESE SERVICES ARE ABANDONED, INCLUDING LAISING WITH THE RELEVANT AUTHORITY PRIOR TO COMMENCING CONSTRUCTION.

	TOF	EX TELSTRA OPTIC FIBRE	HGP	EX HIGH PRESSURE GAS MAIN		
LEGEND	T	EX TELSTRA CABLE & PIT	STOP VALVE		TS	TRAFFIC SIGNAL PIT, CABLE, PEDESTAL
	S	EX SEWER & PIT	PIPE FULG		+	TRAFFIC SIGNAL POLE
	W	EX WATER MAIN	PIRE HYDRANT (ABOVE GROUND)		+	UNCLASSIFIED PIT
	ABW	EX ABANDONED WATER MAIN	PIRE HYDRANT (GROUND LEVEL)		+	FENCE
	G	EX GAS MAIN	ELECTRICITY SUPPLY POLE		+	TREE
	ABC	EX ABANDONED GAS MAIN	E.S.P. WITH LIGHT		+	LIMIT OF WORKS
	E	EX U/G ELECTRICITY CABLE	U.P. LIGHT ONLY		+	EXISTING BOLLARD
	U	EX U/G ELECTRICITY CABLE	EX OPTIC CABLE		+	RUBBISH BIN
	O	EX HO'S DRAIN	TELECOM PILLAR		+	EX DRAIN & PIT
	H	HO'S DRAIN	EXISTING POST		+	PROPOSED DRAIN & PIT
					+	PSM
					+	STM/TBM
					+	
					+	



Civil • Municipal • Drainage • Project Management

Level 1/116 Puckle Street, Moonee Ponds, Vic, 3039
Phone: 0417 318 556
Email: admin@creconsulting.com.au

DESIGNED : CRE	DATE : 19/02/25
----------------	-----------------

CHECKED :

--	--

SURVEY DATUM : A.H.D. / MGA2020

CLIENT:



ANSLIE PARK, CROYDON CAR PARK UPGRADE

DRAINAGE LONGITUDINAL SECTIONS

CRE REF: 3193-(REV-P7).DWG

CRF REV NO: P7

Doc.No. 3193

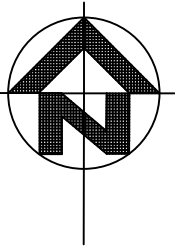

SIGN SCHEDULE

S1

"DISABLED PARKING" (RIGHT)
SIGN R5-(IR)

S2

"DISABLED PARKING" (LEFT)
SIGN R5-(IL)

S3

"YOU ARE WITHIN PARKING AREA"
SIGN R5-62

No. 1

AINSLIE PARK

CROYDON WEST
GIRL GUIDES

AINSLIE PARK

EDITH AVENUE

No. 2

No. 3B

No. 3

No. 37B

AINSLIE PARK AVENUE

WARNING
BEWARE OF UNDERGROUND SERVICES
THE LOCATION OF UNDERGROUND SERVICES
SHOWN ARE APPROXIMATE ONLY AND THEIR
EXACT POSITION SHOULD BE PROVIDED ON SITE.
NO GUARANTEE IS GIVEN THAT ALL SERVICES ARE SHOWN.
THE CONTRACTOR MUST VERIFY ALL SERVICES ON SITE
PRIOR TO ANY EXCAVATION WORKS.



NOTE:
ALL NOTED "ABANDONED" SERVICES INCLUDING GAS
MAINS, WATER MAINS, ETC. - THE CONTRACTOR
SHALL BE RESPONSIBLE & CONFIRM THAT THESE
SERVICES ARE ABANDONED, INCLUDING LIAISING
WITH THE RELEVANT AUTHORITY PRIOR TO
COMMENCING CONSTRUCTION.



LEGEND	TOF		EX TELSTRA OPTIC FIBRE		HPG		EX HIGH PRESSURE GAS MAIN	
	T	EX TELSTRA CABLE & PIT						
	S	EX SOWER & PIT						
	W	EX WATER MAIN						
	ABW	EX ABANDONED WATER MAIN						
	G	EX GAS MAIN						
	ABG	EX ABANDONED GAS MAIN						
	E	EX U/G ELECTRICITY CABLE						
	E	EX O/H ELECTRICITY CABLE						
	O	EX OPTUS CABLE						
	HD	EX HOUSE DRAIN						
		STOP VALVE						
		FIRE PLUG						
		FIRE HYDRANT (ABOVE GROUND)						
		FIRE HYDRANT (GROUND LEVEL)						
	ELECTRICITY SUPPLY POLE							
	E.S.P. WITH LIGHT							
	LIGHT POLE ONLY							
	TELECOM PILLAR							
	EXISTING POST							
	TRAFFIC SIGNAL PIT, CABLE, PEDESTAL							
	TRAFFIC SIGNAL POLE							
	UNCLASSIFIED PIT							
	EX. SIGN							
	EXISTING BOLLARD							
	RUBBISH BIN							
	PSM							
	STN/TBM							
	EX DRAIN & PIT							
	PROPOSED DRAIN & PIT							
	LIMIT OF WORKS							
	TREE							
	FENCE							