

154 HEATHMONT ROAD, HEATHMONT PROPOSED CARPARK

GENERAL NOTES

- ALL WORK SHALL BE CARRIED OUT IN ACCORDANCE WITH MAROONDAH CITY COUNCIL STANDARD DRAWINGS AND SPECIFICATIONS UNLESS SPECIFIED OTHERWISE.
- REFER FEATURE AND LEVEL SURVEY FOR ADDITIONAL TBM INFORMATION.
- WHERE WORKS ARE IN THE VICINITY OF EXISTING SERVICES, THE CONTRACTOR SHALL VERIFY ALL LOCATIONS AND DEPTHS PRIOR TO THE COMMENCEMENT OF WORKS. THE CONTRACTOR SHALL ADVISE THE SUPERINTENDENT OF ANY REQUIRED ALTERATIONS.
- ALL WORK PRACTICES SHALL COMPLY WITH THE OCCUPATIONAL HEALTH & SAFETY ACT AND ALL RELEVANT REGULATIONS AND CODES OF PRACTICE (IN PARTICULAR, THE CODE OF PRACTICE FOR SAFETY PRECAUTIONS IN TRENCHING OPERATIONS).
- WORKSAFE VICTORIA IS TO BE INFORMED FOR TRENCHING OPERATIONS WHERE THE DEPTH IS GREATER THAN 1.5m.
- THE CONTRACTOR SHALL STRICTLY COMPLY WITH "NO GO ZONE" CLEARANCE REQUIREMENTS WHEN WORKING WITHIN THE VICINITY OF OVERHEAD ELECTRICAL ASSETS/CABLES. FOR ANY OPERATION WHICH ENCLOSES ON THE 3.0m "NO GO ZONE", THE CONTRACTOR SHALL OBTAIN A WRITTEN PERMIT TO WORK FROM WORKSAFE. CONTRACTORS SHALL ALSO COMPLY WITH RELEVANT WORKING CLEARANCES FOR OTHER UNDERGROUND UTILITIES AS SPECIFIED BY THE UTILITY OWNERS, INCLUDING BUT NOT LIMITED TO UNDERGROUND GAS & ELECTRICAL SERVICES. FURTHER INFORMATION ON "NO GO ZONE" CLEARANCE REQUIREMENTS, REFER TO CURRENT WORKSAFE VICTORIA PUBLICATIONS (WWW.WORKSAFE.VIC.GOV.AU).
- ALL CONCRETE SHALL BE SAWCUT TO THE NEAREST JOINT UNLESS SPECIFIED OTHERWISE.
- ALL SERVICE COVERS WITHIN THE LIMIT OF WORKS SHALL BE ADJUSTED TO MATCH PROPOSED FINISHED SURFACE LEVELS.
- NO TREES OR VEGETATION SHALL BE REMOVED UNLESS AUTHORISED BY MAROONDAH CITY COUNCIL.
- ALL DISTURBED AREAS SHALL BE TOPSOILED AND SEEDED TO A MINIMUM DEPTH OF 100mm. UNLESS NOTED OTHERWISE.
- SITE EROSION CONTROL AND MINIMISATION MEASURES SHALL BE ADOPTED AT ALL TIMES IN ACCORDANCE WITH THE ENVIRONMENTAL PROTECTION AUTHORITY'S ENVIRONMENTAL GUIDELINES FOR MAJOR CONSTRUCTION SITES.
- TRAFFIC MANAGEMENT IS TO BE UNDERTAKEN IN ACCORDANCE WITH THE ROAD MANAGEMENT ACT 2004 AND AS1742.3. ALL SIGNAGE (TEMPORARY AND PERMANENT) SHALL BE CLASS 1 REFLECTIVE GRADE.
- ALL CONCRETE TO HAVE COMPRESSIVE STRENGTH AT 28 DAYS NOT LESS THAN 25 MPa UNLESS SPECIFIED OTHERWISE.
- ALL CRUSHED ROCK TO BE CURRENT VICROADS REGISTERED MIXES.
- CLASS 3 CRUSHED ROCK & CEMENT TREATED CRUSHED ROCK MAY CONTAIN 100% CRUSHED CONCRETE IN ACCORDANCE WITH VICROADS TECHNICAL NOTE TN 107 - USE OF RECYCLED MATERIALS IN ROAD PAVEMENTS.
- ALL LINE MARKING TO BE IN ACCORDANCE WITH AUSTRALIAN STANDARDS AS 1742.1 AND TO BE LONG LIFE THERMOPLASTIC IN ACCORDANCE WITH VICROADS SECTION 724 OR AS DIRECTED BY SUPERVISING ENGINEER.
- WHERE PRODUCTS HAVE RECOMMENDED SUPPLIERS, ALTERNATIVES MAY BE CONSIDERED, HOWEVER MUST BE ACCEPTED BY COUNCIL IN WRITING.
- ALL FOOTPATH TO BE 125mm THICK CONCRETE AS PER MAROONDAH STANDARD DRAWING MCC-401.

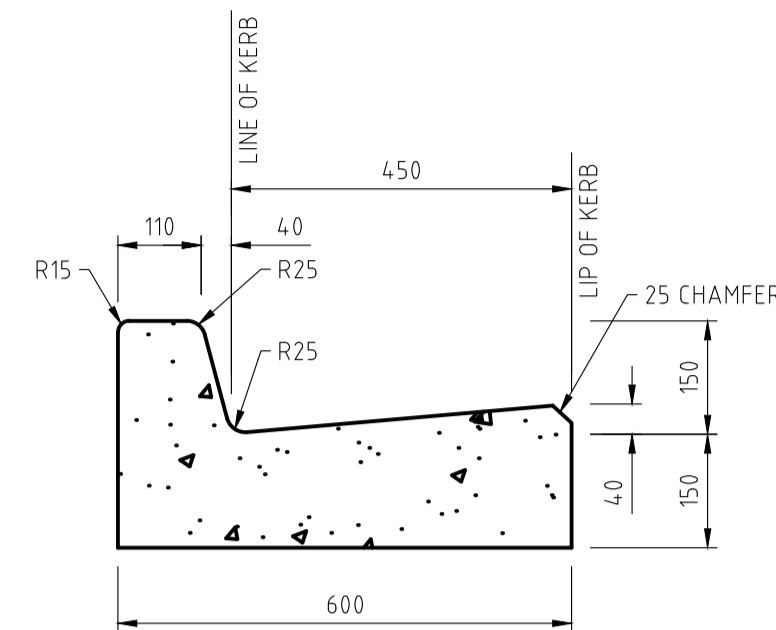

B2
BARRIER KERB DETAIL
SCALE 1:10

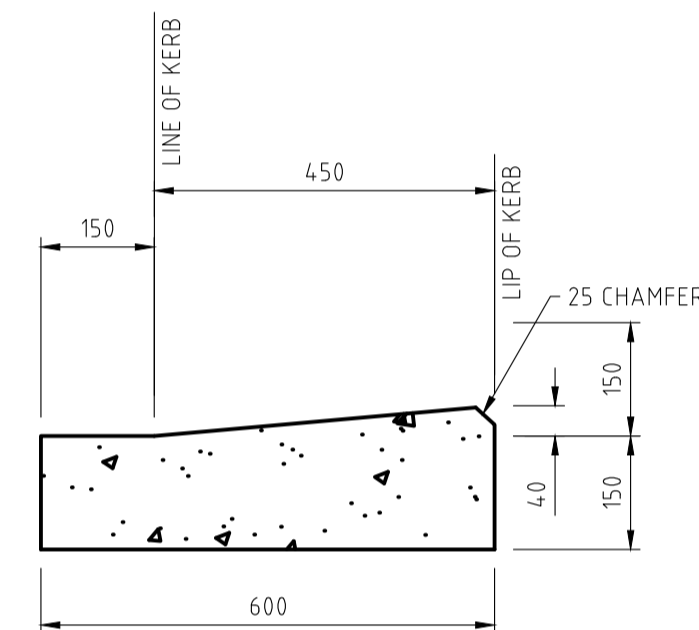

CASTELLATED KERB DETAIL
SCALE 1:10

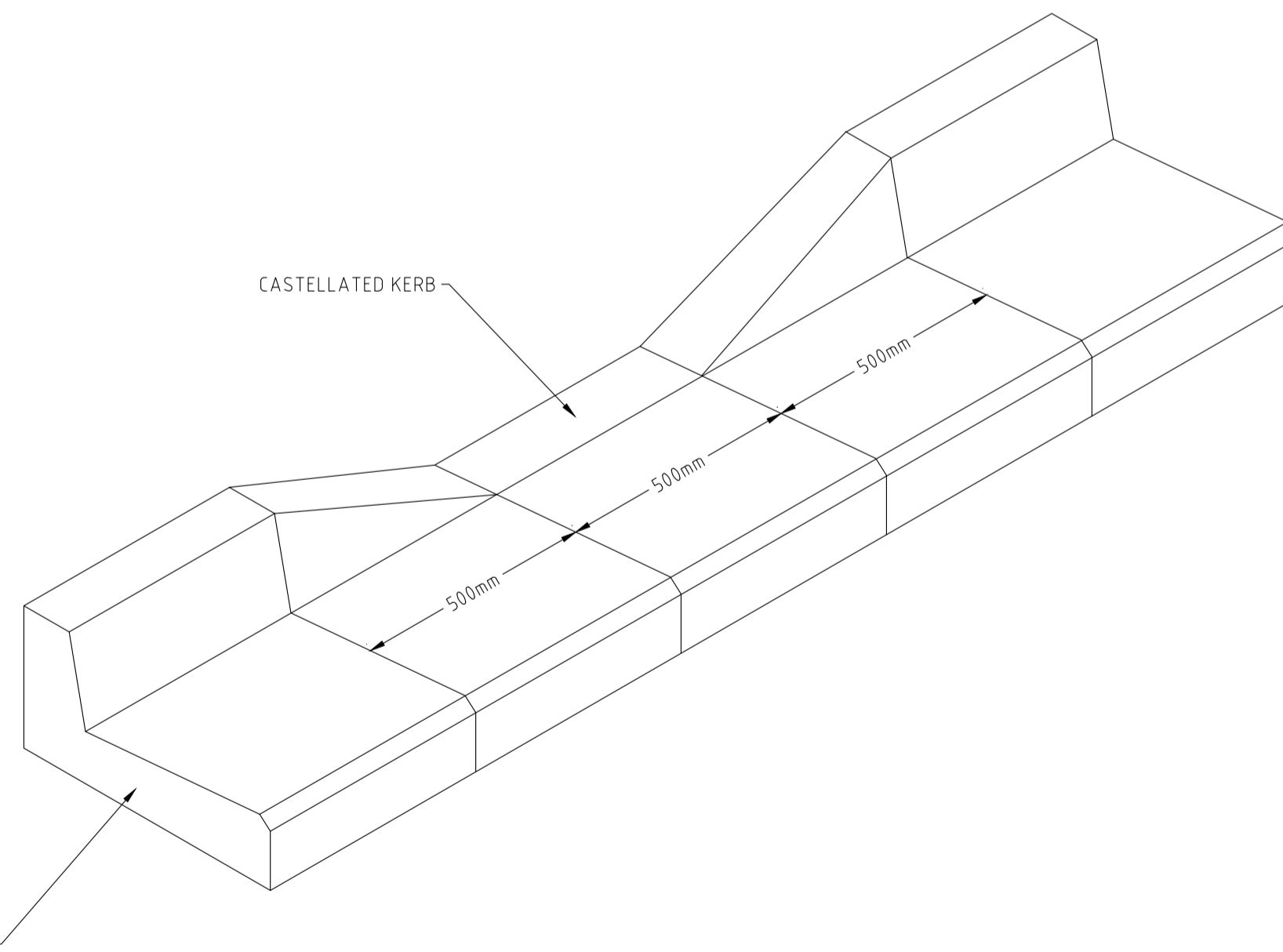

CASTELLATED KERB DETAIL
NOT TO SCALE

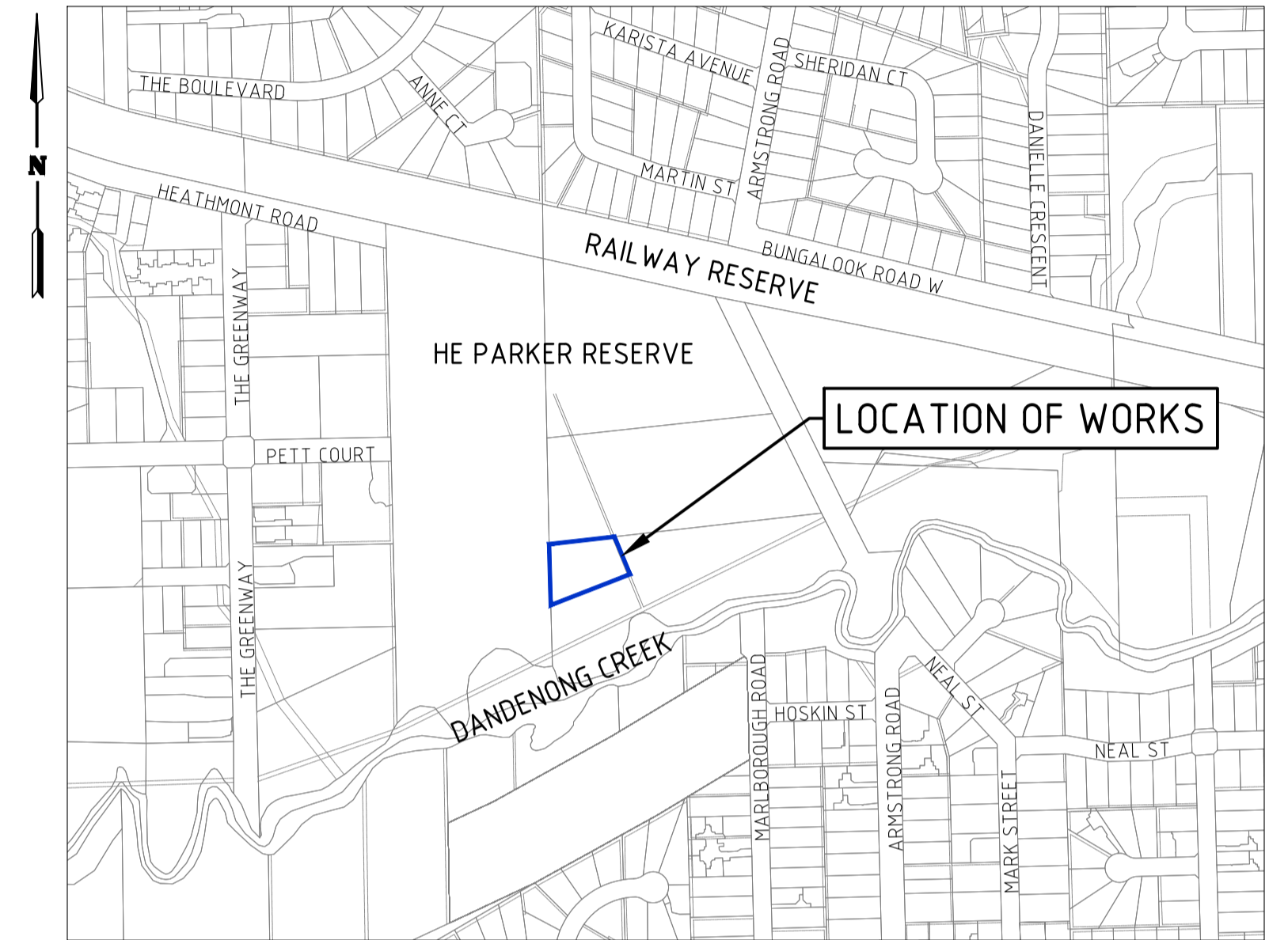

LOCALITY PLAN
1:5000

SHEET INDEX		
SHEET	TITLE	REVISION
1	NOTES & DETAILS PLAN	2
2	PAVEMENT PLAN	2
3	LAYOUT PLAN	2
4	CONTOUR PLAN	2
5	CROSS SECTIONS PLAN	2
6	CROSS SECTIONS PLAN	2
7	LONG SECTION PLAN	2
8	SETOUT DETAILS	2
9	SETOUT DETAILS	2



PAVEMENT DETAIL
NTS



WARNING
BEWARE UNDERGROUND SERVICES
THE LOCATION OF EXISTING SERVICES SHOWN ON THESE PLANS ARE APPROXIMATE ONLY AND THE EXACT POSITIONS SHALL BE PROVEN ON SITE. THE APPROPRIATE AUTHORITIES SHALL BE CONTACTED AND THE SERVICES LOCATED PRIOR TO COMMENCEMENT OF ANY WORKS. NO GUARANTEE IS GIVEN THAT ALL EXISTING SERVICES ARE SHOWN.

DISCLAIMER
THE USE OF THIS DRAWING MAY ONLY BE USED FOR THE PURPOSE SPECIFIED BY THE STATUS STAMP SHOWN BELOW. DUTY OF CARE MUST BE CARRIED OUT BY THE RELEVANT PERSONS TO REVIEW ALL ACCOMPANYING INFORMATION SUCH AS CONTRACTS, SPECIFICATIONS, REPORTS AND DRAWINGS.

STATUS:
ISSUE FOR CONSTRUCTION

BY	DATE
DRAFTED JW	JAN 2024
DESIGNED JW	JAN 2024
CHECKED KW	13/02/2024
APPROVED	

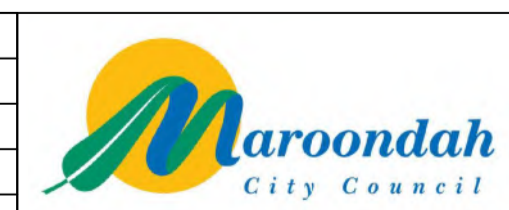

CIVIL DESIGN PTY LTD
MOBILE: 0433 322 258
EMAIL: kanchana.wifhana@civildesign.com.au

REV	DATE	BY	DESCRIPTION
2	13/02/2024	Jw	ISSUE FOR CONSTRUCTION
1	24/01/2024	Jw	AMENDMENTS AS PER COUNCIL COMMENTS

PROPOSED CARPARK
154 HEATHMONT ROAD, HEATHMONT
MAROONDAH CITY COUNCIL

NOTES & DETAILS PLAN

23055E 00 C1
SHEET 01 OF 09
SHEET SIZE: A1

LEGEND	
	EXISTING TREE
	EXISTING TREE PROTECTION ZONE & STRUCTURAL ROOT ZONE
	EXISTING TREE TO BE REMOVED
	EXISTING PIT
	EXISTING DRAIN PIPE
	EXISTING ELECTRICITY
	EXISTING GAS
	EXISTING SEWER
	EXISTING TELECOMMUNICATIONS
	EXISTING WATER
	PROPOSED ASPHALT PAVEMENT AS PER DETAIL IN SHEET 1
	PROPOSED REINFORCED CONCRETE FOOTPATH 125mm THICK 25MPa CONCRETE, SL72 MESH CENTRALLY PLACED ON 50mm CLASS 3 CRUSHED ROCK AS PER MCC-401
	LINE MARKING TO BE WHITE THERMOPLASTIC MARKINGS AS SPECIFIED
	TREE MULCH REINSTATEMENT AS SPECIFIED
	TOPSOIL AND SEED AS SPECIFIED
	GRAVEL REINSTATEMENT
	CASTELLATED KERB AS PER DETAIL IN SHEET 1

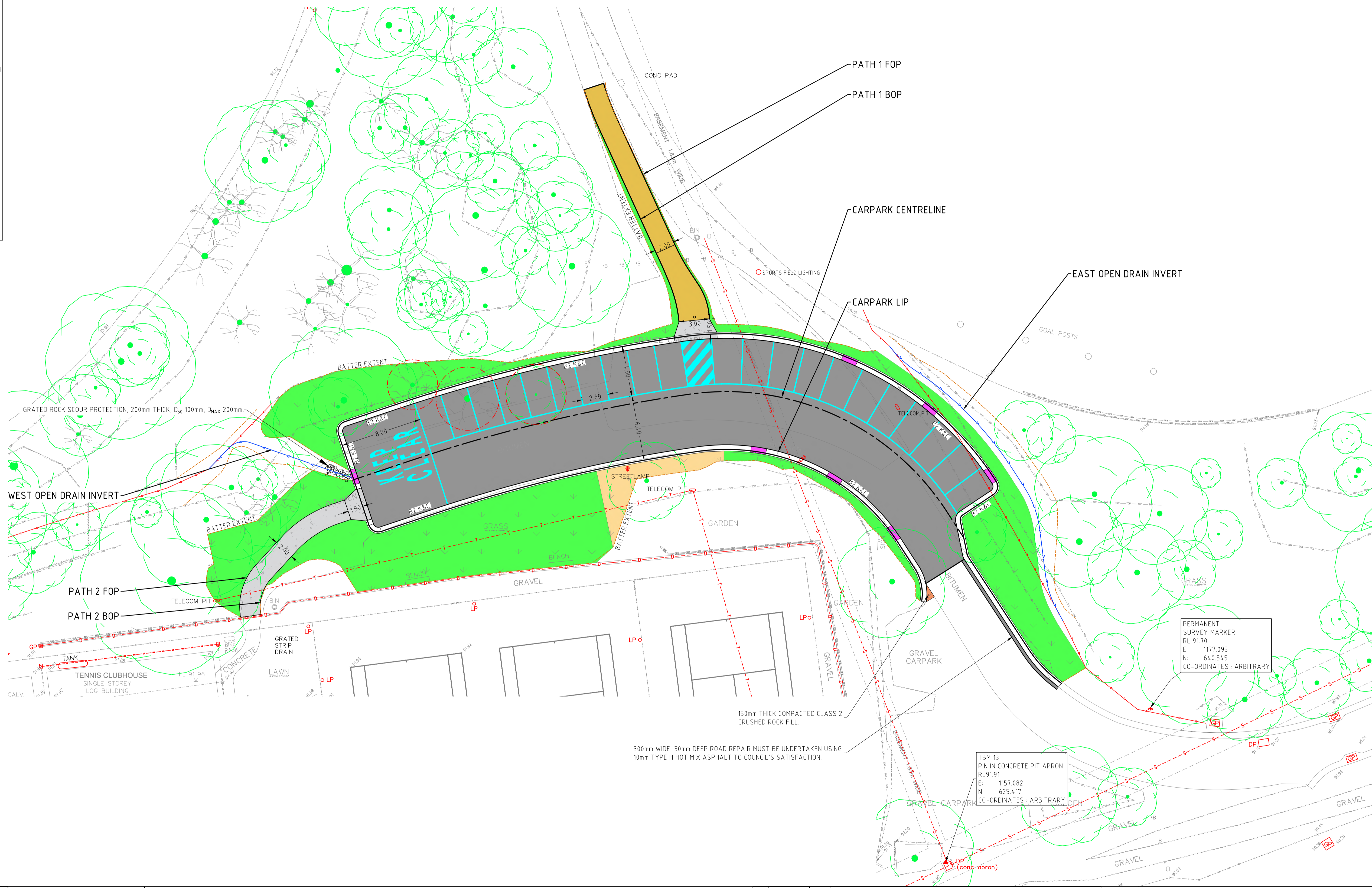

BEFORE YOU DIG
www.byda.com.au
Zero Damage - Zero Harm

WARNING
BEWARE UNDERGROUND SERVICES
THE LOCATION OF EXISTING SERVICES SHOWN ON THESE PLANS ARE APPROXIMATE ONLY AND THE EXACT POSITIONS SHALL BE PROVEN ON SITE. THE APPROPRIATE AUTHORITIES SHALL BE CONTACTED AND THE SERVICES LOCATED PRIOR TO COMMENCEMENT OF ANY WORKS. NO GUARANTEE IS GIVEN THAT ALL EXISTING SERVICES ARE SHOWN.

DISCLAIMER	BY	DATE
THE USE OF THIS DRAWING MAY ONLY BE USED FOR THE PURPOSE SPECIFIED BY THE STATUS STAMP SHOWN BELOW. DUTY OF CARE MUST BE CARRIED OUT BY THE RELEVANT PERSONS TO REVIEW ALL ACCOMPANYING INFORMATION SUCH AS CONTRACTS, SPECIFICATIONS, REPORTS AND DRAWINGS.	DRAFTED	JW JAN 2024
	DESIGNED	JW JAN 2024
	CHECKED	KW 13/02/2024
	APPROVED	

STATUS:	CIVIL DESIGN PTY LTD
ISSUE FOR CONSTRUCTION	MOBILE: 04 33 322 258 EMAIL: kanchana.wifhana@civildesign.com.au

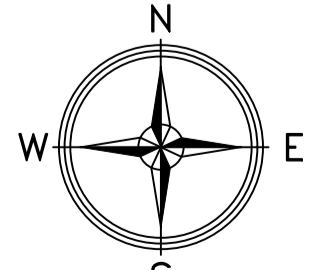

SCALE 1:200

REV	DATE	BY	DESCRIPTION
2	13/02/2024	JW	ISSUE FOR CONSTRUCTION
1	24/01/2024	JW	AMENDMENTS AS PER COUNCIL COMMENTS

PROPOSED CARPARK
154 HEATHMONT ROAD, HEATHMONT
MAROONDAH CITY COUNCIL

PAVEMENT PLAN
23055E 00 C2
SHEET 02 OF 09
SHEET SIZE: A1

LEGEND	
	EXISTING TREE
	EXISTING TREE PROTECTION ZONE & STRUCTURAL ROOT ZONE
	EXISTING TREE TO BE REMOVED
	EXISTING PIT
	EXISTING DRAIN PIPE
	EXISTING ELECTRICITY
	EXISTING GAS
	EXISTING SEWER
	EXISTING TELECOMMUNICATIONS
	EXISTING WATER
	CASTELLATED KERB AS PER DETAIL IN SHEET 1

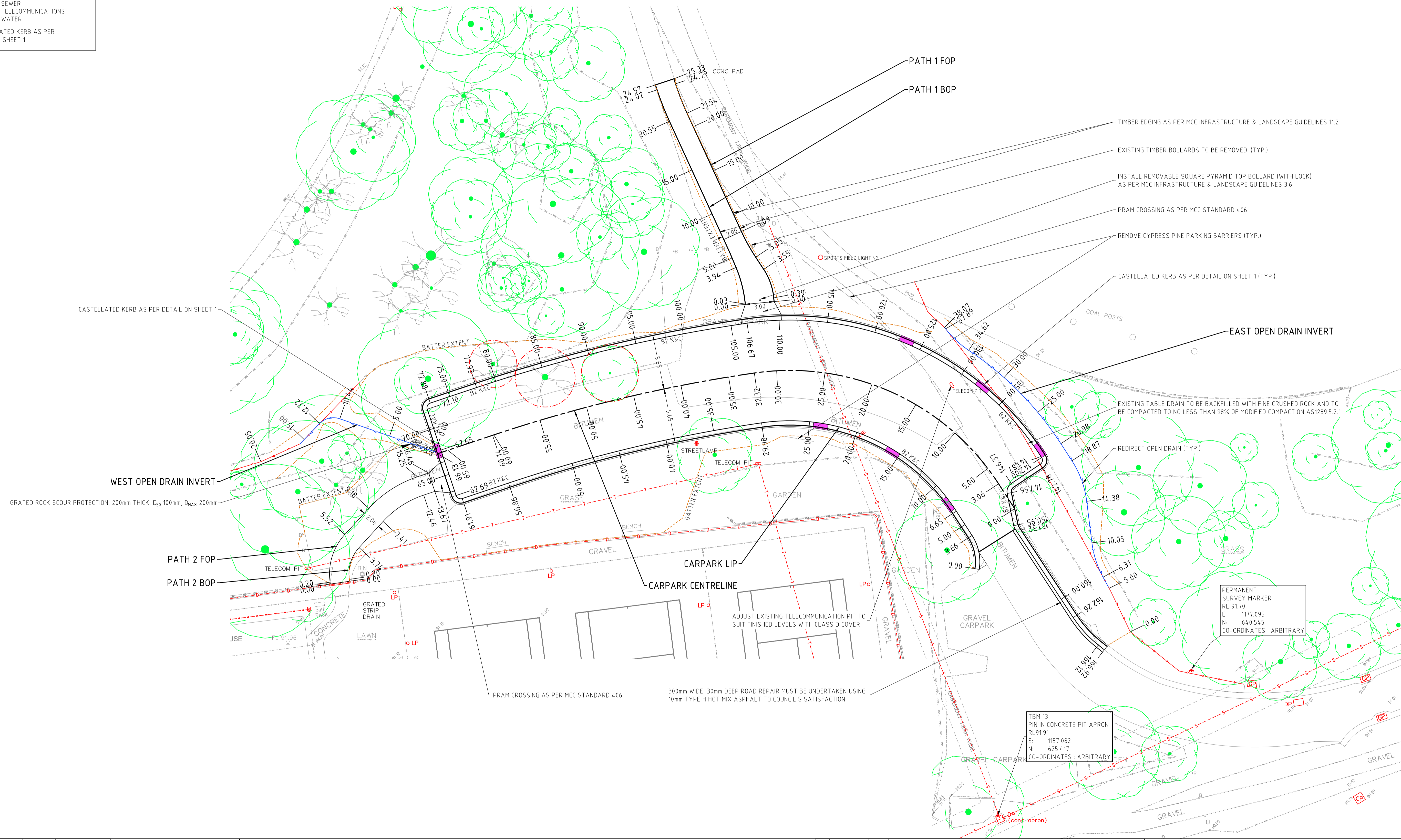

BEFORE YOU DIG
www.byda.com.au
Zero Damage - Zero Harm

WARNING
BEWARE UNDERGROUND SERVICES
THE LOCATION OF EXISTING SERVICES SHOWN ON THESE PLANS ARE APPROXIMATE ONLY AND THE EXACT POSITIONS SHALL BE PROVEN ON SITE. THE APPROPRIATE AUTHORITIES SHALL BE CONTACTED AND THE SERVICES LOCATED PRIOR TO COMMENCEMENT OF ANY WORKS. NO GUARANTEE IS GIVEN THAT ALL EXISTING SERVICES ARE SHOWN.

DISCLAIMER		
THE USE OF THIS DRAWING MAY ONLY BE USED FOR THE PURPOSE SPECIFIED BY THE STATUS STAMP SHOWN BELOW. DUTY OF CARE MUST BE CARRIED OUT BY THE RELEVANT PERSONS TO REVIEW ALL ACCOMPANYING INFORMATION SUCH AS CONTRACTS, SPECIFICATIONS, REPORTS AND DRAWINGS.		
STATUS:	ISSUE FOR CONSTRUCTION	

BY	DATE
DRAFTED JW	JAN 2024
DESIGNED JW	JAN 2024
CHECKED KW	13/02/2024
APPROVED	

Maroondah
City Council

CIVIL DESIGN

CIVIL DESIGN PTY LTD
MOBILE: 0433 322 258
EMAIL: kanchana.witthana@civildesign.com.au

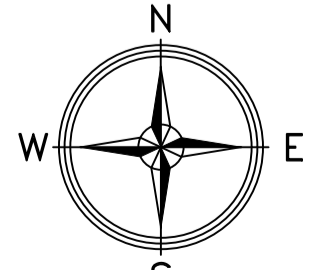

SCALE 1:200

REV	DATE	BY	DESCRIPTION
2	13/02/2024	JW	ISSUE FOR CONSTRUCTION
1	24/01/2024	JW	AMENDMENTS AS PER COUNCIL COMMENTS

PROPOSED CARPARK
154 HEATHMONT ROAD, HEATHMONT
MAROONDAH CITY COUNCIL

LAYOUT PLAN

23055E 00 C3
SHEET 03 OF 09
SHEET SIZE: A1

LEGEND	
	EXISTING TREE
	EXISTING TREE PROTECTION ZONE & STRUCTURAL ROOT ZONE
	EXISTING TREE TO BE REMOVED
	EXISTING PIT
	EXISTING DRAIN PIPE
	EXISTING ELECTRICITY
	EXISTING GAS
	EXISTING SEWER
	EXISTING TELECOMMUNICATIONS
	EXISTING WATER
	EXISTING MAJOR CONTOUR
	EXISTING MINOR CONTOUR
	FINISHED MAJOR CONTOUR
	FINISHED MINOR CONTOUR

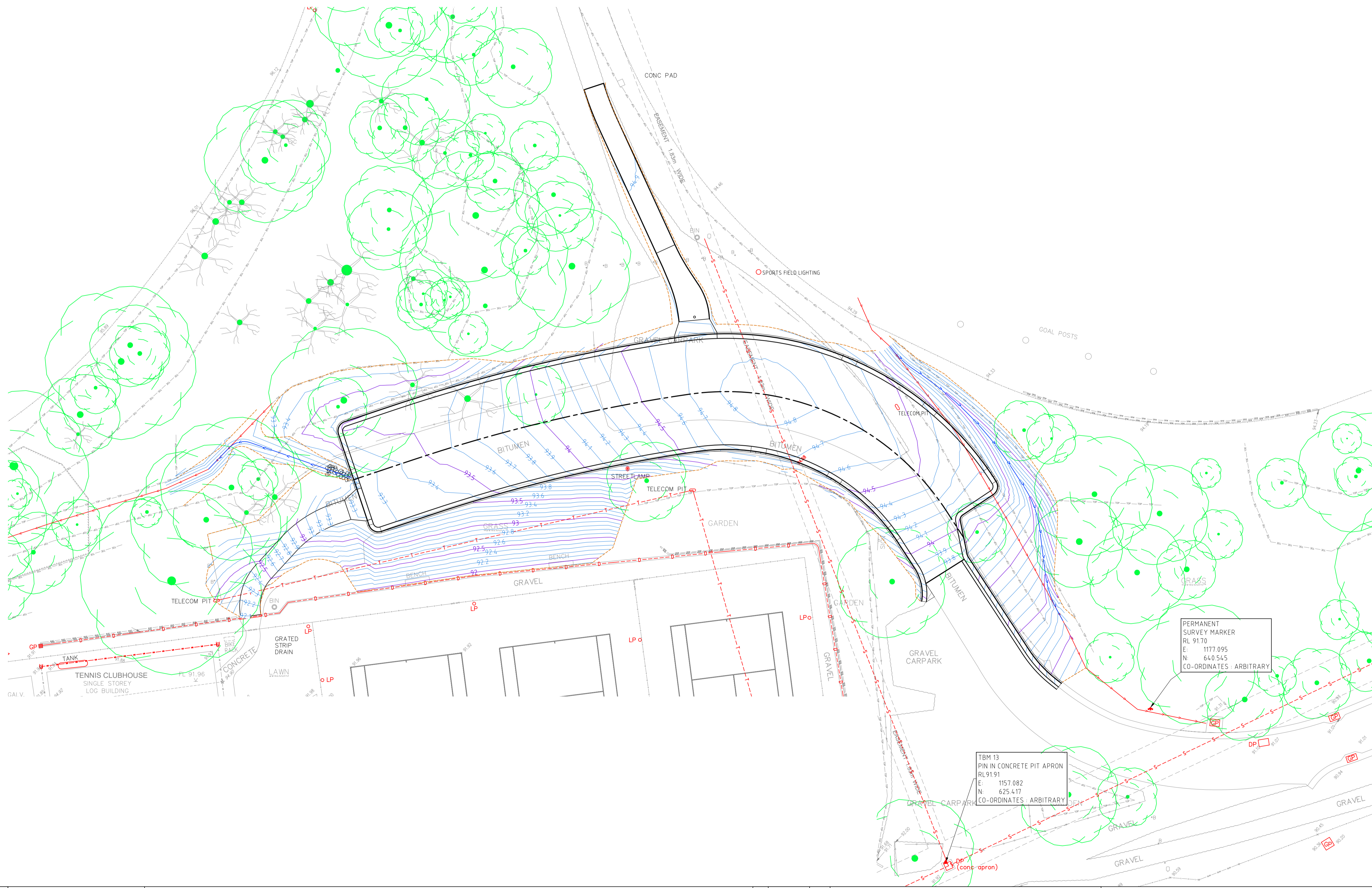

BEFORE YOU DIG
www.byda.com.au
Zero Damage - Zero Harm

WARNING
BEWARE UNDERGROUND SERVICES
THE LOCATION OF EXISTING SERVICES SHOWN ON THESE PLANS ARE APPROXIMATE ONLY AND THE EXACT POSITIONS SHALL BE PROVEN ON SITE. THE APPROPRIATE AUTHORITIES SHALL BE CONTACTED AND THE SERVICES LOCATED PRIOR TO COMMENCEMENT OF ANY WORKS. NO GUARANTEE IS GIVEN THAT ALL EXISTING SERVICES ARE SHOWN.

DISCLAIMER
THE USE OF THIS DRAWING MAY ONLY BE USED FOR THE PURPOSE SPECIFIED BY THE STATUS STAMP SHOWN BELOW. DUTY OF CARE MUST BE CARRIED OUT BY THE RELEVANT PERSONS TO REVIEW ALL ACCOMPANYING INFORMATION SUCH AS CONTRACTS, SPECIFICATIONS, REPORTS AND DRAWINGS.

BY	DATE
DRAFTED JW	JAN 2024
DESIGNED JW	JAN 2024
CHECKED KW	13/02/2024
APPROVED	

STATUS:
ISSUE FOR CONSTRUCTION

CIVIL DESIGN PTY LTD
MOBILE: 0433 322 258
EMAIL: kanchana.withana@civildesign.com.au

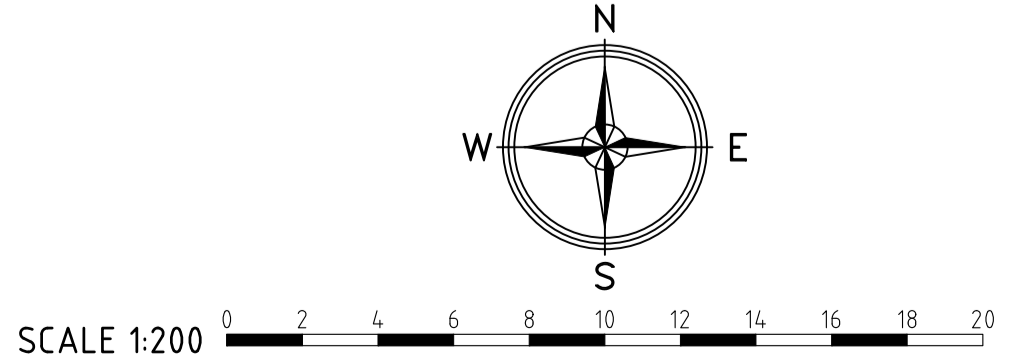

REV	DATE	BY	DESCRIPTION
2	13/02/2024	JW	ISSUE FOR CONSTRUCTION
1	24/01/2024	JW	AMENDMENTS AS PER COUNCIL COMMENTS

PROPOSED CARPARK
154 HEATHMONT ROAD, HEATHMONT
MAROONDAH CITY COUNCIL

CONTOUR PLAN

23055E 00 C4
SHEET 04 OF 09
SHEET SIZE: A1

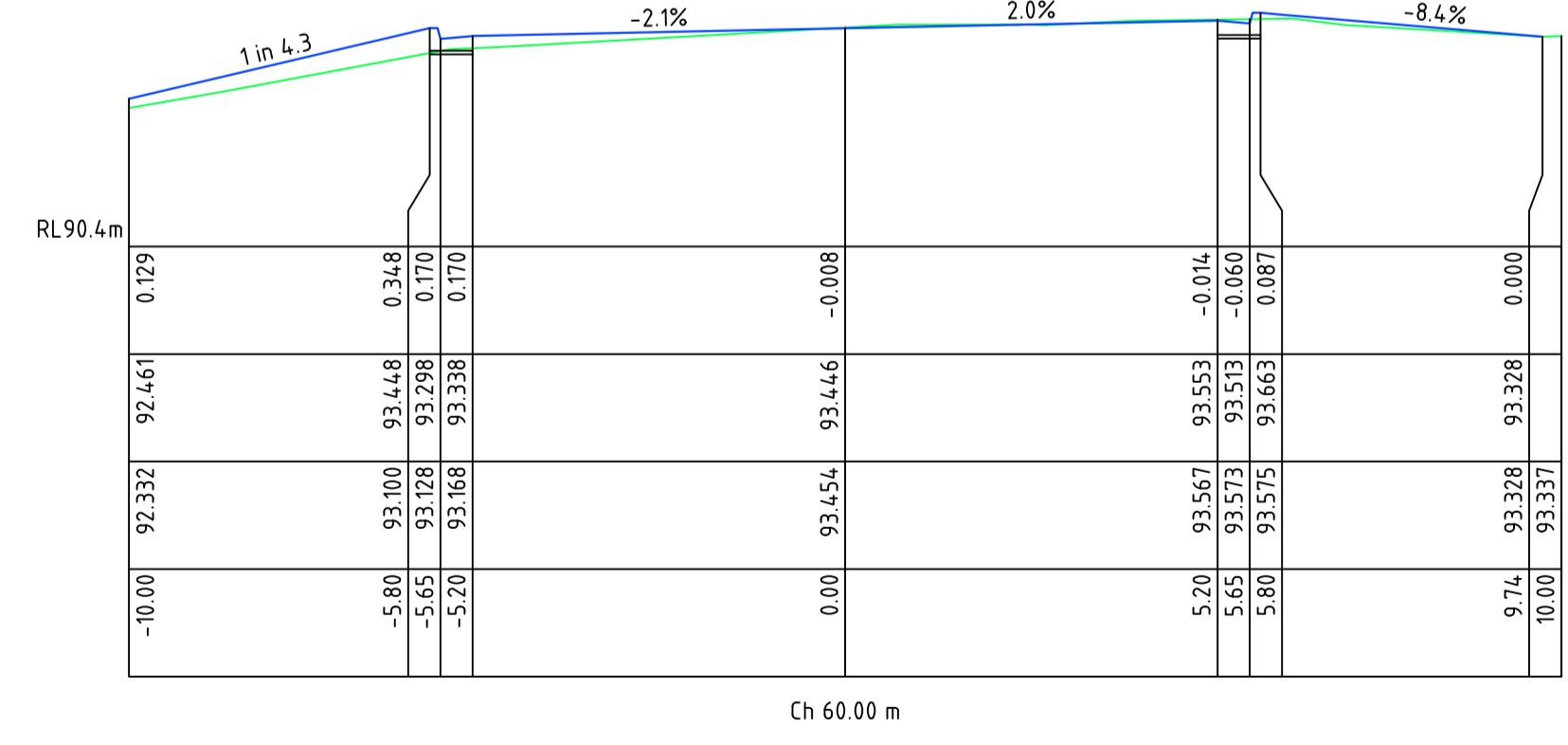
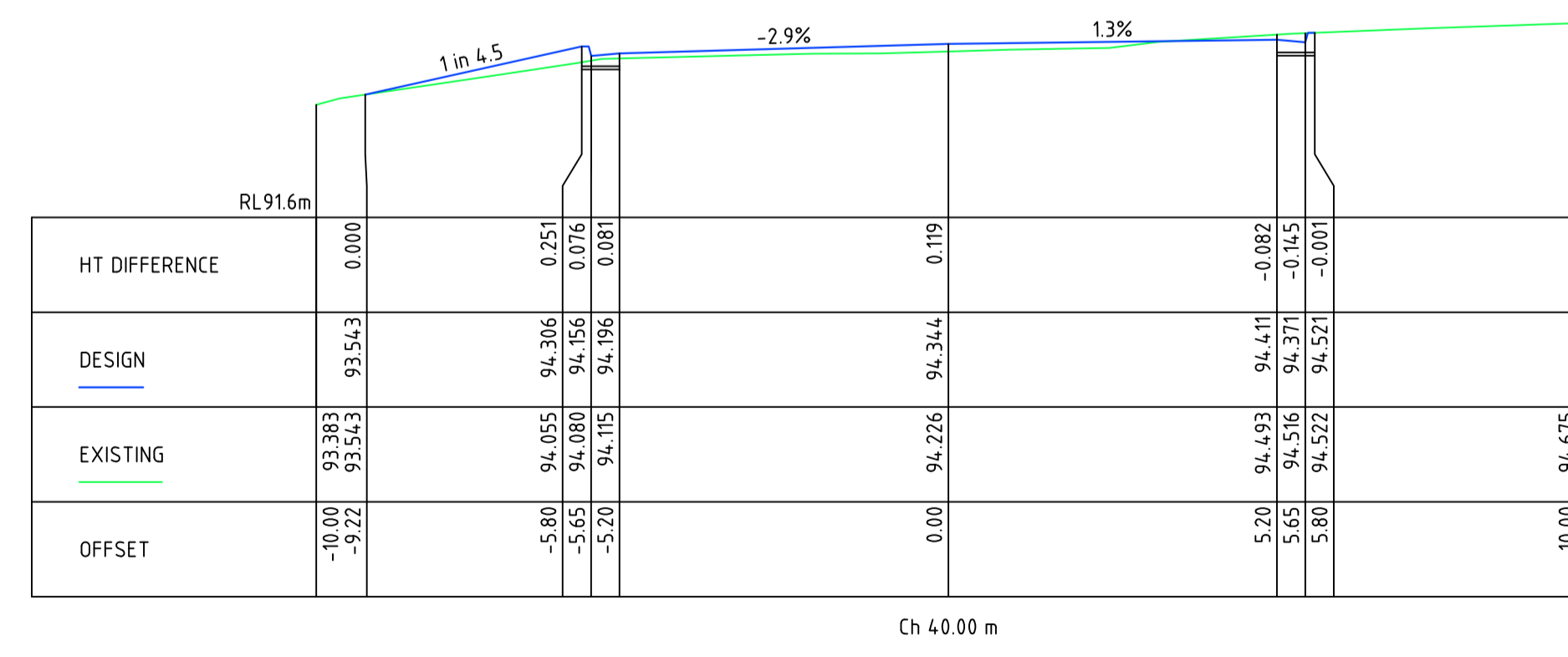
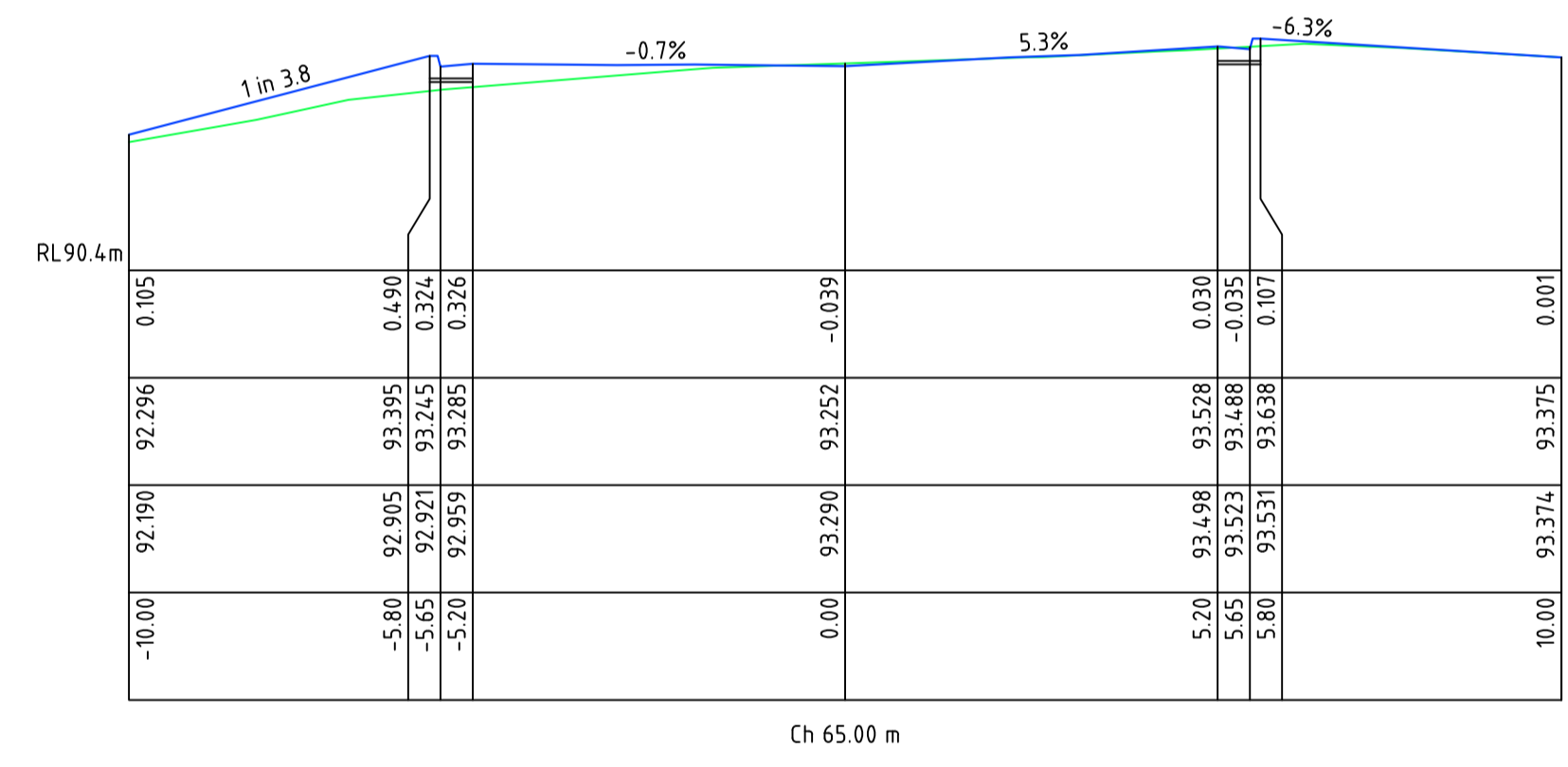
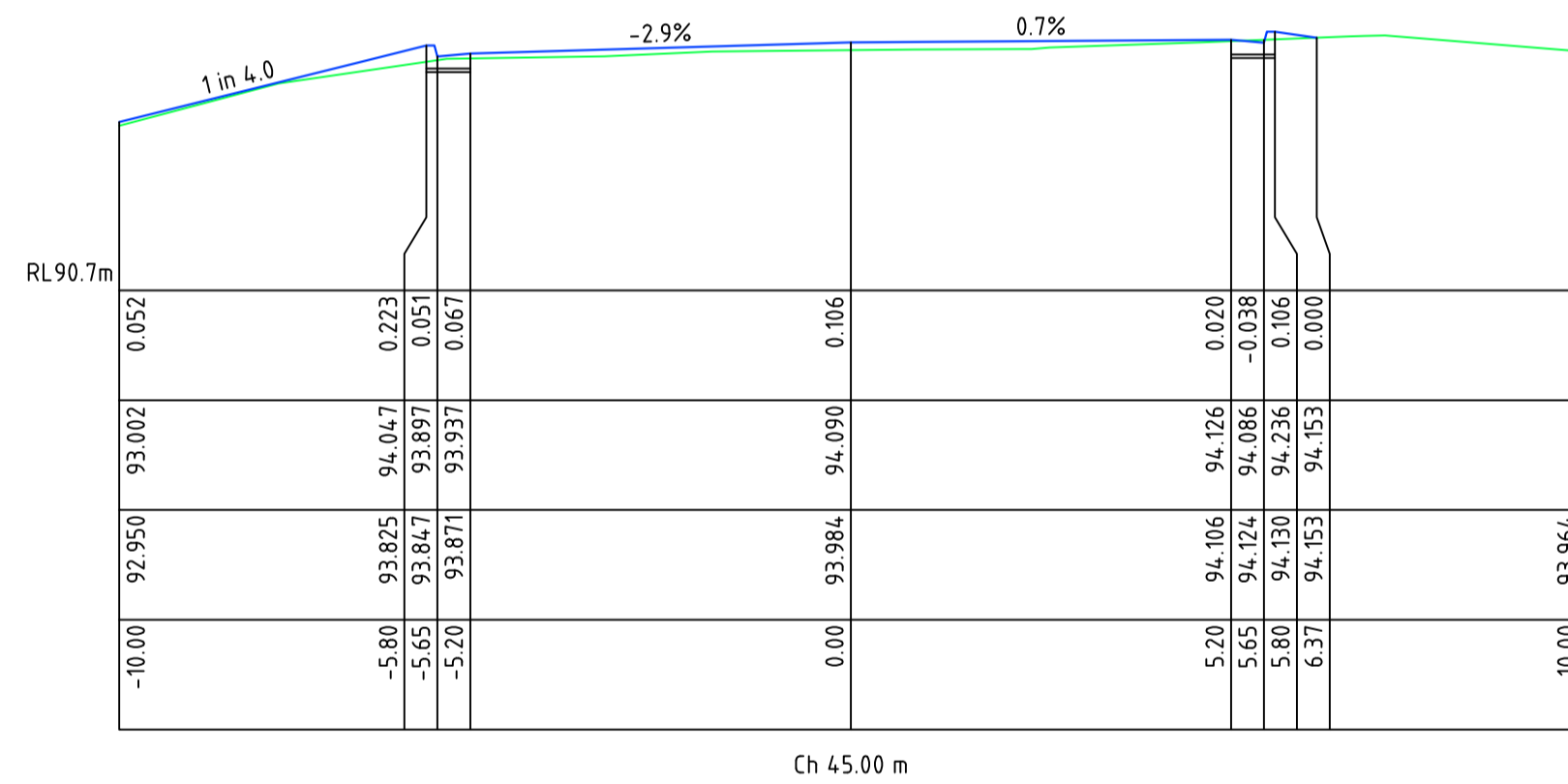
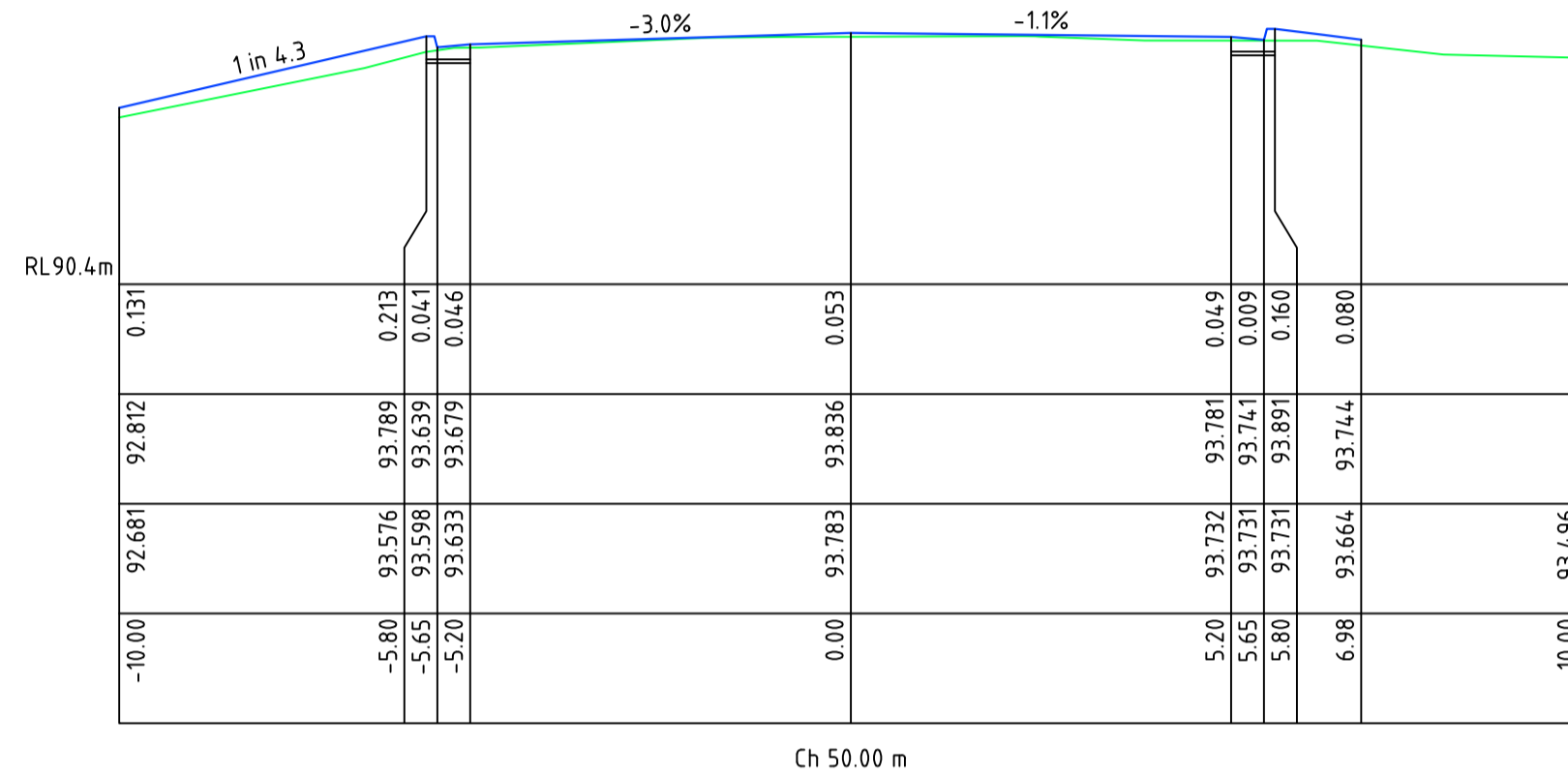
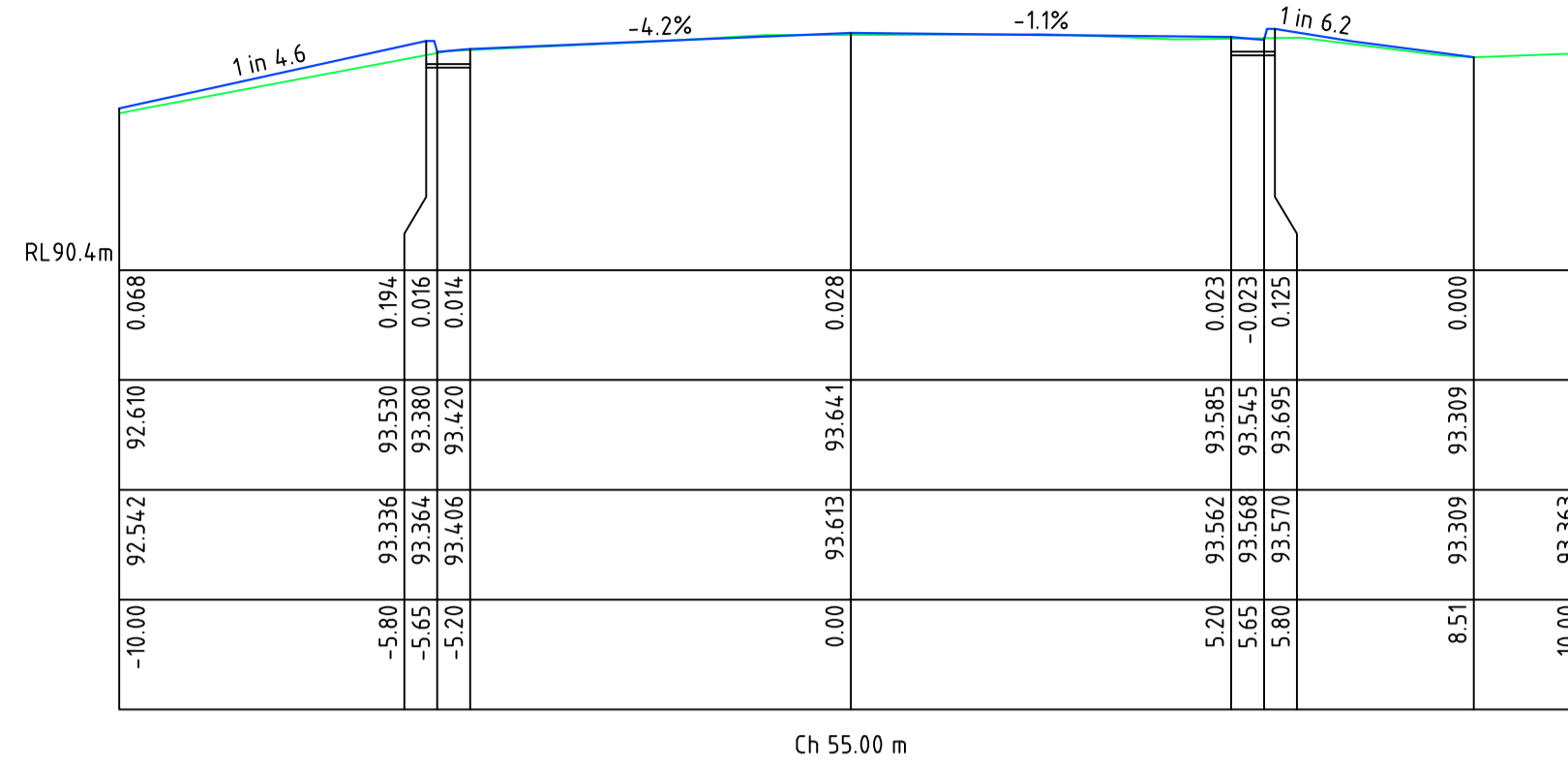

WARNING
BEWARE UNDERGROUND SERVICES
THE LOCATION OF EXISTING SERVICES SHOWN ON THESE PLANS ARE APPROXIMATE ONLY AND THE EXACT POSITIONS SHALL BE PROVEN ON SITE. THE APPROPRIATE AUTHORITIES SHALL BE CONTACTED AND THE SERVICES LOCATED PRIOR TO COMMENCEMENT OF ANY WORKS. NO GUARANTEE IS GIVEN THAT ALL EXISTING SERVICES ARE SHOWN.

DISCLAIMER
THE USE OF THIS DRAWING MAY ONLY BE USED FOR THE PURPOSE SPECIFIED BY THE STATUS STAMP SHOWN BELOW. DUTY OF CARE MUST BE CARRIED OUT BY THE RELEVANT PERSONS TO REVIEW ALL ACCOMPANYING INFORMATION SUCH AS CONTRACTS, SPECIFICATIONS, REPORTS AND DRAWINGS.

STATUS:
ISSUE FOR CONSTRUCTION

BY	JW	DATE	JAN 2024
DESIGNED	JW	DATE	JAN 2024
CHECKED	KW	DATE	13/02/2024
APPROVED			



CIVIL DESIGN PTY LTD
MOBILE: 04 33 322 258
EMAIL: kanchana.withana@civildesign.com.au

CARPARK CENTRELINE - CROSS SECTIONS
SCALE H 1:100
V 1:100

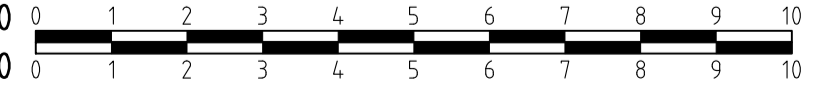

REV	DATE	BY	DESCRIPTION
2	13/02/2024	Jw	ISSUE FOR CONSTRUCTION
1	24/01/2024	Jw	AMENDMENTS AS PER COUNCIL COMMENTS

PROPOSED CARPARK
154 HEATHMONT ROAD, HEATHMONT
MAROONDAH CITY COUNCIL
CROSS SECTION PLAN
23055E 00 C6
SHEET 06 OF 09
SHEET SIZE: A1

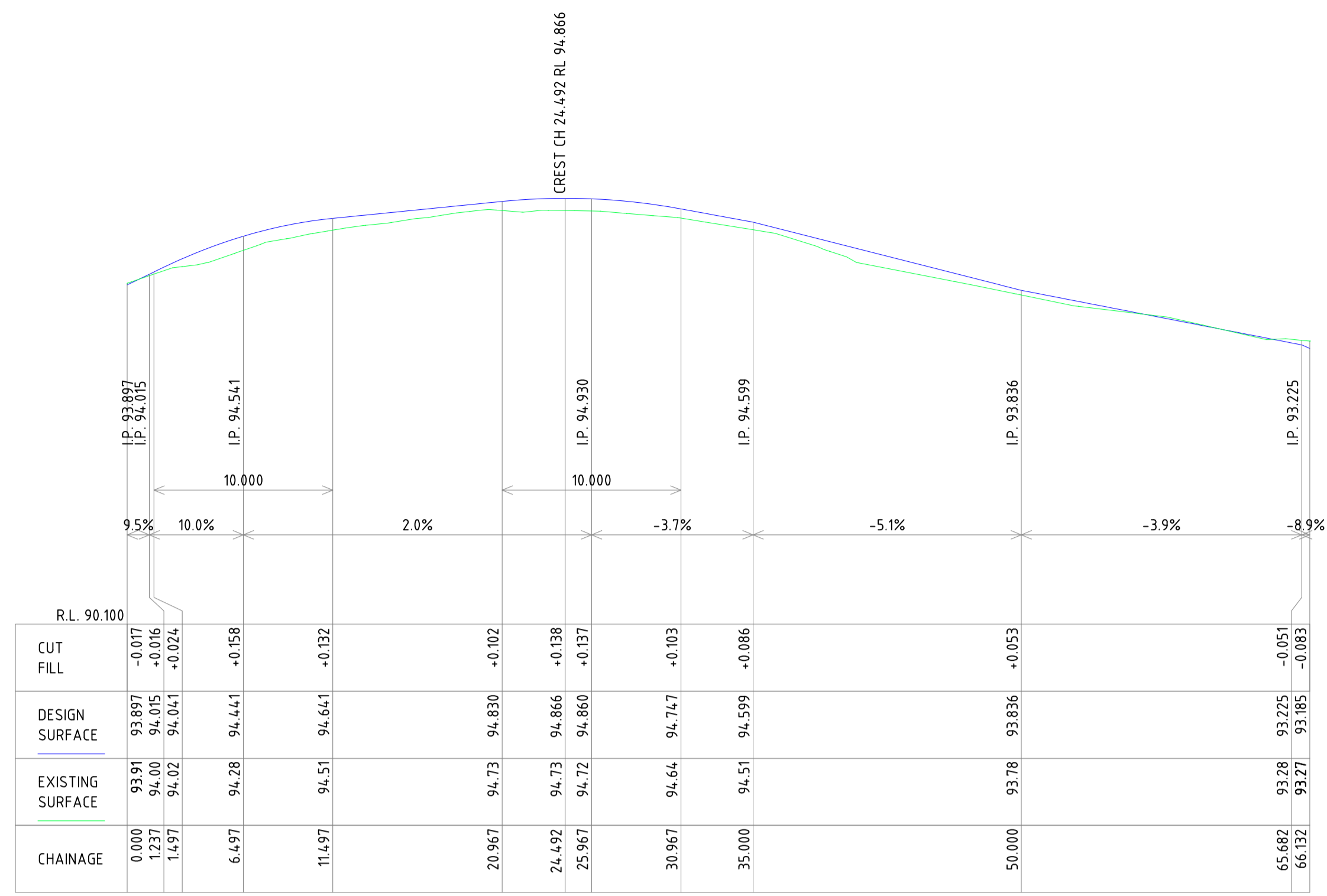

CARPARK CENTRELINE - LONGITUDINAL SECTION
SCALE H 1:250 V 1:50

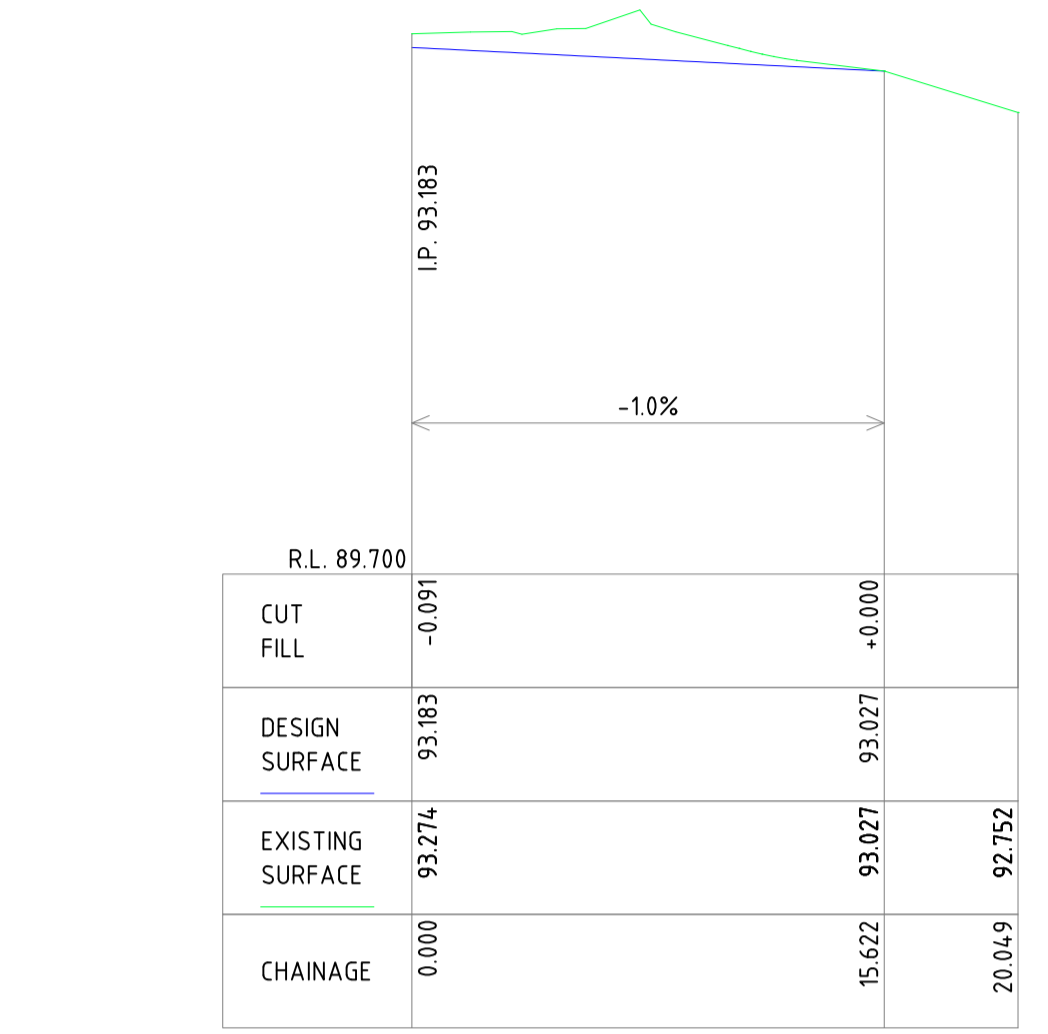

WEST OPEN DRAIN INVERT - LONGITUDINAL SECTION
SCALE H 1:250 V 1:50

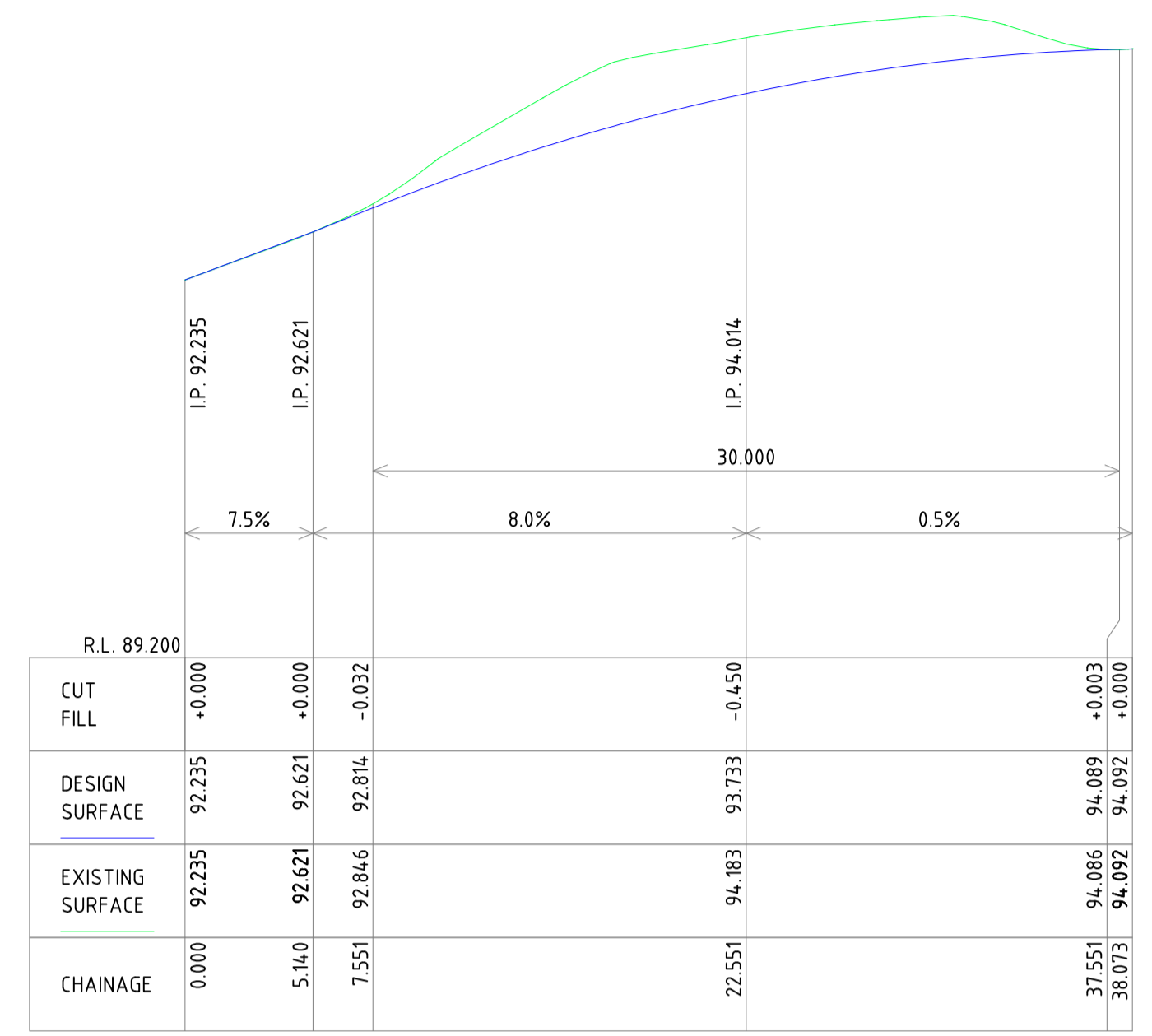

EAST OPEN DRAIN INVERT - LONGITUDINAL SECTION
SCALE H 1:250 V 1:50

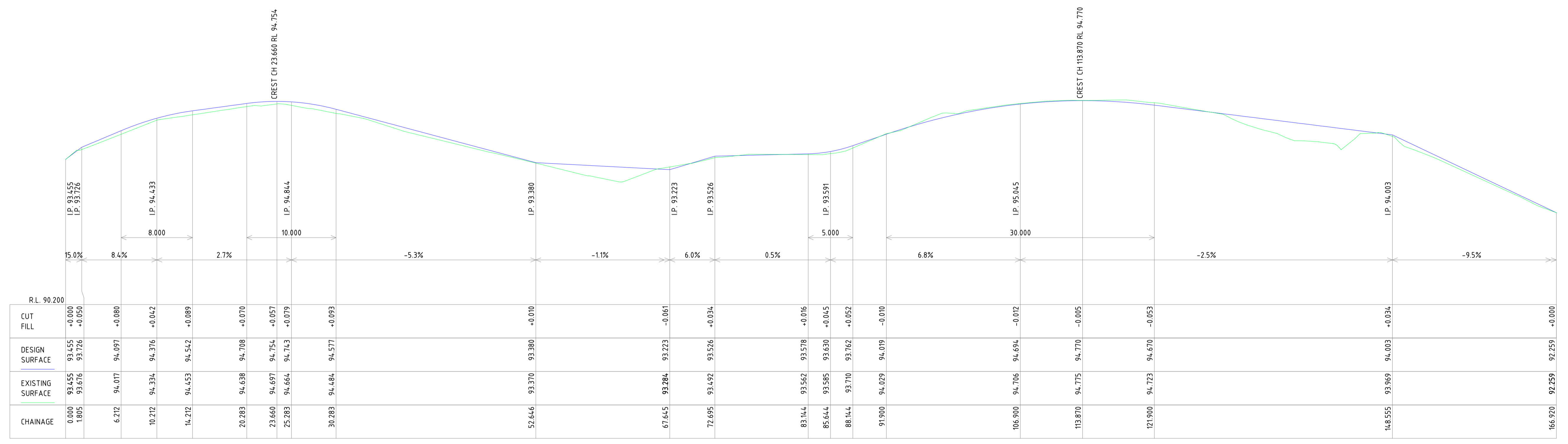

CARPARK LIP - LONGITUDINAL SECTION
SCALE H 1:250 V 1:50



WARNING
BEWARE UNDERGROUND SERVICES
THE LOCATION OF EXISTING SERVICES SHOWN ON THESE PLANS ARE APPROXIMATE ONLY AND THE EXACT POSITIONS SHALL BE PROVEN ON SITE. THE APPROPRIATE AUTHORITIES SHALL BE CONTACTED AND THE SERVICES LOCATED PRIOR TO COMMENCEMENT OF ANY WORKS. NO GUARANTEE IS GIVEN THAT ALL EXISTING SERVICES ARE SHOWN.

DISCLAIMER
THE USE OF THIS DRAWING MAY ONLY BE USED FOR THE PURPOSE SPECIFIED BY THE STATUS STAMP SHOWN BELOW. DUTY OF CARE MUST BE CARRIED OUT BY THE RELEVANT PERSONS TO REVIEW ALL ACCOMPANYING INFORMATION SUCH AS CONTRACTS, SPECIFICATIONS, REPORTS AND DRAWINGS.

STATUS:
ISSUE FOR CONSTRUCTION

BY	DATE
DRAFTED JW	JAN 2024
DESIGNED JW	JAN 2024
CHECKED KW	13/02/2024
APPROVED	



REV	DATE	BY	DESCRIPTION
2	13/02/2024	Jw	ISSUE FOR CONSTRUCTION
1	24/01/2024	Jw	AMENDMENTS AS PER COUNCIL COMMENTS

PROPOSED CARPARK
154 HEATHMONT ROAD, HEATHMONT
MAROONDAH CITY COUNCIL
LONG SECTION PLAN
23055E 00 C7
SHEET 07 OF 09
SHEET SIZE: A1

CARPARK LIP - SETOUT DETAILS				
CHAINAGE	EASTING	NORTHING	DESIGN LEVEL	EXISTING LEVEL
0.00	1155.192	650.866	93.455	93.455
3.66	1154.452	654.370	93.882	93.816
5.00	1153.725	655.493	93.995	93.922
6.65	1152.831	656.875	94.132	94.052
10.00	1150.787	659.529	94.364	94.317
15.00	1147.005	662.781	94.563	94.477
20.00	1142.549	665.020	94.700	94.630
25.00	1137.683	666.115	94.746	94.675
29.98	1132.720	666.002	94.593	94.495
35.00	1127.761	665.196	94.324	94.270
40.00	1122.856	664.231	94.057	93.979
45.00	1117.985	663.103	93.789	93.735
50.00	1113.154	661.813	93.522	93.498
56.86	1106.598	659.783	93.336	93.161
61.91	1101.814	658.182	93.283	92.951
62.69	1101.181	658.497	93.275	92.971
65.00	1100.449	660.683	93.251	93.148
67.65	1099.609	663.191	93.223	93.284
70.00	1098.861	665.424	93.364	93.363
72.10	1098.196	667.410	93.490	93.462
72.88	1098.511	668.043	93.527	93.496
75.00	1100.522	668.716	93.537	93.535
77.93	1103.296	669.645	93.552	93.567
80.00	1105.267	670.291	93.562	93.565
85.00	1110.051	671.743	93.609	93.568
90.00	1114.879	673.045	93.889	93.869
95.00	1119.744	674.197	94.216	94.229
100.00	1124.643	675.197	94.470	94.482
105.00	1129.570	676.045	94.647	94.664
106.67	1131.224	676.294	94.689	94.701
110.00	1134.536	676.594	94.747	94.760
115.00	1139.526	676.372	94.768	94.775
120.00	1144.414	675.347	94.711	94.760
125.00	1149.073	673.547	94.592	94.622
130.00	1153.381	671.019	94.467	94.422
135.00	1157.224	667.829	94.342	94.064
141.87	1161.562	662.525	94.170	93.808
142.00	1161.636	662.412	94.167	93.804
142.78	1161.493	661.724	94.148	93.678
146.37	1158.503	659.734	94.058	94.042
147.56	1158.077	658.701	94.028	94.036
150.95	1158.757	655.381	93.776	93.670
151.32	1158.900	655.034	93.740	93.642
160.00	1163.656	647.779	92.916	92.872
162.26	1164.897	645.887	92.701	92.665
166.12	1167.492	643.051	92.334	92.317
166.92	1168.117	642.557	92.259	92.259

CARPARK CENTRLINE - SETOUT DETAILS				
CHAINAGE	EASTING	NORTHING	DESIGN LEVEL	EXISTING LEVEL
0.00	1158.857	657.134	93.897	93.914
3.06	1157.197	659.700	94.187	94.100
5.00	1156.080	661.290	94.342	94.180
10.00	1152.686	664.951	94.602	94.458
15.00	1148.648	667.885	94.711	94.602
20.00	1144.117	669.981	94.811	94.736
25.00	1139.266	671.160	94.865	94.727
30.00	1134.279	671.377	94.780	94.663
32.32	1131.972	671.148	94.697	94.600
35.00	1129.322	670.739	94.599	94.513
40.00	1124.401	669.856	94.344	94.226
45.00	1119.511	668.815	94.090	93.984
50.00	1114.657	667.617	93.836	93.783
55.00	1109.843	666.264	93.641	93.613
60.00	1105.076	664.757	93.446	93.454
60.14	1104.947	664.714	93.441	93.448
65.00	1100.335	663.170	93.252	93.290
66.13	1099.262	662.811	93.185	93.268

PATH 2 FOP - SETOUT DETAILS				
CHAINAGE	EASTING	NORTHING	DESIGN LEVEL	EXISTING LEVEL
0.00	1088.201	649.350	92.085	92.085
0.20	1088.173	649.545	92.098	92.120
5.52	1089.689	654.465	92.448	92.649
9.18	1092.167	657.166	92.818	92.899
15.25	1097.200	660.433	93.339	93.034
16.46	1098.347	660.817	93.351	93.101

PATH 2 BOP - SETOUT DETAILS				
CHAINAGE	EASTING	NORTHING	DESIGN LEVEL	EXISTING LEVEL
0.00	1090.180	649.638	92.114	92.114
0.20	1090.152	649.833	92.134	92.140
3.74	1091.163	653.113	92.496	92.451
7.41	1093.641	655.814	92.870	92.758
12.46	1097.835	658.537	93.359	92.918
13.67	1098.982	658.921	93.371	92.948

PATH 1 FOP - SETOUT DETAILS				
CHAINAGE	EASTING	NORTHING	DESIGN LEVEL	EXISTING LEVEL
0.00	1134.014	678.521	94.851	94.782
0.39	1133.977	678.907	94.852	94.786
3.55	1132.936	681.859	94.861	94.818
5.05	1132.109	683.115	94.865	94.826
8.09	1130.639	685.765	94.873	94.836
10.00	1129.840	687.504	94.879	94.851
15.00	1127.753	692.048	94.893	94.875
20.00	1125.666	696.592	94.907	94.900
21.54	1125.024	697.990	94.911	94.908
24.79	1123.834	701.017	94.920	94.919
25.33	1123.665	701.531	94.921	94.975

WEST OPEN DRAIN INVERT - SETOUT DETAILS				
CHAINAGE	EASTING	NORTHING	DESIGN LEVEL	EXISTING LEVEL
0.00	1099.040	663.000	93.183	93.274
5.00	1094.316	664.638	93.133	93.307
10.44	1089.173	666.422	93.078	93.197
12.72	1087.078	665.920	93.056	93.098
15.00	1085.495	664.277	93.033	93.042
20.05	1081.035	661.991	93.027	92.752

PATH 1 BOP - SETOUT DETAILS				
CHAINAGE	EASTING	NORTHING	DESIGN LEVEL	EXISTING LEVEL
0.00	1131.039	678.235	94.801	94.738
0.03	1131.036	678.266	94.801	94.739
3.94	1130.087	682.042	94.830	94.798
5.00	1129.677	683.021	94.837	94.805
10.00	1127.608	687.572	94.873	94.839
15.00	1125.521	692.116	94.910	94.879
20.55	1123.206	697.155	94.950	94.937
24.02	1121.935	700.391	94.975	94.974
24.57	1121.765	700.905	94.979	94.979

EAST OPEN DRAIN INVERT - SETOUT DETAILS				
CHAINAGE	EASTING	NORTHING	DESIGN LEVEL	EXISTING LEVEL
0.00	1170.788	644.419	92.235	92.235
5.00	1168.598	648.913	92.611	92.610
6.31	1167.978	650.062	92.715	92.722
10.05	1166.832	653.608	93.007	93.190
14.38	1166.292	657.900	93.302	93.699
18.87	1164.766	662.085	93.560	94.057
20.98	1163.619	663.856	93.663	94.126
25.00	1161.238	667.090	93.829	94.258
30.00	1157.760	670.676	93.980	94.353
34.62	1154.102	673.493	94.064	94.178
37.89	1151.722	675.712	94.091	94.089
38.07	1151.610	675.857	94.092	94.092



WARNING
BEWARE UNDERGROUND SERVICES
 THE LOCATION OF EXISTING SERVICES SHOWN ON THESE PLANS ARE APPROXIMATE ONLY AND THE EXACT POSITIONS SHALL BE PROVEN ON SITE. THE APPROPRIATE AUTHORITIES SHALL BE CONTACTED AND THE SERVICES LOCATED PRIOR TO COMMENCEMENT OF ANY WORKS. NO GUARANTEE IS GIVEN THAT ALL EXISTING SERVICES ARE SHOWN.

DISCLAIMER		BY	DATE
THE USE OF THIS DRAWING MAY ONLY BE USED FOR THE PURPOSE SPECIFIED BY THE STATUS STAMP SHOWN BELOW. DUTY OF CARE MUST BE CARRIED OUT BY THE RELEVANT PERSONS TO REVIEW ALL ACCOMPANYING INFORMATION SUCH AS CONTRACTS, SPECIFICATIONS, REPORTS AND DRAWINGS.		DRAFTED	JW JAN 2024
		DESIGNED	JW JAN 2024
		CHECKED	KW 13/02/2024
		APPROVED	



STATUS:
ISSUE FOR CONSTRUCTION
 CIVIL DESIGN PTY LTD
 MOBILE: 0433 322 258
 EMAIL: kanchana.wifhana@civildesign.com.au

REV	DATE	BY	DESCRIPTION
2	13/02/2024	Jw	ISSUE FOR CONSTRUCTION
1	24/01/2024	Jw	AMENDMENTS AS PER COUNCIL COMMENTS

PROPOSED CARPARK
 154 HEATHMONT ROAD, HEATHMONT
 MAROONDAH CITY COUNCIL
SETOUT DETAILS
 23055E 00 C8
 SHEET 08 OF 09
 SHEET SIZE: A1

